

ROAD MAP

HYBRID MAP

TERRAIN MAP

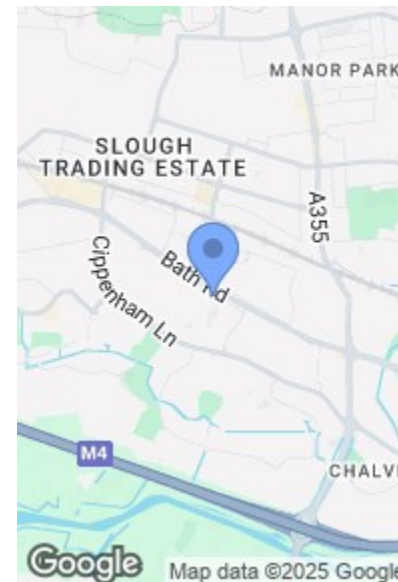
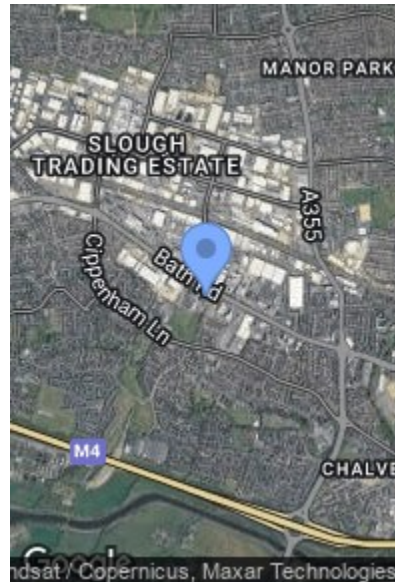
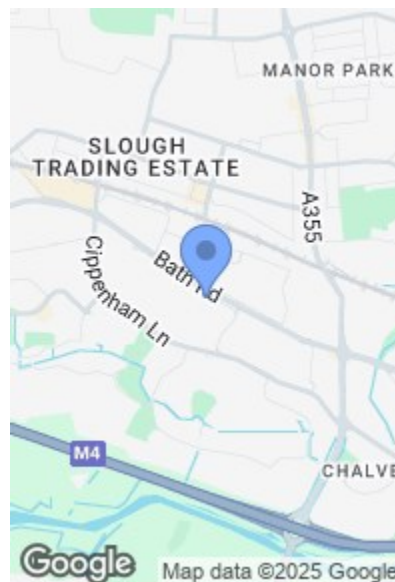

ATRIA HOUSE, 219 BATH ROAD, SLOUGH SL1
£210,000

Camberley 01276 539111
Email: enquiries@knightspropertyservices.com
54 Obelisk Way, Camberley, Surrey GU15 3SG
www.knightspropertyservices.com



Energy Efficiency Rating		
	Current	Potential
Very energy efficient - lower running costs		
(92 plus) A		
(81-91) B		
(69-80) C		
(55-68) D	63	63
(39-54) E		
(21-38) F		
(1-20) G		
Not energy efficient - higher running costs		
England & Wales	EU Directive 2002/91/EC	

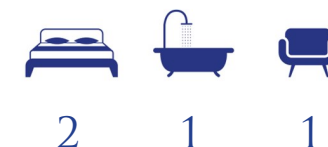



MAIN FEATURES

- No Onward Chain
- Well Presented Apartment
- Video Entry System
- Share Of Freehold
- Lift Access
- Modern Bathroom & Kitchen
- Close To Slough Trading Estate
- Allocated Parking

FULL DETAILS

Kitchen/Reception Room

27'6 x 8'1 (8.38m x 2.46m)

Open plan and laminate flooring. Kitchen is fitted with a range of base and eye level units, sink, oven, two ring electric hob, extractor fan and fridge/freezer.

Bedroom One

12'1 x 7'0 (3.68m x 2.13m)

Carpet flooring.

Bedroom Two/Study

7'0 x 7'0 (2.13m x 2.13m)

Carpet flooring.

Bathroom

Bath with shower, low level WC, wash hand basin, heated towel rail and tiled flooring.

Council Tax

Band B.

Parking

One allocated parking space.

FLOORPLAN



Bath Road, Slough, SL1

Approximate Area = 430 sq ft / 39.9 sq m

For identification only - Not to scale

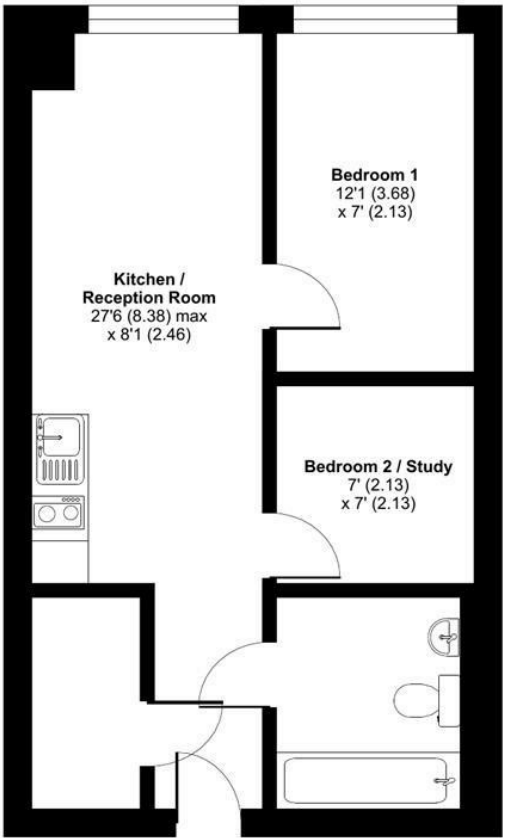

SECOND FLOOR



Floor plan produced in accordance with RICS Property Measurement Standards incorporating International Property Measurement Standards (IPMS2 Residential). © nōcheom 2024. Produced for Knights Property Services. REF: 1178314



ATRIA HOUSE, 219 BATH ROAD, SLOUGH SL1

KNIGHTS PROPERTY SERVICES **NO ONWARD CHAIN**SHARE OF FREEHOLD** New to the market for sale is this well presented apartment, situated in the heart of Slough, located on Bath Road. The property benefits from an open plan kitchen/reception room, double bedroom, bedroom/study, bathroom and allocated parking. The property is close to Slough train station and town centre, with its range of amenities.