



Arundel Terrace , Barnes, London, SW13 **Sold STC**

2 Bedrooms | 1 Reception | 1 Bathroom | Leasehold + Share of freehold

£500,000

- Two Double Bedrooms
- First Floor
- Private secure parking space
- Communal Garden
- Walking distance to Tube
- Close to Thames Path and River
- Quiet tree lined street
- Chain Free

Lovely two bedroom apartment . Set on the first floor, the property benefits from a lot of natural light and is neutrally decorated throughout.

Two double bedrooms, large reception room, fully fitted kitchen and a spacious bathroom.

Private gated parking.

Well maintained quiet communal gardens.

Brand New Boiler and Heating System which is very efficient and energy saving.

The transport links are second to none in and out of London, with the District/Piccadilly/Hammersmith and City/ Metropolitan underground lines all a short walk away.

It feels like being in the countryside even though you are only 15 minutes walk from Hammersmith tube (District/Piccadilly/Circle/Hammersmith and City) and a short bus ride to Barnes Village and Barnes Common.

The property is close by car to the A4/M4 for easy access to central London and Heathrow airport. There are fantastic schools within a short walk including Colet Court, St Pauls, St Paul's Girls School, Bute House, The Swedish School and Harrodian. Latymer Upper, Godolphin and Latymer and The West London Free School are just over the bridge in Hammersmith.

The lovely Barnes Village is within close proximity with its array of restaurants, pubs, Olympic Cinema/Cafe, cafes and independent shops.

Service Charge and General Reserve: £1100 Per quarter approx (Includes Hot Water and Heating)

Lease duration: 999 years from 01 December 1993

Ground Rent: A peppercorn

Important Notice

1. No description or information given about the property or its value, whether written or verbal or whether or not in these particulars (Information) may be relied upon as a statement of representation or fact. Neither Willmotts nor its Joint Agents have any authority to make any representation and accordingly any Information given is entirely without responsibility on the part of Willmotts or the seller/lessor.
- 2 Any photographs (and artists impressions) show only certain parts of the property at the time they were taken. Any areas, measurements or distances given are approximate only.
- 3 Any reference to alterations to, or use of any part of the property is not a statement that any necessary planning, building regulations or other consent has been obtained. These matters must be verified by any intending buyer/lessee.
4. Any buyer/lessee must satisfy himself by inspection or otherwise as to the correctness of any Information given.
5. We have not carried out a survey nor tested services, appliances or specific fittings. For fixtures and fittings please refer to vendors fixtures and fittings forms



Arundel Court, Arundel Terrace, London, SW13 8DR

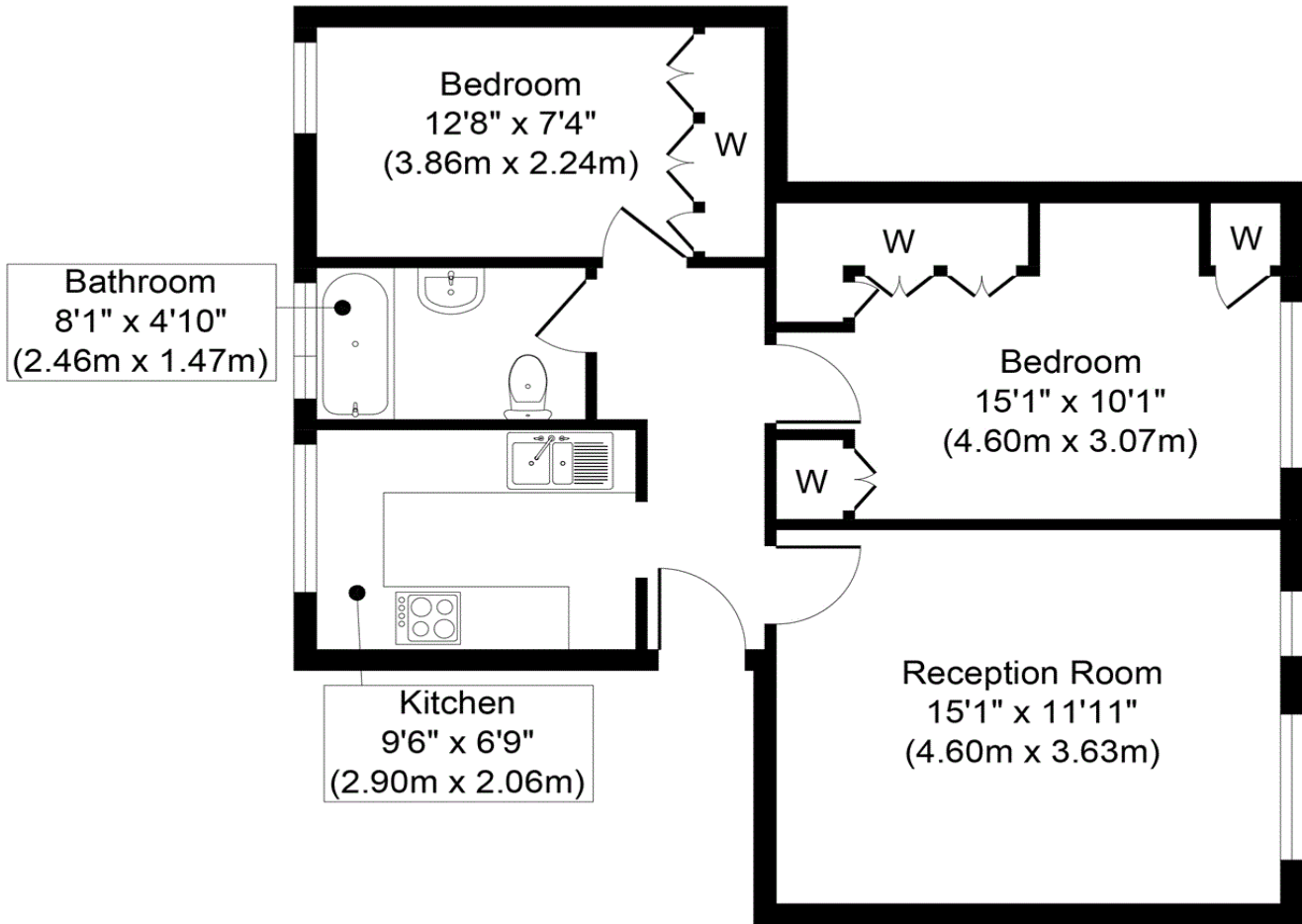

First Floor
Approximate Floor Area
604 sq. ft
(56.11 sq. m)

Approx. Gross Internal Floor Area 604 sq. ft / 56.11 sq. m

Measured in accordance with RICS guidelines. Every attempt has been made to ensure the accuracy, however, all measurements of doors are approximate. This plan is for illustrative purposes only and is not to scale.

Map



EPC

 image

Important Notice

1. No description or information given about the property or its value, whether written or verbal or whether or not in these particulars ("Information") may be relied upon as a statement of representation or fact. Neither Willmotts nor its Joint Agents have any authority to make any representation and accordingly any Information given is entirely without responsibility on the part of Willmotts or the seller/lessor.
2. Any photographs (and artist's impressions) show only certain parts of the property at the time they were taken. Any areas, measurements or distances given are approximate only.
3. Any reference to alterations to, or use of any part of the property is not a statement that any necessary planning, building regulations or other consent has been obtained. These matters must be verified by any intending buyer/lessee.
4. Any buyer/lessee must satisfy himself by inspection or otherwise as to the correctness of any Information given.

Building Consultancy & Surveying, Commercial Agency, Commercial Management,
Commercial Investment, Professional Valuations, Residential Lettings, Residential Sales,
Residential Management, Service Charge & Estate Management

