



SUSAN METCALFE  
RESIDENTIAL

## **First Floor Flat, 23 Farrier Walk, London SW10 9FW**

A beautiful first floor, lateral, 3-bedroom apartment in Farrier Walk, a private gated residential development just off the Fulham Road. Presented in excellent condition, the interior-designed apartment comes fully furnished and is available for an 8-month rental contract.



### **Accommodation and Amenities**

**3 Bedrooms : Bathroom : En Suite Bathroom : Reception Room/Dining Room :  
Kitchen : Porter : EPC Rating C**

**Furnished**

**£1,200 pw / £5,200 pm Subject To Contract**

10 HOLLYWOOD ROAD  CHELSEA SW10 9HY  
020 7581 3349 [www.susanmetcalfe.com](http://www.susanmetcalfe.com) [info@susanmetcalfe.com](mailto:info@susanmetcalfe.com)



## Fees and Charges

Upfront payments/fees for letting this property, if it is an AST letting, consist only of the rent, tenancy deposit and any agreed holding deposit (if applicable). For a list of administrative payments and fees applicable to all other lettings, please contact us for further information.

### Disclaimer

These particulars have been produced as a general guide for this property only and no other purpose. They are not an offer or contract. You should not rely on statements in these particulars or by word of mouth or in writing as being factually accurate about the property, its condition or its value. Neither any primary agent or joint agent has any authority to make or give any representations or warranties in relation to the property, and accordingly any information given is entirely without responsibility on the part of the agents or lessor(s).

The photographs show only certain parts of the property as they appeared at the time they were taken. Any areas, measurements and distances given are approximate only. Any reference to alterations to, or use of, any part of the property does not mean that any necessary planning, building regulations or other consent has been obtained nor have any services, equipment or facilities been tested. A lessee should satisfy themselves by inspection or otherwise. The VAT position relating to the property may change without notice. Please contact us for further information regarding the approved Client Money Protection (CMP) scheme and the property redress scheme which we are a member of.

# Farrier Walk

Approx. Gross Internal Area 881 Sq Ft - 81.85 Sq M

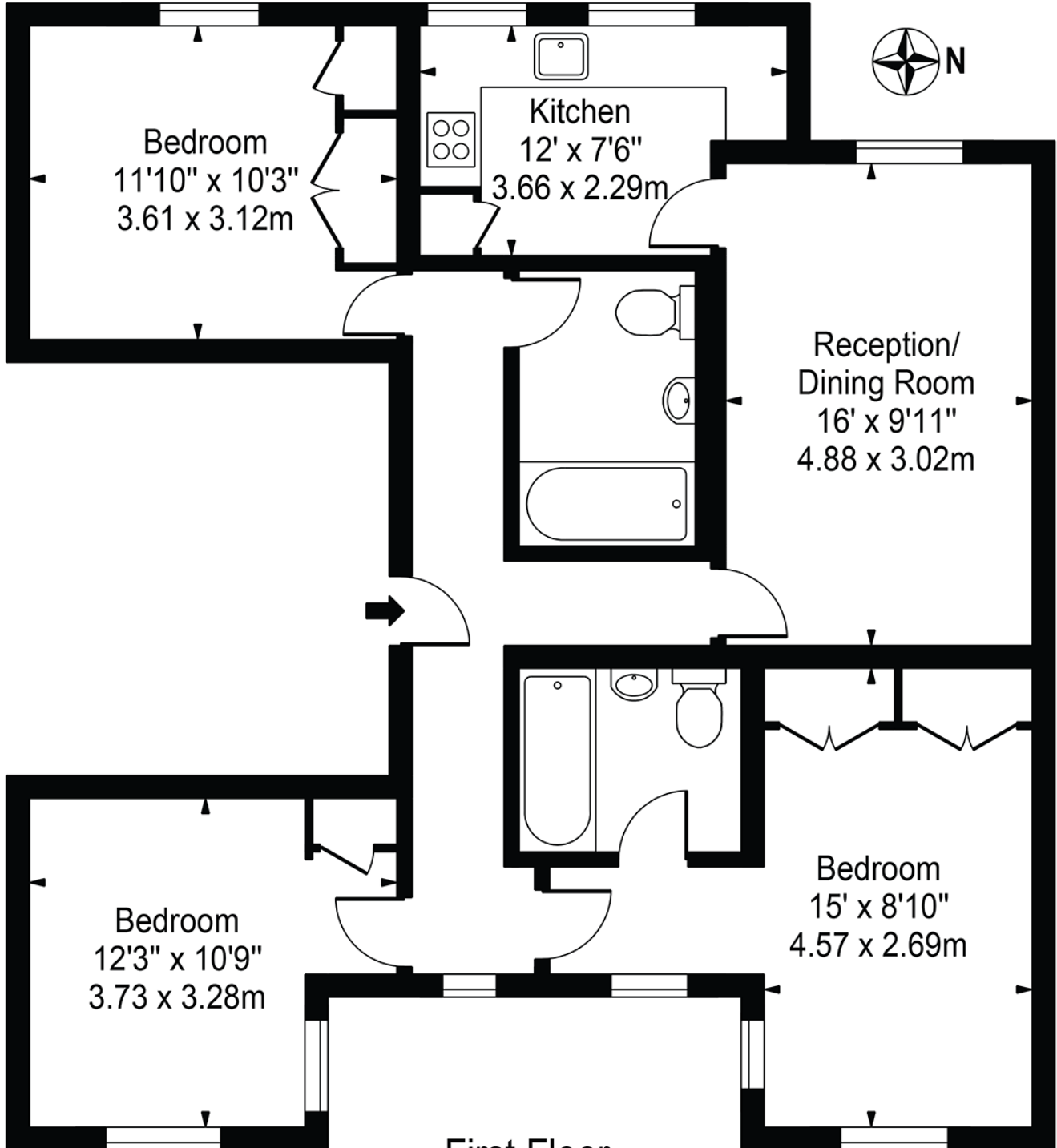

## First Floor

For Illustration Purposes Only - Not To Scale

This floor plan should be used as a general outline for guidance only and does not constitute in whole or in part an offer or contract. Any intending purchaser or lessee should satisfy themselves by inspection, searches, enquiries and full survey as to the correctness of each statement. Any areas, measurements or distances quoted are approximate and should not be used to value a property or be the basis of any sale or let.