



21 Wentworth Avenue, Walton, Chesterfield, S40 3JB

Offers In The Region Of £210,000

- Offers in the region of £210,000
- Offered chain free
- Double driveway to the front
- 3 bedrooms
- Semi detached house
- Off street parking and garage
- Great potential
- Popular location of Walton
- Enclosed rear garden
- Ideal for families or 1st time buyers



21 Wentworth Ave

CREATED ON
2025-08-21

LOCATION
21 Wentworth Ave
S40 3JB Chesterfield
England

DETAILS
Total area: 94.88 m²
Living area: 80.32 m²
Floors: 2
Rooms: 14

Square Box Media
info@squareboxmedia.com
www.squareboxmedia.com

THIS FLOORPLAN IS PROVIDED WITHOUT
WARRANTY OF ANY KIND. SENSORIA
DISCLAIMS ANY WARRANTY INCLUDING,
WITHOUT LIMITATION, SATISFACTORY QUALITY
OR ACCURACY OF DIMENSIONS.

0 1 2 3m
1:107

▼ **Ground Floor** TOTAL AREA: 62.33 m² · LIVING AREA: 47.77 m² · ROOMS: 7



▼ **1st Floor** TOTAL AREA: 32.55 m² · LIVING AREA: 32.55 m² · ROOMS: 7

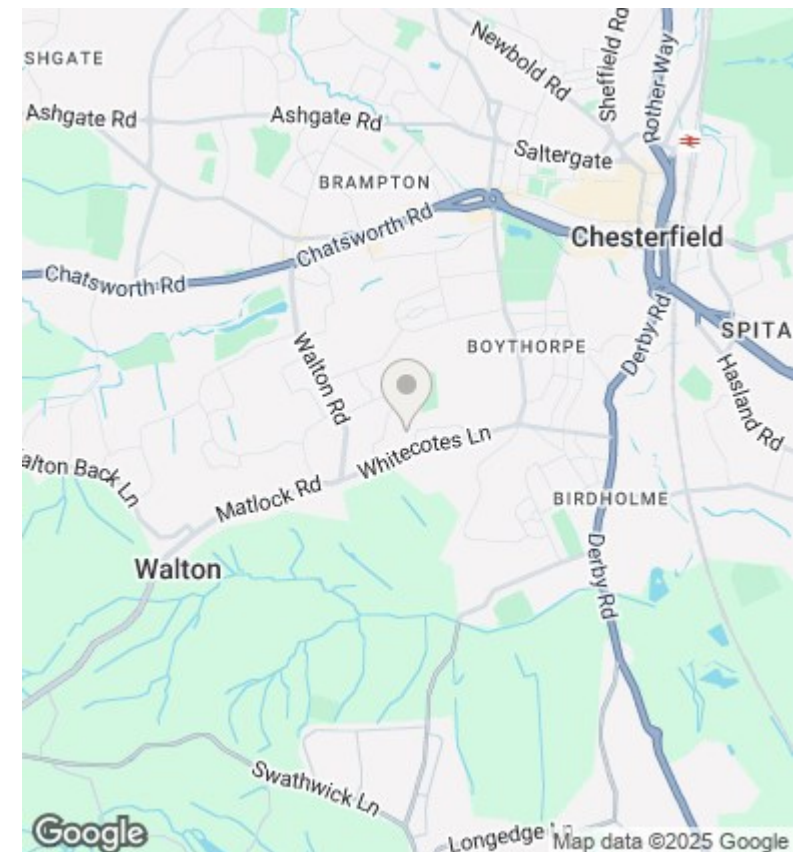
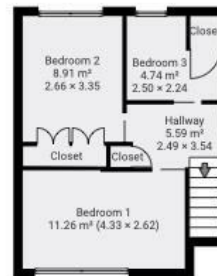

Directions

Viewings

Viewings by arrangement only. Call 01246 276 276 to make an appointment.

Council Tax Band

C

EPC Rating:

C

Energy Efficiency Rating		
	Current	Potential
Very energy efficient - lower running costs		
(92-plus) A		
(81-91) B		
(69-80) C	69	80
(55-68) D		
(39-54) E		
(21-38) F		
(1-20) G		
Not energy efficient - higher running costs		
England & Wales		EU Directive 2002/91/EC