



## Offers Over £210,000 -£210,000

- Beautifully presented family home
- Off street parking
- Guide price £200,000 - £210,000
- Ideal for families or 1st time buyers
- Popular location with good commuter links to Sheffield
- Utility room and storage
- Early viewing is recommended
- Extended living area ideal for families
- Modern kitchen with integrated appliances
- Close to good local schooling



# Osmund Road, Sheffield S21 4ES

 3  1  1  C

Council Tax Band: A

















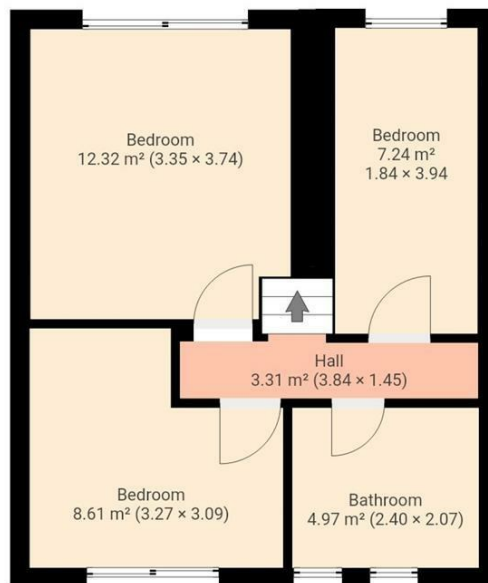
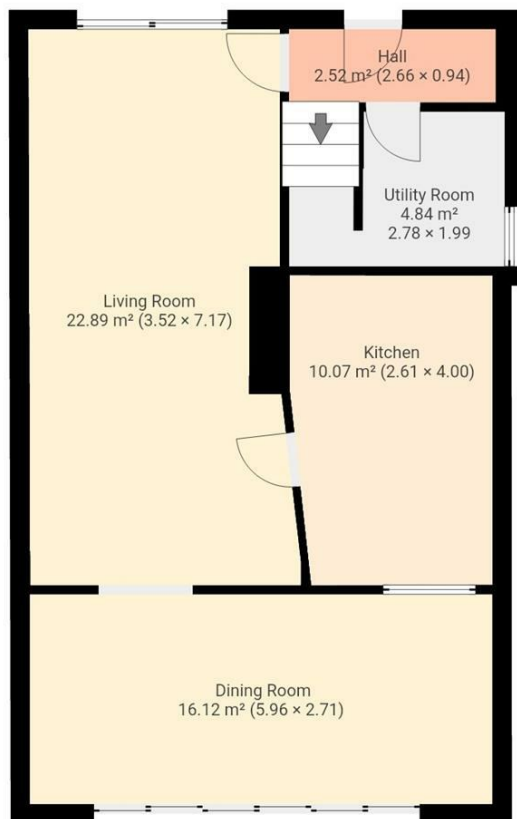

THIS FLOORPLAN IS PROVIDED WITHOUT WARRANTY OF ANY KIND. SENSOPIA DISCLAIMS ANY WARRANTY INCLUDING, WITHOUT LIMITATION, SATISFACTORY QUALITY OR ACCURACY OF DIMENSIONS.

B



## Viewings

Viewings by arrangement only. Call 01246 276 276 to make an appointment.