



## Offers In The Region Of £239,950

- Modern family home in the popular area of Wingerworth
- 3 bedrooms
- Enclosed rear garden with summer house
- New combi boiler fitted 2020
- Good local schooling with Deepark school close to hand
- Quiet location surrounded by trees
- New roof fitted 2018
- Well maintained throughout with modern kitchen and shower room
- Off street parking for multiple vehicles and garage with power
- New windows and doors 2018



# 7 Woodview Close, Chesterfield S42 6XG

 3  1  2  C

Council Tax Band: B







Welcome to this charming semi-detached house located in the desirable Woodview Close, Wingerworth, Chesterfield. This property boasts two spacious reception rooms, perfect for entertaining guests or relaxing with your family. With three bedrooms, there's plenty of space for everyone to enjoy.

The house features a modern kitchen with integrated appliances including an induction hob, microwave, dishwasher and oven. The stylish shower room complete with tiles was fitted in 2018 ensures both comfort and convenience for everyday living. The new combi boiler fitted in 2020, along with the new roof, windows and doors installed in 2018, provide peace of mind and energy efficiency.

On the 1st floor are two bedrooms, the master benefiting from built in wardrobes. The double to the rear has fitted storage and views to the woodland. The single bedroom to the front has a bed and desk currently.

Parking is available for up to three vehicles, and potentially more if required plus a garage with power supply. The Peaceful rear garden backs onto woodland and has a summerhouse, room entertaining and lawn area.

Located near to Smithy pond and the well regarded Deerpark school, this property offers excellent educational opportunities for families. The house has been meticulously maintained throughout, offering a move-in ready experience for its new owners.

The property tenure is freehold and is in council tax band B.









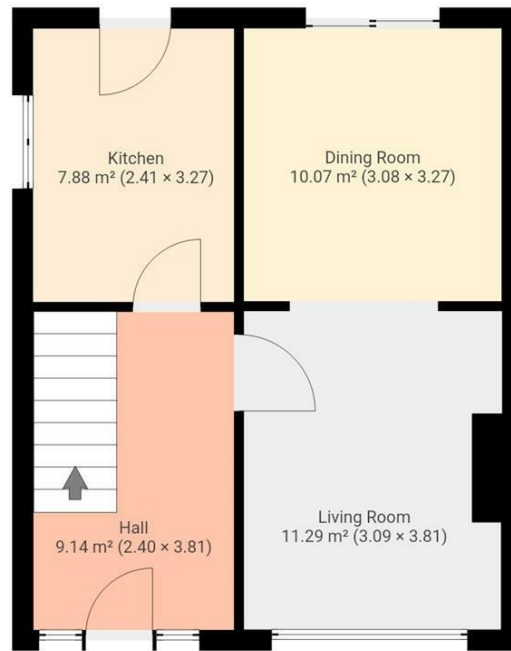
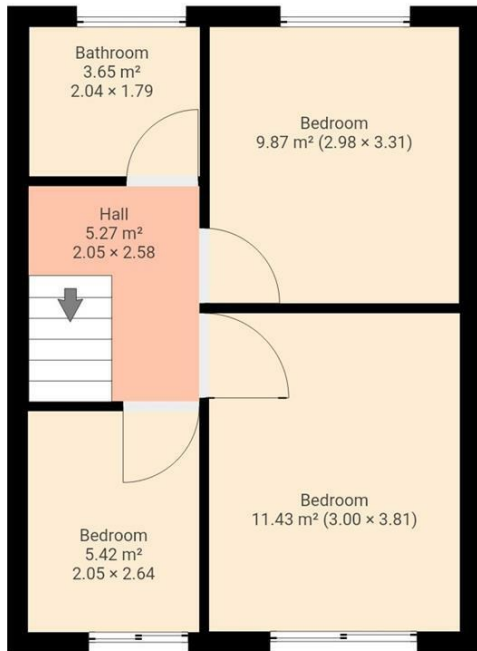

## Viewings

Viewings by arrangement only. Call 01246 276 276 to make an appointment.

THIS FLOORPLAN IS PROVIDED WITHOUT WARRANTY OF ANY KIND. SENSOPIA DISCLAIMS ANY WARRANTY INCLUDING, WITHOUT LIMITATION, SATISFACTORY QUALITY OR ACCURACY OF DIMENSIONS.

B