

ABBNEY ROAD, ST JOHNS WOOD, LONDON NW8 9BW



£692.00 PW

[£2,998.66 PCM]

[FEES APPLY]

2 BEDROOM(S)

AVAILABLE: AVAILABLE NOW

Available for long term rental this modern 2-bedroom apartment (994 sq ft; 92.41 sq m) set on the 7th floor in the iconic development of 20 Abbey Road, superbly located to take advantage of everything St Johns Wood has to offer. EPC: D

- Iconic development
- 7th floor apartment
- Double reception room
- Fully fitted kitchen
- 2 x double bedrooms
- 2 x bathroom/WCs
- Underground parking space
- 24-hour concierge & CCTV
- Heated pool for residents
- Short walk to St Johns Wood tube station

T: 020 7691 9000

E: info@excel-property.co.uk

W: www.excel-property.co.uk

JP: www.excel-property.london/JP

A: 146 Finchley Road, London, NW3 5HS



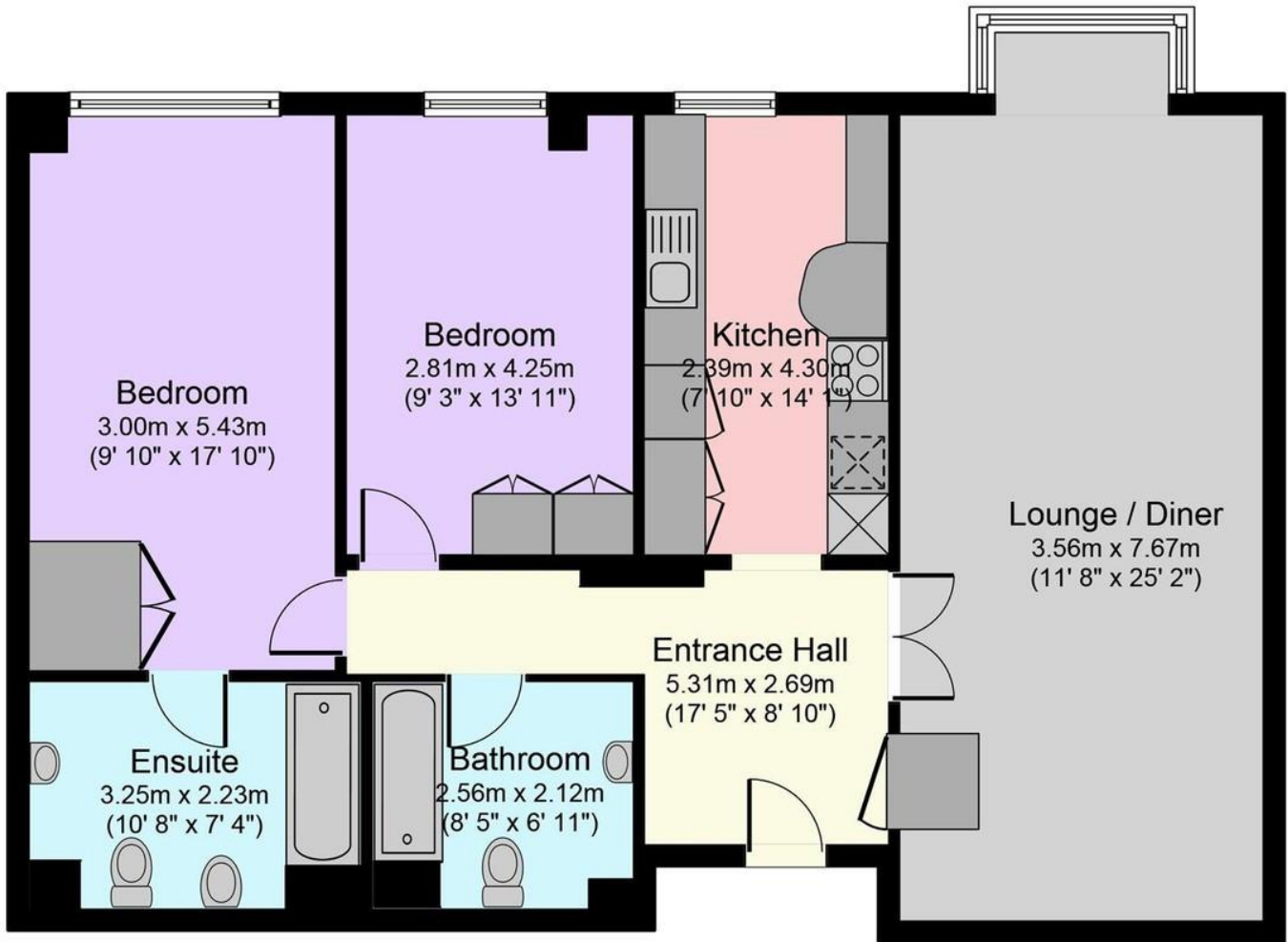

Floor Plan 1

Floor area 94.0 sq. m. (1,012 sq. ft.) approx

NOT TO SCALE For layout guidance only.

T: 020 7691 9000

E: info@excel-property.co.uk

W: www.excel-property.co.uk

JP: www.excel-property.london/JP

A: 146 Finchley Road, London, NW3 5HS