

Brightview Court, Finchley Lane, Hendon, NW4 1DL



£450 pw

[£1,950.00 pcm] [fees apply]

2 bedroom(s)

Available: 26th March 2021

Available for long term rental this contemporary 2 bedroom, 2 bathroom apartment in a new build development with parking in the heart of Hendon, ideally located for the amenities of Hendon high street and the transport links of the underground station. EPC: B

- New build development
- Lower ground floor
- Interior designed
- 2 x private patios
- Spacious reception
- Open plan kitchen
- Master bedroom suite
- Second double bedroom
- Family bathroom/WC
- Secure off street parking

T: 020 7691 9000

E: info@excel-property.co.uk

W: www.excel-property.co.uk

JP: www.excel-property.london/JP

A: 146 Finchley Road, London, NW3 5HS



Brightview Court, Finchley Lane, Hendon, NW4 1DL

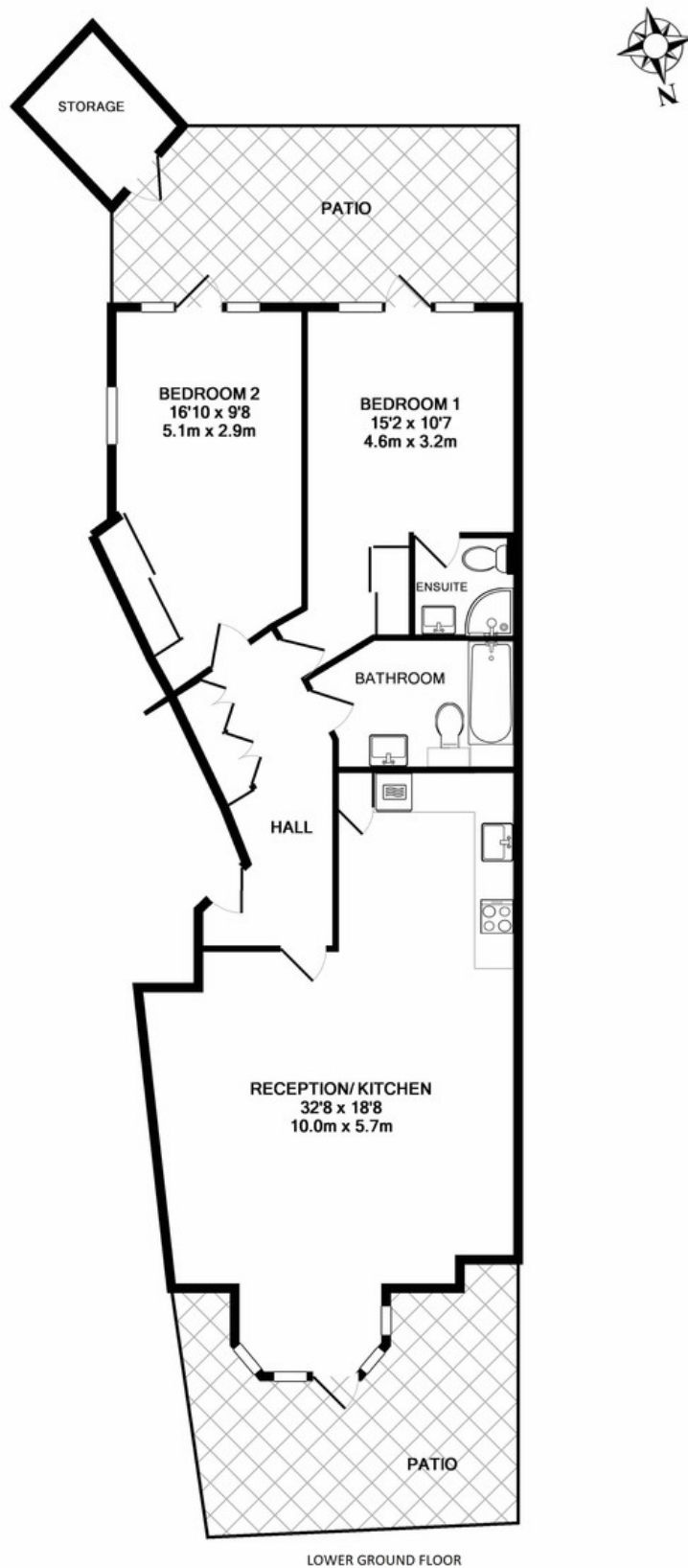

BRIGHTVIEW COURT NW4
TOTAL APPROX. FLOOR AREA 977 SQ.FT. (90.8 SQ.M.)
Measurements are approximate. Not to scale. Illustrative purposes only

T: 020 7691 9000

E: info@excel-property.co.uk

W: www.excel-property.co.uk

JP: www.excel-property.london/JP

A: 146 Finchley Road, London, NW3 5HS

