



TO LET

Moorside, Knutsford

IRLAM
of Knutsford



Knutsford, WA16 6EU

Moorside - £1,100.00 pcm



The Property

This charming period terraced cottage is ideally located right at the heart of Knutsford Town Centre. Conveniently positioned for access to all local amenities, including Knutsford's famous shops, bars and restaurants and enjoying open views over The Moor, the property is ideal for singles or couples looking for that central spot. Particular mention must be made of the newly fitted kitchen, with bright granite-effect surfaces and matching units.

The property benefits from an attractive rear garden laid to lawn and surrounded by mature trees and hedges.

Directions

From Irlams office proceed down Old Market Place and upon reaching The Moor turn right onto Moorside where the property will soon be seen on your right.

- A charming period cottage
- Situated in the heart of Knutsford town centre
- Lovely views over The Moor
- Refitted kitchen
- Two bedrooms
- Bathroom
- Rear garden
- Unfurnished
- Available January

Postcode – WA16 6EU

EPC Rating – D

Local Authority – Cheshire East

Council Tax – Band C



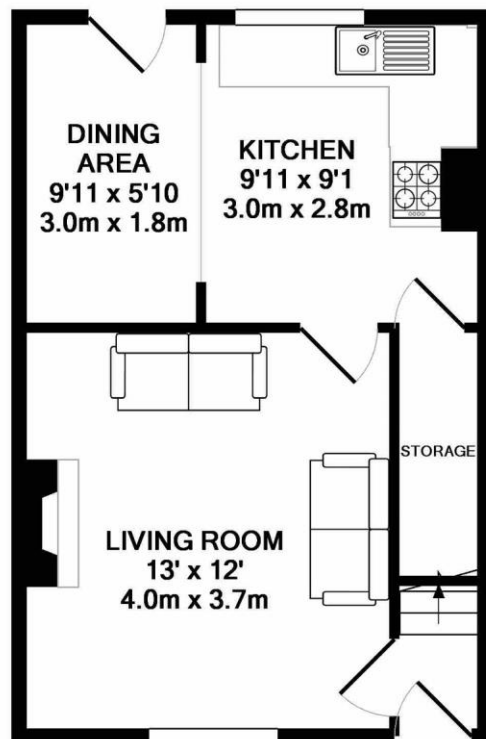

GROUND FLOOR
APPROX. FLOOR
AREA 337 SQ.FT.
(31.3 SQ.M.)

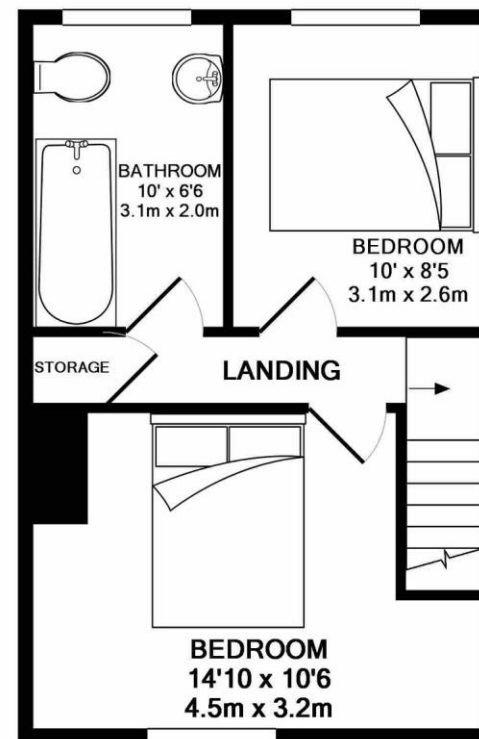

1ST FLOOR
APPROX. FLOOR
AREA 333 SQ.FT.
(31.0 SQ.M.)

TOTAL APPROX. FLOOR AREA 671 SQ.FT. (62.3 SQ.M.)

Whilst every attempt has been made to ensure the accuracy of the floor plan contained here, measurements of doors, windows, rooms and any other items are approximate and no responsibility is taken for any error, omission, or mis-statement. This plan is for illustrative purposes only and should be used as such by any prospective purchaser. The services, systems and appliances shown have not been tested and no guarantee as to their operability or efficiency can be given

Made with Metropix ©2018

103 King Street, Knutsford, Cheshire, WA16 6EQ

01565 654 000

E: info@irlamsestateagents.co.uk

www.irlamsestateagents.co.uk

I1021_ Printed by Ravensworth 01670 713330

Irlams (Estate Agents) Ltd for themselves and for the vendors or lessors of this property whose agents they are give notice that:

- (a) The particulars are set out as a general outline only for the guidance of intending purchasers or lessees, and do not constitute, nor constitute part of, an offer or contract;
- (b) All descriptions, dimensions, references to condition and necessary permissions for use and occupation, and other details are given in good faith and are believed to be correct but any intending purchasers or lessees should not rely on them as statements or representations of fact, but must satisfy themselves by inspection or otherwise as to the correctness of each of them;
- (c) No person in the employment of Irlams (Estate Agents) Ltd has any authority to make or give any representation or warranty whatsoever in relation to this property.

IRLAMs
of Knutsford