



Knutsford
Libris Place, Stanley Road

Knutsford, WA16 0GP

Libris Place, Stanley Road

£245,000



The Property

This beautifully appointed two bedroom ground floor apartment has been lovingly maintained and improved by the current owner to now provide light and spacious living accommodation in a contemporary style.

Particular mention must be made of the spacious and flexible open plan living accommodation with dual aspect and leading door onto a small private terrace, the recently fitted kitchen complete with integrated appliances as well as the master bedroom, complete with en-suite shower room. Located in an ever popular position within the heart of the town, forming a select development of similar properties

whilst being ideally positioned for all major network links to the Northwest and beyond.

Externally the property is approached via a private tarmac driveway and car park leading to the allocated parking. Access to the well-appointed communal hall leading to front door.

Directions

From the roundabout in Canute Square travel along King Edward Road (A50) tuning right at the traffic lights onto Stanley Road. Take the first right into Libris Place where the apartment will be seen.



- An immaculately presented ground floor apartment
- Situated on the doorstep of Knutsford town centre & Tatton Park
- Spacious open plan living accommodation
- Fitted kitchen with integrated appliances
- Two generous bedrooms
- Two bathrooms (one en-suite)
- Allocated parking

Postcode – WA16 0GP

EPC Rating – D

Tenure – Leasehold

(150 Years from May 2002- 127 years remaining
Service Charge £142 pcm)

Local Authority – Cheshire East

Council Tax – Band D



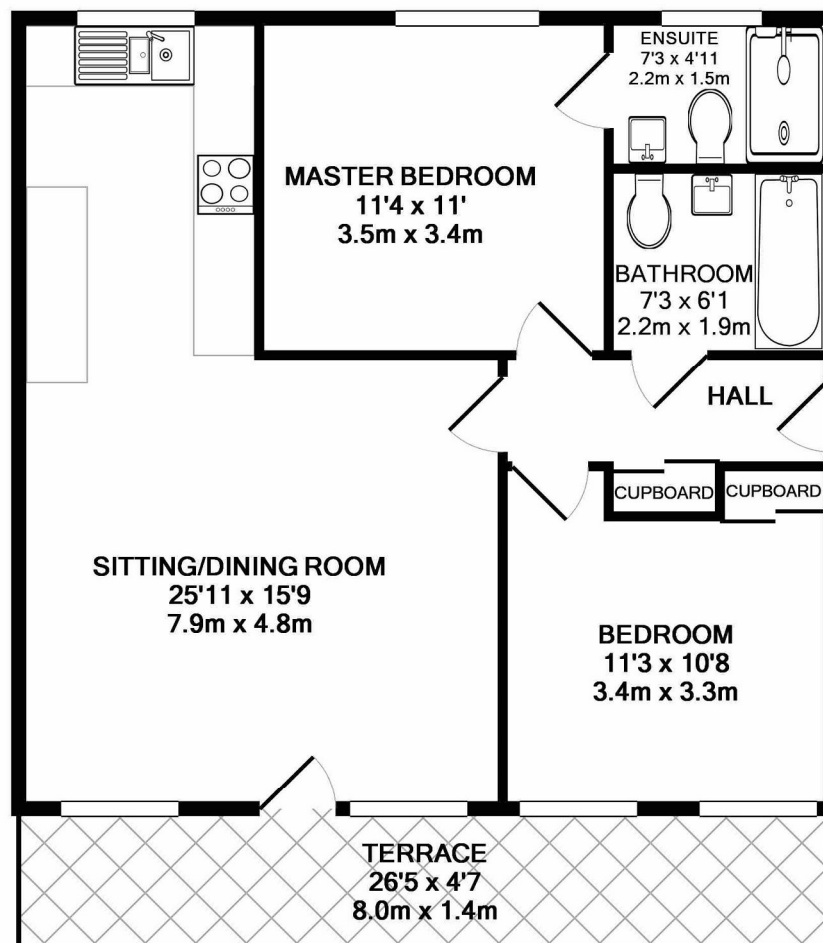

TOTAL APPROX. FLOOR AREA 685 SQ.FT. (63.6 SQ.M.)

Whilst every attempt has been made to ensure the accuracy of the floor plan contained here, measurements of doors, windows, rooms and any other items are approximate and no responsibility is taken for any error, omission, or mis-statement. This plan is for illustrative purposes only and should be used as such by any prospective purchaser. The services, systems and appliances shown have not been tested and no guarantee as to their operability or efficiency can be given
Made with Metropix ©2018

103 King Street, Knutsford, Cheshire, WA16 6EQ

01565 654 000

E: info@irlamsestateagents.co.uk

www.irlamsestateagents.co.uk

I1021_ Printed by Ravensworth 01670 713330

Irlams (Estate Agents) Ltd for themselves and for the vendors or lessors of this property whose agents they are give notice that:

- (a) The particulars are set out as a general outline only for the guidance of intending purchasers or lessees, and do not constitute, nor constitute part of, an offer or contract;
- (b) All descriptions, dimensions, references to condition and necessary permissions for use and occupation, and other details are given in good faith and are believed to be correct but any intending purchasers or lessees should not rely on them as statements or representations of fact, but must satisfy themselves by inspection or otherwise as to the correctness of each of them;
- (c) No person in the employment of Irlams (Estate Agents) Ltd has any authority to make or give any representation or warranty whatsoever in relation to this property.

IRLAMs
of Knutsford