



**TO LET**

Queen Street, Knutsford

  
**IRLAM**  
*of Knutsford*



# Knutsford, WA16 6HZ

## Queen Street - £950 pcm



### The Property

This immaculately presented one bedroom semi detached property has recently undergone a full programme of refurbishment to now provide light and spacious accommodation in a contemporary style. Particular mention must be made of the refitted, white, high gloss kitchen with integrated appliances in an open plan style to the Living Dining room, the refitted, fully tiled shower room with walk in shower as well as the redecoration and new carpets/flooring throughout.

Located in the heart of the town, on the edge of the Town Centre conservation area, a stone's throw from Tatton Park

and the Heath and close to all local amenities whilst being ideally positioned for all major network links to the Northwest and beyond.

### Directions

From the roundabout at Canute Square head north along Manchester Road. Queen Street is the fourth turning on the right hand side. The property will soon be seen on your right. Queen Street can also be accessed off Tatton Street via George Street.



- An immaculately presented, refurbished property
- Situated in the heart of Knutsford Town Centre
- Open plan living space
- Newly fitted kitchen with integrated appliances
- Spacious bedroom
- Contemporary new shower room
- Unfurnished
- Available Mid October

**Postcode** – WA16 6HZ

**EPC Rating** – D

**Local Authority** – Cheshire East

**Council Tax** – Band B



GROUND FLOOR  
237 sq.ft. (22.0 sq.m.) approx.

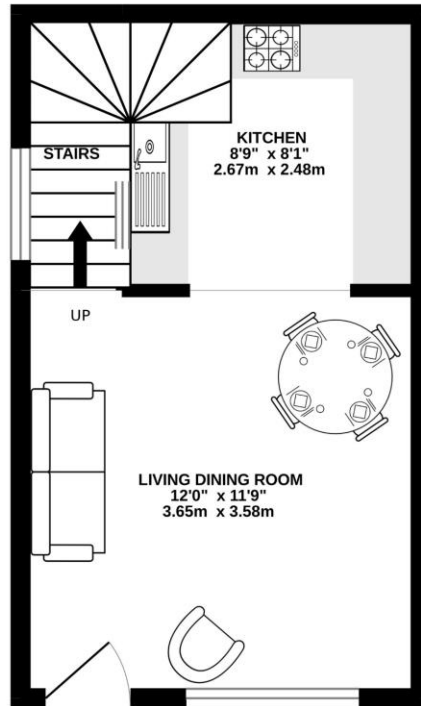

1ST FLOOR  
237 sq.ft. (22.0 sq.m.) approx.

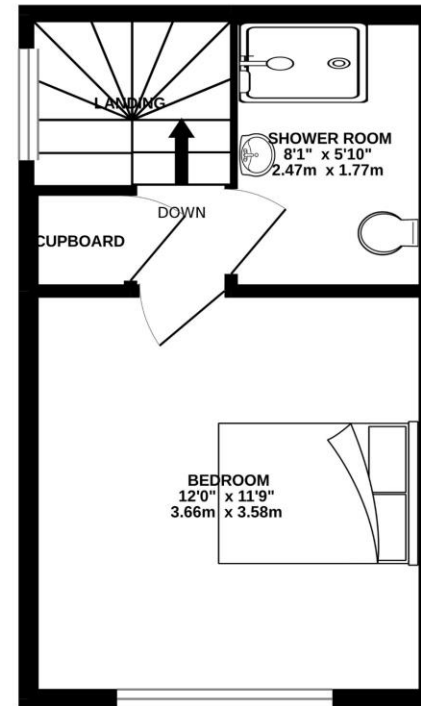

TOTAL FLOOR AREA : 473 sq.ft. (44.0 sq.m.) approx.

Whilst every attempt has been made to ensure the accuracy of the floorplan contained here, measurements of doors, windows, rooms and any other items are approximate and no responsibility is taken for any error, omission or mis-statement. This plan is for illustrative purposes only and should be used as such by any prospective purchaser. The services, systems and appliances shown have not been tested and no guarantee as to their operability or efficiency can be given.  
Made with Metropix ©2022

103 King Street, Knutsford, Cheshire, WA16 6EQ

01565 654 000

E: [info@irlamsestateagents.co.uk](mailto:info@irlamsestateagents.co.uk)

[www.irlamsestateagents.co.uk](http://www.irlamsestateagents.co.uk)

I1021\_ Printed by Ravensworth 01670 713330

Irlams (Estate Agents) Ltd for themselves and for the vendors or lessors of this property whose agents they are give notice that:

- (a) The particulars are set out as a general outline only for the guidance of intending purchasers or lessees, and do not constitute, nor constitute part of, an offer or contract;
- (b) All descriptions, dimensions, references to condition and necessary permissions for use and occupation, and other details are given in good faith and are believed to be correct but any intending purchasers or lessees should not rely on them as statements or representations of fact, but must satisfy themselves by inspection or otherwise as to the correctness of each of them;
- (c) No person in the employment of Irlams (Estate Agents) Ltd has any authority to make or give any representation or warranty whatsoever in relation to this property.

