



TO LET

Wash Lane, Allostock



**Allostock, WA16 9JS**

**Wash Lane**

**£950 pcm**



### **The Property**

Accessed via the sweeping driveway is this delightful barn conversion surrounded by open countryside. The barn has recently been refurbished and is extremely spacious to provide; large entrance hall living room with log burning stove, dining kitchen, double bedroom and bathroom. The property further benefits from having parking and oil central heating.

### **Directions**

Travel south from Knutsford town centre along A50 in the direction of Holmes Chapel and after approximately two miles turn right signed Lower Peover onto Middlewich Road (B5081). Continue through the village and pass The Crown Inn public house on your right heading towards Allostock. After passing Ashbrook Equine Hospital take the second left onto Wash Lane and turn left down the long driveway signed Hole House Farm.

- A spacious & characterful converted barn
- Situated in an idyllic location surrounded by open countryside
- Large living room with log burning stove
- Dining kitchen
- Double bedroom
- Parking
- Un-Furnished
- CTAX & Water Included
- Available now

**Postcode** – WA16 9JS

**EPC Rating** – TBC



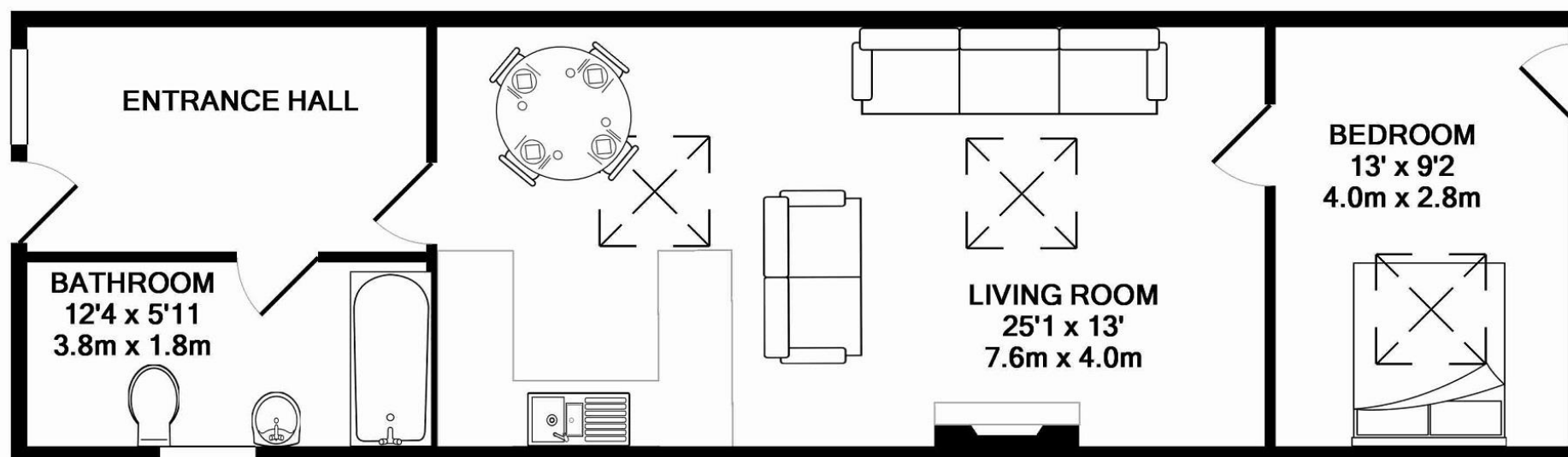

**TOTAL APPROX. FLOOR AREA 607 SQ.FT. (56.4 SQ.M.)**

Whilst every attempt has been made to ensure the accuracy of the floor plan contained here, measurements of doors, windows, rooms and any other items are approximate and no responsibility is taken for any error, omission, or mis-statement. This plan is for illustrative purposes only and should be used as such by any prospective purchaser. The services, systems and appliances shown have not been tested and no guarantee as to their operability or efficiency can be given

Made with Metropix ©2015

103 King Street, Knutsford, Cheshire, WA16 6EQ

**01565 654 000**

E: [info@irlamsestateagents.co.uk](mailto:info@irlamsestateagents.co.uk)

[www.irlamsestateagents.co.uk](http://www.irlamsestateagents.co.uk)

I1021\_ Printed by Ravensworth 01670 713330

Irlams (Estate Agents) Ltd for themselves and for the vendors or lessors of this property whose agents they are give notice that:  
(a) The particulars are set out as a general outline only for the guidance of intending purchasers or lessees, and do not constitute, nor constitute part of, an offer or contract;  
(b) All descriptions, dimensions, references to condition and necessary permissions for use and occupation, and other details are given in good faith and are believed to be correct but any intending purchasers or lessees should not rely on them as statements or representations of fact, but must satisfy themselves by inspection or otherwise as to the correctness of each of them;  
(c) No person in the employment of Irlams (Estate Agents) Ltd has any authority to make or give any representation or warranty whatsoever in relation to this property.

**IRLAMs**  
*of Knutsford*