



TO LET

Moorside, Knutsford

IRLAM
of Knutsford



Knutsford, WA16 6EZ

Moorside - £1,800 pcm



The Property

This gorgeous semi-detached cottage has been lovingly and sympathetically refurbished and sits in a quiet and convenient position at the heart of Knutsford Town Centre, just a short stroll from all local amenities, and is ideal for professional singles or couples. Particular mention must be made of the large, bright master bedroom with its stunning views over The Moor.

The property is approached via a charming front garden, stocked with pretty shrubs and hedges, and a flagged driveway provides off-road parking for two cars. To the rear

is an attractive, enclosed courtyard, laid to flag and stone, perfect for al fresco dining.

Directions

From King Street in the centre of Knutsford turn right onto Old Market Place passing Claire & Illingworth Opticians. Proceed down Old Market Place turning left onto Moorside opposite The Moor, where the property can be found on the left-hand side.

- A beautiful semi-detached cottage
- Situated in the heart of Knutsford Town Centre
- Spacious living room
- Dining kitchen with appliances
- Two bedrooms
- Shower room
- Off road parking & gardens.
- Unfurnished
- Available Beginning July

Postcode – WA16 6EZ

EPC Rating – D

Local Authority – Cheshire East

Council Tax – Band C



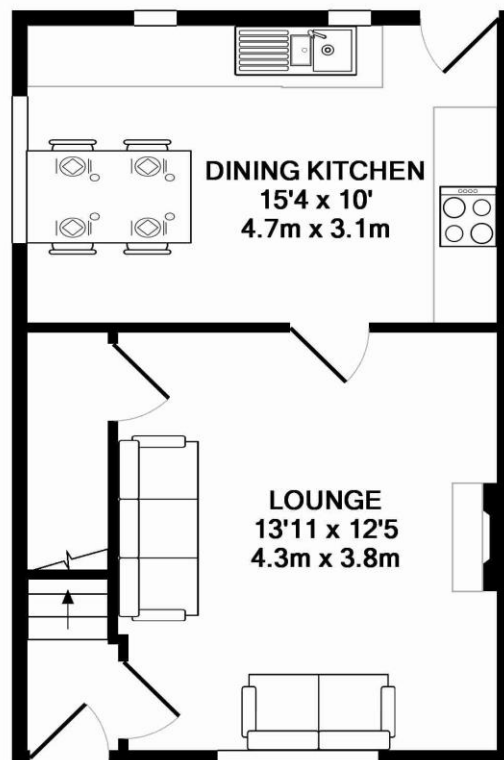

GROUND FLOOR
APPROX. FLOOR
AREA 368 SQ.FT.
(34.2 SQ.M.)

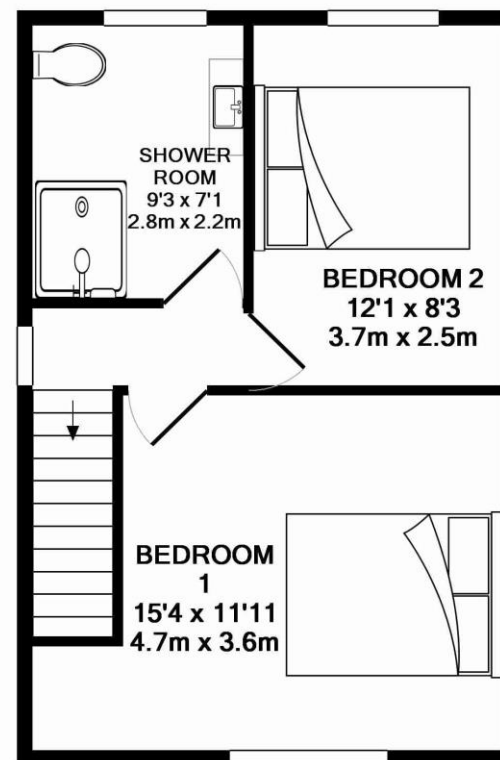

1ST FLOOR
APPROX. FLOOR
AREA 368 SQ.FT.
(34.2 SQ.M.)

TOTAL APPROX. FLOOR AREA 737 SQ.FT. (68.4 SQ.M.)

Whilst every attempt has been made to ensure the accuracy of the floor plan contained here, measurements of doors, windows, rooms and any other items are approximate and no responsibility is taken for any error, omission, or mis-statement. This plan is for illustrative purposes only and should be used as such by any prospective purchaser. The services, systems and appliances shown have not been tested and no guarantee as to their operability or efficiency can be given

Made with Metropix ©2016



103 King Street, Knutsford, Cheshire, WA16 6EQ

01565 654 000

E: info@irlamsestateagents.co.uk

www.irlamsestateagents.co.uk

I1021_ Printed by Ravensworth 01670 713330

Irlams (Estate Agents) Ltd for themselves and for the vendors or lessors of this property whose agents they are give notice that:
(a) The particulars are set out as a general outline only for the guidance of intending purchasers or lessees, and do not constitute, nor constitute part of, an offer or contract;
(b) All descriptions, dimensions, references to condition and necessary permissions for use and occupation, and other details are given in good faith and are believed to be correct but any intending purchasers or lessees should not rely on them as statements or representations of fact, but must satisfy themselves by inspection or otherwise as to the correctness of each of them;
(c) No person in the employment of Irlams (Estate Agents) Ltd has any authority to make or give any representation or warranty whatsoever in relation to this property.

IRLAMs
of Knutsford