



Mobberley
Great Oak Square



Mobberley, WA16 7GD

Great Oak Square

£162,500



The Property

This beautifully presented first floor apartment forms part of a modern development in the heart of Mobberley Village and within a short walk of all local amenities.

This property is presented as part of Cheshire East Council's Discount For Sale Scheme (further details available).

The property itself comes immaculately presented and offers bright living space with generous room proportions throughout including two double bedrooms and an open-plan living dining room with Juliet balcony.

Externally, the property is approached via a well-maintained communal hallway leading to the first floor apartment's private entrance. There is allocated & visitor parking.

In addition, the apartment overlooks the lovely communal gardens with pathway, lawned & seating areas.

Directions

From the roundabout in Canute Square travel along King Edward Road (A50) at the traffic lights turn left passing the rail station on your left and Aldi supermarket. At the next lights turn left up Hollow Lane onto Mobberley Road. Continue along this road passing the Bentley Garage and upon entering Mobberley Village turn left onto Ilford Way and first right into Marion Drive and follow the road around Great Oak Square where the entrance to the apartment will soon be seen.

- A beautifully presented first floor apartment
- Situated in the heart of Mobberley village & amenities
- Spacious open plan living accommodation
- Two double bedrooms
- Lovely refitted bathroom
- Allocated & visitor parking
- Views over the communal gardens

Postcode – WA16 7GD

EPC Rating – TBC

Tenure – Leasehold

(Service charge £150.76 per month/Ground Rent £160 per annum)

Local Authority – Cheshire East

Council Tax – Band C



GROUND FLOOR
606 sq.ft. (56.3 sq.m.) approx.

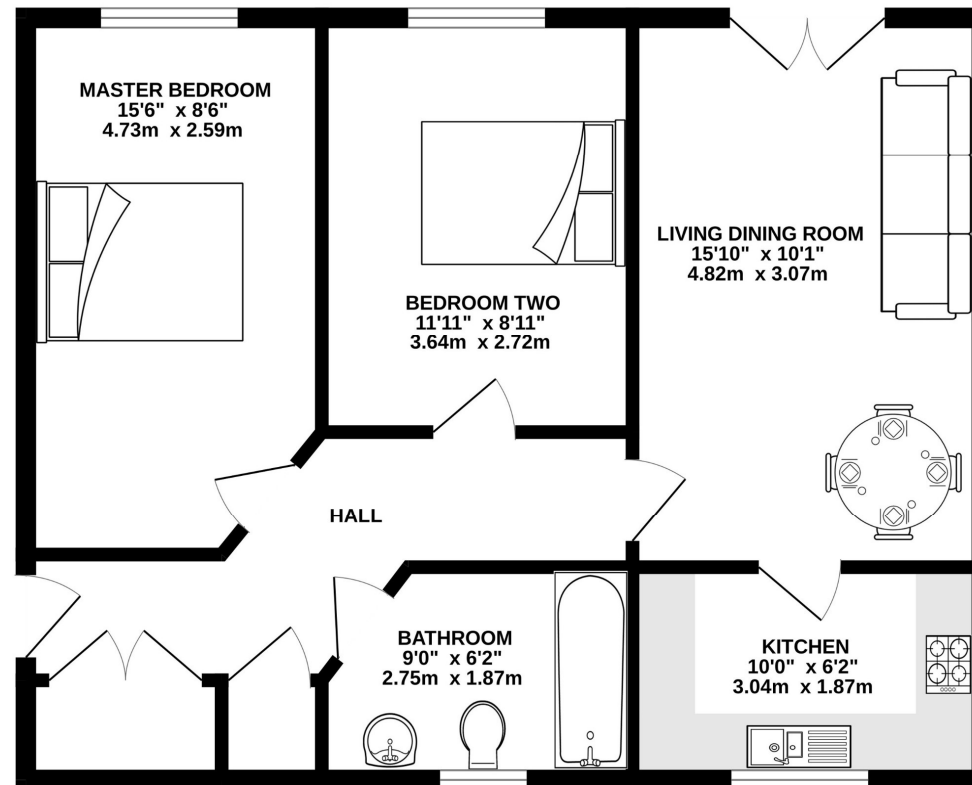

TOTAL FLOOR AREA : 606 sq.ft. (56.3 sq.m.) approx.

Whilst every attempt has been made to ensure the accuracy of the floorplan contained here, measurements of doors, windows, rooms and any other items are approximate and no responsibility is taken for any error, omission or mis-statement. This plan is for illustrative purposes only and should be used as such by any prospective purchaser. The services, systems and appliances shown have not been tested and no guarantee as to their operability or efficiency can be given.
Made with Metropix ©2024

103 King Street, Knutsford, Cheshire, WA16 6EQ

01565 654 000

E: info@irlamsestateagents.co.uk

www.irlamsestateagents.co.uk

I1021_ Printed by Ravensworth 01670 713330

Irlams (Estate Agents) Ltd for themselves and for the vendors or lessors of this property whose agents they are give notice that:

- (a) The particulars are set out as a general outline only for the guidance of intending purchasers or lessees, and do not constitute, nor constitute part of, an offer or contract;
- (b) All descriptions, dimensions, references to condition and necessary permissions for use and occupation, and other details are given in good faith and are believed to be correct but any intending purchasers or lessees should not rely on them as statements or representations of fact, but must satisfy themselves by inspection or otherwise as to the correctness of each of them;
- (c) No person in the employment of Irlams (Estate Agents) Ltd has any authority to make or give any representation or warranty whatsoever in relation to this property.

