



Knutsford
Parkgate

IRLAM
of Knutsford

Knutsford, WA16 8HF

Parkgate

£325,000



The Property

This charming two bedroom detached bungalow is deceptively spacious well presented throughout. Particular mention must be made of the large living dining room with sliding patio doors leading to the rear garden. The property sits in an attractive, popular location within Knutsford Town Centre and close to all local amenities. The property is approached via a beautifully presented front garden with driveway providing off-road parking. A garage provides further parking/storage. To the rear is an enclosed garden laid mainly to lawn with a patio area ideal for al fresco dining and capturing the afternoon sun.

Directions

From the roundabout in Canute Square travel along King Edward Road (A50) turning left at the traffic lights and passing the railway station. Turn left again at the next traffic lights up Hollow Lane onto Mobberley Road and after passing the Fire Station on your left turn left onto Parkgate Lane passing the parade of shops on your right. Take the next right onto Parkgate where the property can then be found after a short distance on your left.

- A charming, detached bungalow
- Situated within a short walk of Knutsford town centre & Tatton Park
- Spacious & flexible living accommodation
- Breakfast kitchen
- Two double bedrooms
- Bathroom
- Enclosed garden with lawn & patio area
- Driveway parking plus garage

Postcode – WA16 8HF

EPC Rating – D

Local Authority – Cheshire East

Tenure – Leasehold

(999 years from circa 1957/GR £13 per annum)

Council Tax – Band D



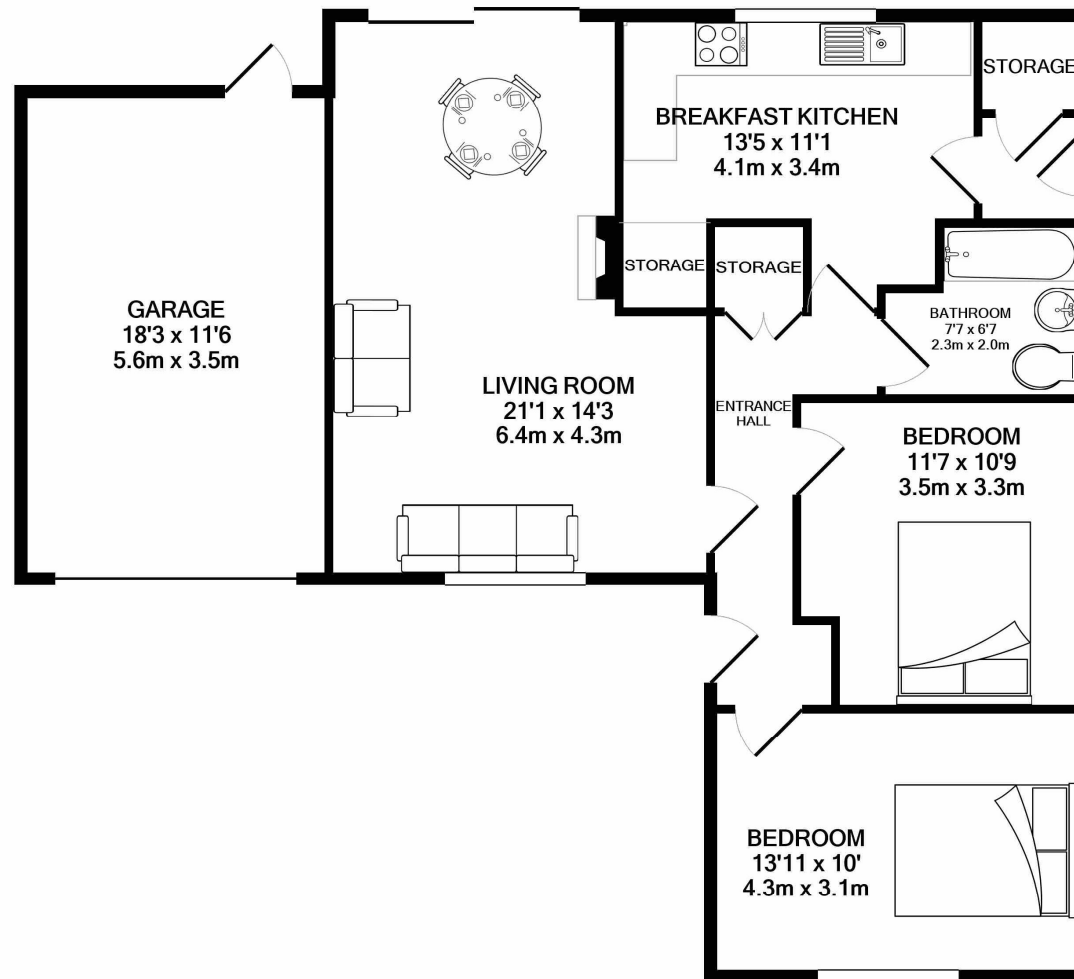

TOTAL APPROX. FLOOR AREA 1010 SQ.FT. (93.9 SQ.M.)

Whilst every attempt has been made to ensure the accuracy of the floor plan contained here, measurements of doors, windows, rooms and any other items are approximate and no responsibility is taken for any error, omission, or mis-statement. This plan is for illustrative purposes only and should be used as such by any prospective purchaser. The services, systems and appliances shown have not been tested and no guarantee as to their operability or efficiency can be given
Made with Metropix ©2020

103 King Street, Knutsford, Cheshire, WA16 6EQ

01565 654 000

E: info@irlamsestateagents.co.uk

www.irlamsestateagents.co.uk

I1021_ Printed by Ravensworth 01670 713330

Irlams (Estate Agents) Ltd for themselves and for the vendors or lessors of this property whose agents they are give notice that:

- (a) The particulars are set out as a general outline only for the guidance of intending purchasers or lessees, and do not constitute, nor constitute part of, an offer or contract;
- (b) All descriptions, dimensions, references to condition and necessary permissions for use and occupation, and other details are given in good faith and are believed to be correct but any intending purchasers or lessees should not rely on them as statements or representations of fact, but must satisfy themselves by inspection or otherwise as to the correctness of each of them;
- (c) No person in the employment of Irlams (Estate Agents) Ltd has any authority to make or give any representation or warranty whatsoever in relation to this property.

