



TO LET

Bexton Road, Knutsford

  
**IRLAM**  
*of Knutsford*





# Knutsford, WA16 0EE

## Bexton Road - £1,500 pcm



### The Property

This charming end-terraced house has been lovingly maintained and comes beautifully presented throughout. Sitting in an enviable position at the heart of Knutsford Town Centre, the property lies within a short stroll of all local amenities, including Knutsford's shops, bars and restaurants, as well as its stunning outdoor spaces such as Tatton Park and The Heath. The house itself offers beautiful accommodation throughout in a period style blended with modern features. Particular mention must be made of the generous open-plan living dining room, modern kitchen and private enclosed garden. The property is approached via a pretty front courtyard garden laid to flag. To the rear is a good-sized enclosed garden laid mainly to lawn and bordered by mature trees

and hedges offering a fantastic degree of privacy. A flagged patio area also provides the perfect opportunity for al fresco dining whilst capturing the afternoon and evening sun.

### Directions

From the roundabout in the centre of Knutsford, proceed along King Edward Road to the traffic light and turn right onto Stanley Road. At the mini roundabout take the third exit onto Bexton Road where the property can be found on the left-hand side.



- A Stunning Period End-Terrace
- Generous living space
- Utility Room & downstairs WC
- Modern Kitchen
- Two bedrooms
- Private Garden
- Town Centre Location
- Short walk to all local amenities
- Furnished/Unfurnished
- Available Mid- May

**Postcode** – WA16 0EE

**EPC Rating** – TBC

**Local Authority** – Cheshire East

**Council Tax** – D



GROUND FLOOR

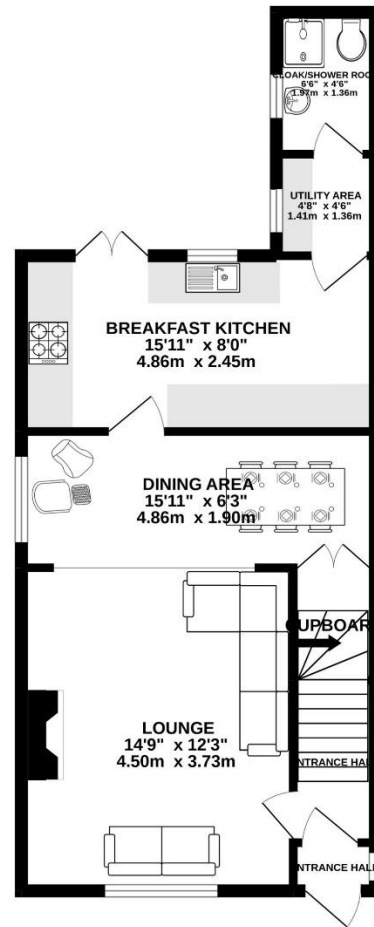

1ST FLOOR

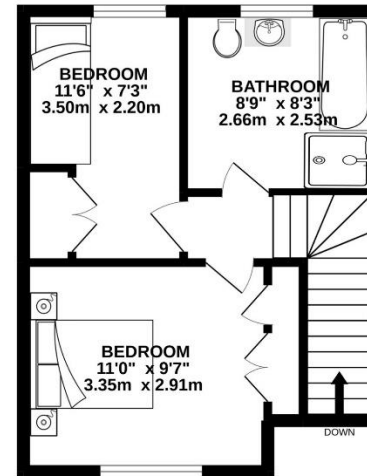

Whilst every attempt has been made to ensure the accuracy of the floorplan contained here, measurements of doors, windows, rooms and any other items are approximate and no responsibility is taken for any error, omission or mis-statement. This plan is for illustrative purposes only and should be used as such by any prospective purchaser. The services, systems and appliances shown have not been tested and no guarantee as to their operability or efficiency can be given.  
Made with Metropix ©2022

103 King Street, Knutsford, Cheshire, WA16 6EQ

01565 654 000

E: [info@irlamsestateagents.co.uk](mailto:info@irlamsestateagents.co.uk)

[www.irlamsestateagents.co.uk](http://www.irlamsestateagents.co.uk)

I1021\_ Printed by Ravensworth 01670 713330

Irlams (Estate Agents) Ltd for themselves and for the vendors or lessors of this property whose agents they are give notice that:

- (a) The particulars are set out as a general outline only for the guidance of intending purchasers or lessees, and do not constitute, nor constitute part of, an offer or contract;
- (b) All descriptions, dimensions, references to condition and necessary permissions for use and occupation, and other details are given in good faith and are believed to be correct but any intending purchasers or lessees should not rely on them as statements or representations of fact, but must satisfy themselves by inspection or otherwise as to the correctness of each of them;
- (c) No person in the employment of Irlams (Estate Agents) Ltd has any authority to make or give any representation or warranty whatsoever in relation to this property.

  
**IRLAMs**  
*of Knutsford*