





Knutsford, WA16 8HX

Church Mews

Offers over £338,000



The Property

This beautifully presented two bedroom mews property has been recently renovated and improved to now provide light, bright and spacious living accommodation in a modern style. Particular mention must be made of the well designed and appointed internal accommodation, the newly fitted shower suite as well as the thoughtfully landscaped private rear gardens.

Located in an elevated position forming part of a small development of similar properties within a short stroll of the town centre and Tatton Park, whilst being ideally positioned for all major network links to the northwest and beyond.

The property is approached via a flagged pathway, leading to the front entrance, flanked by lawned garden and screened by mature trees and hedging. The rear gardens are a lovely feature of the

property, being a generous size with a private aspect. Landscaped with artificial grass for ease of maintenance with a lovely stone flagged patio area, ideal for alfresco dining, fully enclosed with mature hedging providing a high level of privacy. In addition, there is a single garage, ideal for additional storage and parking if required.

Directions

From the roundabout in Canute Square travel along King Edward Road (A50) turning left at the rail station down Adams Hill. At the next set of lights turn left up Hollow Lane onto Mobberley Road. Just after passing St Cross Church turn right into Church Mews.

- An immaculately presented mews property
- Situated in the heart of Knutsford town centre & all its amenities
- Spacious living accommodation
- Two bedrooms
- Shower room
- Private, easily maintained garden
- Garage

Postcode – WA16 8HX

EPC Rating – C

Tenure – Leasehold

(999 year lease from 1991 – Ground rent £35 per annum)

Local Authority – Cheshire East

Council Tax – Band D



GROUND FLOOR
336 sq.ft. (31.2 sq.m.) approx.

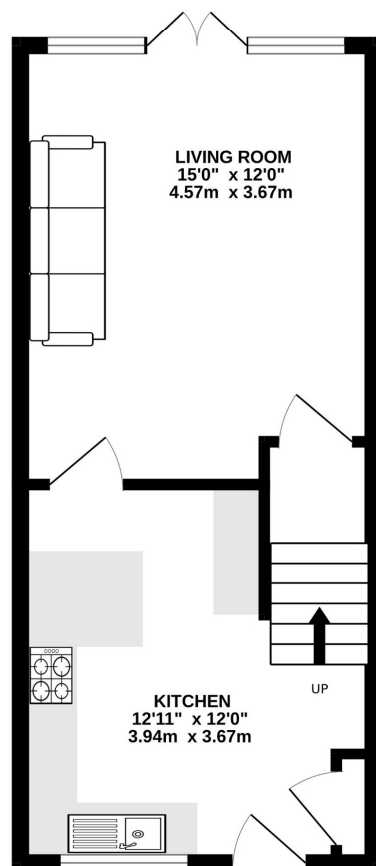

1ST FLOOR
336 sq.ft. (31.2 sq.m.) approx.

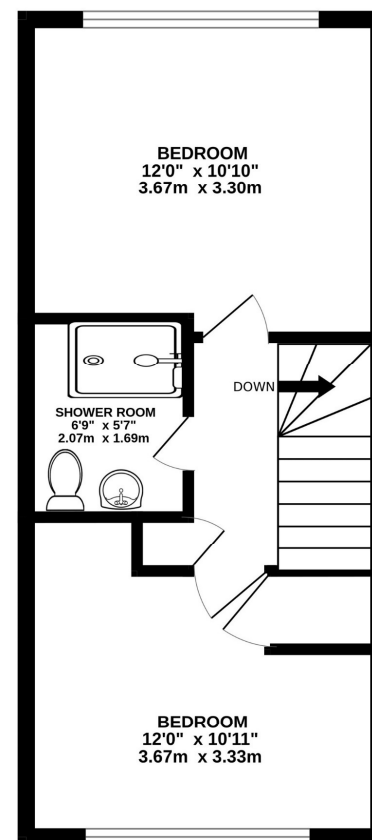

TOTAL FLOOR AREA: 672 sq.ft. (62.4 sq.m.) approx.

Whilst every attempt has been made to ensure the accuracy of the floorplan contained here, measurements of doors, windows, rooms and any other items are approximate and no responsibility is taken for any error, omission or mis-statement. This plan is for illustrative purposes only and should be used as such by any prospective purchaser. The services, systems and appliances shown have not been tested and no guarantee as to their operability or efficiency can be given.
Made with Metropix ©2024

103 King Street, Knutsford, Cheshire, WA16 6EQ

01565 654 000

E: info@irlamsestateagents.co.uk

www.irlamsestateagents.co.uk

I1021_ Printed by Ravensworth 01670 713330

Irlams (Estate Agents) Ltd for themselves and for the vendors or lessors of this property whose agents they are give notice that:

- (a) The particulars are set out as a general outline only for the guidance of intending purchasers or lessees, and do not constitute, nor constitute part of, an offer or contract;
- (b) All descriptions, dimensions, references to condition and necessary permissions for use and occupation, and other details are given in good faith and are believed to be correct but any intending purchasers or lessees should not rely on them as statements or representations of fact, but must satisfy themselves by inspection or otherwise as to the correctness of each of them;
- (c) No person in the employment of Irlams (Estate Agents) Ltd has any authority to make or give any representation or warranty whatsoever in relation to this property.