



Over Peover
Cinder Lane

Over Peover, WA16 8UR

Cinder Lane

£1,300,000



The Property

A detached former farmhouse offering fantastic redevelopment potential (subject to relevant permissions) in the heart of Over Peover village with paddock extending to 2 Acres. The property sits on a quiet country lane in a stunning semi rural position, a short stroll to The Dog Public House and many country walks, enjoying far reaching views over of its land and adjoining countryside with a range of large outbuildings formerly used for cattle farming and working the land.

Over Peover sits in a very desirable location between the cosmopolitan towns of Knutsford and Alderley Edge with fantastic local and private schools close by and being well positioned for all major network links to the Northwest and beyond. The property is approached through stone pillar gates over a sweeping driveway leading to the rear entrance, detached garaging and

hay barn with ample parking and turning space, retained by mature hedging and trees. The gardens are mainly found to the side and rear with a range of outbuildings including former Shippon, Coal House, Pigsties and workshop as well as timber constructed sheds and chicken run. A one acre paddock is found to the side of the property offering great potential for equestrian purposes or hobbies.

Directions

From Knutsford Town Centre proceed along Toft Road (A50) and continue for approx. 2.4 miles towards Over Peover. Turn left onto Stocks Lane which turns into Wellbank Lane and turn right onto Cinder Lane where the property will soon be seen.



- A detached farmhouse offering excellent potential to remodel/redevelop
- Desirable location & quiet semi-rural position
- Generous gardens, paddock & field extending to 2 acres
- Driveway & ample off road parking
- Detached double garage
- Range of outbuildings
- No chain

Postcode – WA16 8UR
Tenure – Freehold
Local Authority – Cheshire East
Council Tax – Band G



GROUND FLOOR
3084 sq.ft. (286.5 sq.m.) approx.

1ST FLOOR
1117 sq.ft. (103.8 sq.m.) approx.

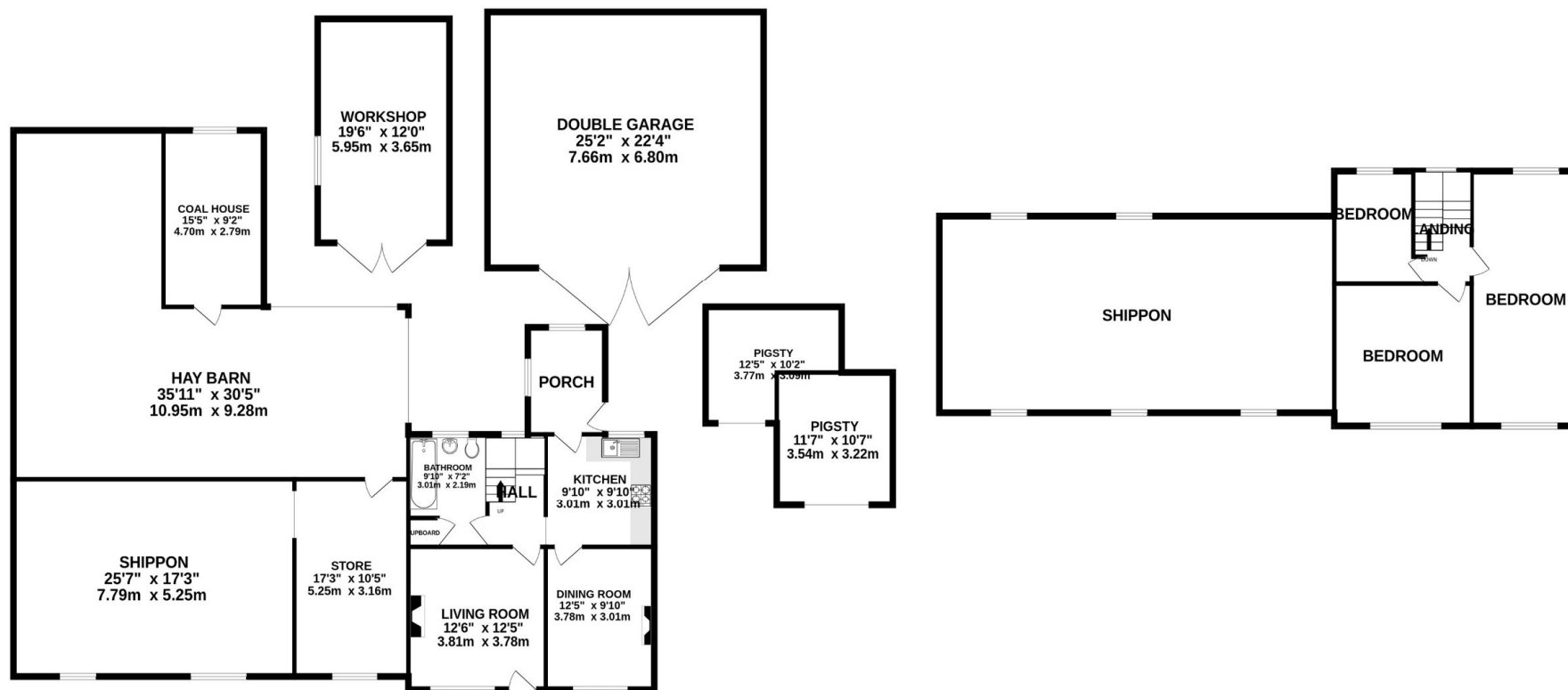

TOTAL FLOOR AREA : 4201 sq.ft. (390.3 sq.m.) approx.

Whilst every attempt has been made to ensure the accuracy of the floorplan contained here, measurements of doors, windows, rooms and any other items are approximate and no responsibility is taken for any error, omission or mis-statement. This plan is for illustrative purposes only and should be used as such by any prospective purchaser. The services, systems and appliances shown have not been tested and no guarantee as to their operability or efficiency can be given.

Made with Metropix ©2023

103 King Street, Knutsford, Cheshire, WA16 6EQ

01565 654 000

E: info@irlamsestateagents.co.uk

www.irlamsestateagents.co.uk

I1021_ Printed by Ravensworth 01670 713330

Irlams (Estate Agents) Ltd for themselves and for the vendors or lessors of this property whose agents they are give notice that:

- (a) The particulars are set out as a general outline only for the guidance of intending purchasers or lessees, and do not constitute, nor constitute part of, an offer or contract;
- (b) All descriptions, dimensions, references to condition and necessary permissions for use and occupation, and other details are given in good faith and are believed to be correct but any intending purchasers or lessees should not rely on them as statements or representations of fact, but must satisfy themselves by inspection or otherwise as to the correctness of each of them;
- (c) No person in the employment of Irlams (Estate Agents) Ltd has any authority to make or give any representation or warranty whatsoever in relation to this property.

