



TO LET

Heathlands House, Gaskell Avenue, Knutsford





Knutsford, WA16 0DB

Heathlands House, Gaskell Avenue
£1,250 pcm



The Property

This superbly presented ground floor apartment forms part of an exclusive development at the heart of Knutsford town centre, sitting within a short stroll of all local amenities including its shops, bars and restaurants, as well as its stunning outdoor spaces such as Tatton Park and The Heath. The property itself provides modern, spacious accommodation throughout. Particular mention must be made of the large living room, and separate dining kitchen with appliances. The property is

approached via a secure communal entrance, and private car park providing allocated off-road parking.

Directions

From the roundabout in the centre of Knutsford, take the exit onto Gaskell Avenue whereby Heathlands House can be found after a short distance on the left-hand side.

- Modern ground floor apartment
- Town center location
- Private enclosed garden area
- Two double bedrooms
- En-suite shower room
- Allocated off-road parking space
- Furnished
- Available Now

Postcode – WA16 0DB

EPC Rating – TBC

Local Authority – Cheshire East

Council Tax – Band D



GROUND FLOOR
739 sq.ft. (68.7 sq.m.) approx.

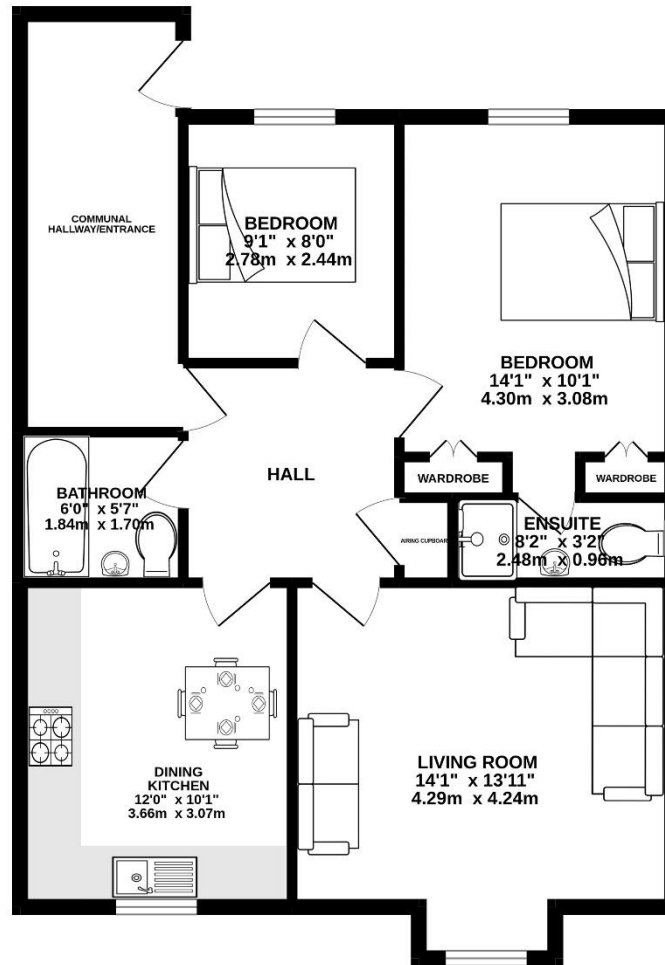

TOTAL FLOOR AREA : 739 sq.ft. (68.7 sq.m.) approx.

Whilst every attempt has been made to ensure the accuracy of the floorplan contained here, measurements of doors, windows, rooms and any other items are approximate and no responsibility is taken for any error, omission or mis-statement. This plan is for illustrative purposes only and should be used as such by any prospective purchaser. The services, systems and appliances shown have not been tested and no guarantee as to their operability or efficiency can be given.
Made with Metropix ©2022

- (a) The particulars are set out as a general outline only for the guidance of intending purchasers or lessees, and do not constitute, nor constitute part of, an offer or contract;
- (b) All descriptions, dimensions, references to condition and necessary permissions for use and occupation, and other details are given in good faith and are believed to be correct but any intending purchasers or lessees should not rely on them as statements or representations of fact, but must satisfy themselves by inspection or otherwise as to the correctness of each of them;
- (c) No person in the employment of Irlams (Estate Agents) Ltd has any authority to make or give any representation or warranty whatsoever in relation to this property.