

# HUNTERS<sup>®</sup>

HERE TO GET *you* THERE



## Sheriff Lane

Broadstones Park, Bingley, BD16 3LT

Asking Price £80,000

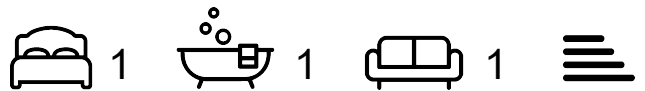

Superbly positioned on an impressive and highly regarded park home site, Broadstone Park is a very well maintained residential over 55's development that offers full year round residency.

A excellent opportunity to purchase an impressive one bedroom detached park home located centrally on a well managed over 55's site. The beautifully presented home offers flexible living accommodation, and comprises entrance hall, lounge, kitchen, double bedroom house bathroom.

Externally are low maintenance gardens which enjoy a lovely sunny aspect and a single parking bay. The property is available for cash purchasers only.

The property is situated within a very well regarded semi rural setting in a private extremely popular development. The location is convenient for Bingley town centre, its amenities and transport connections.

We have been informed by the vendor the ground rent is £127 per month.

Access to Broadstones Park is advised to Sheriff Lane via Gilstead Lane.



## Area Map

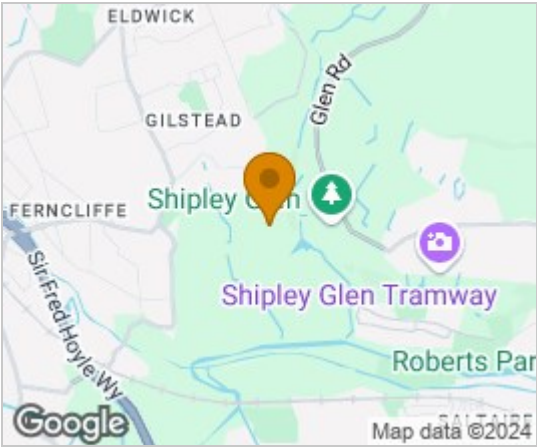

## Floor Plans

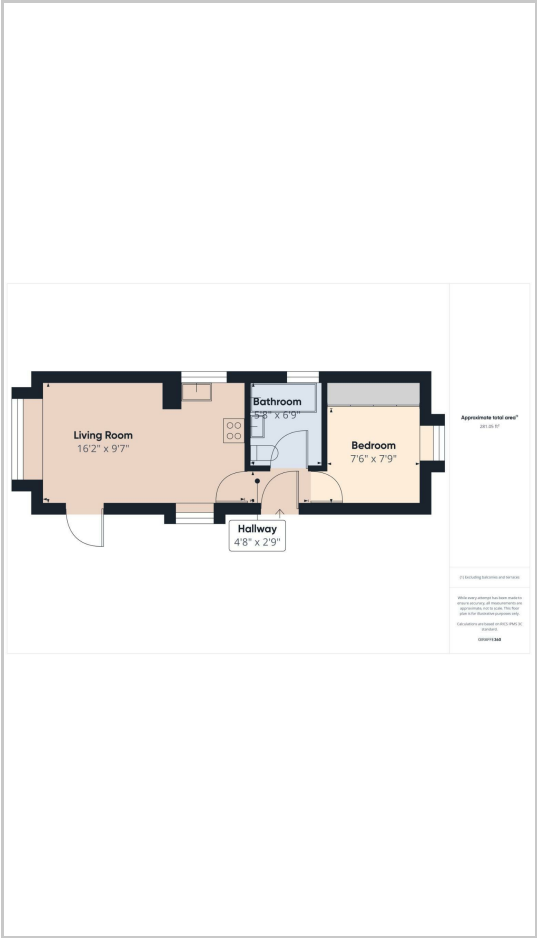

## Energy Efficiency Graph

These particulars are intended to give a fair and reliable description of the property but no responsibility for any inaccuracy or error can be accepted and do not constitute an offer or contract. We have not tested any services or appliances (including central heating if fitted) referred to in these particulars and the purchasers are advised to satisfy themselves as to the working order and condition. If a property is unoccupied at any time there may be reconnection charges for any switched off/disconnected or drained services or appliances - All measurements are approximate. **THINKING OF SELLING?** If you are thinking of selling your home or just curious to discover the value of your property, Hunters would be pleased to provide free, no obligation sales and marketing advice. Even if your home is outside the area covered by our local offices we can arrange a Market Appraisal through our national network of Hunters estate agents.