



Jordanthorpe Green, Sheffield S8 8DZ

Guide Price £160,000

Guide Price £160,000 - £170,000

Virtual Tour Available

SK Estate Agents are pleased to offer to the market for sale with NO ONWARD CHAIN this stunningly presented, 2 bedroomed, end townhouse. Enjoying a position within this popular residential area, the property takes in attractive views and boasts off-road parking to the front whilst enjoying a private garden to the rear. The accommodation is presented to a high standard throughout and in brief comprises: entrance hallway, lounge, kitchen, two bedrooms and a modern shower room. This property must be viewed to be fully appreciated.

Tenure: Leasehold



Entrance

Accessed via a modern front-facing composite door into the entrance hallway featuring carpeted flooring, a central heating radiator, and stairs rising to the first floor. Includes a security alarm system.

Lounge

12'5" x 12'7" (3.81m x 3.86m)

A stylish lounge with a front-facing UPVC double glazed window, laminate flooring, and a central heating radiator. Boasts a feature gas fire with a marble hearth and contemporary wooden surround and includes a useful under stairs storage cupboard. Side facing UPVC double glazed window.

Kitchen

12'7" x 7'9" (3.86m x 2.38m)

A modern kitchen fitted with a range of white and grey wall and base units, complemented by square-edged marble-effect worktops incorporating a 4 ring gas hob with extractor above. Features a stainless steel sink with swan-neck mixer tap, integrated fridge and freezer, integrated dishwasher, space and plumbing for a washing machine and a storage cupboard housing the Baxi combi boiler. Finished with cushioned flooring, a rear-facing UPVC double glazed window overlooking the garden, rear UPVC door, and a kickboard heater.

Landing

Carpeted landing area with side-facing UPVC obscure glass window.

Shower Room

6'0" x 6'2" (1.83m x 1.88m)

A recently updated, modern shower room with tiled splashbacks, a glass shower screen, chrome rainwater shower with recessed shelving, vanity sink unit with chrome mixer tap, and low-flush WC. Includes laminate flooring, chrome heated towel rail, and a rear-facing UPVC obscure double glazed window.

Bedroom One

9'6" x 11'9" (2.92m x 3.60m)

Spacious and well presented principal bedroom with front-facing UPVC double glazed window, laminate flooring, central heating radiator, and two large over stairs storage cupboards.

Bedroom Two

6'0" x 8'11" (1.85m x 2.72m)

Rear-facing bedroom with UPVC double glazed window offering views across the field to the rear, laminate flooring, and central heating radiator.

Outside

To the front of the property lies a driveway for off-road parking and a small lawned area.

Enjoying side access, the enclosed rear garden features a modern patio area and pleasant open views over the rear fields. Bounded by fencing for added privacy.



sales • letting • property management



Website: www.skestateagents.co.uk

Email: info@skestateagents.co.uk

Address: 868 Chesterfield Road, Woodseats, Sheffield, S8 0SH

Telephone: 0114 2749730

Company No: 08028567



In accordance with the Property Misdescriptions Act (1991) we have prepared these property particulars as a general guide to a broad description of the property. They are not intended to constitute part of an offer or contract. We have not carried out a structural survey and the services, appliances and the specific fittings have not been tested. All photographs, measurements, floor plans and distances referred to are given as a guide only and should not be relied upon for the purchase of carpets or any other fixtures or fittings.

Lease details, ground rent and service charges (where applicable) are given as a guide only and should be checked by your solicitor prior to exchange of contracts. The copyright of all details, photographs and floor plans remains that of SK Estate Agents



sales • letting • property management



Website: www.skestateagents.co.uk **Email:** info@skestateagents.co.uk
Address: 868 Chesterfield Road, Woodseats, Sheffield, S8 0SH

Telephone: 0114 2749730
Company No: 08028567

Approx Gross Internal Area
50 sq m / 543 sq ft

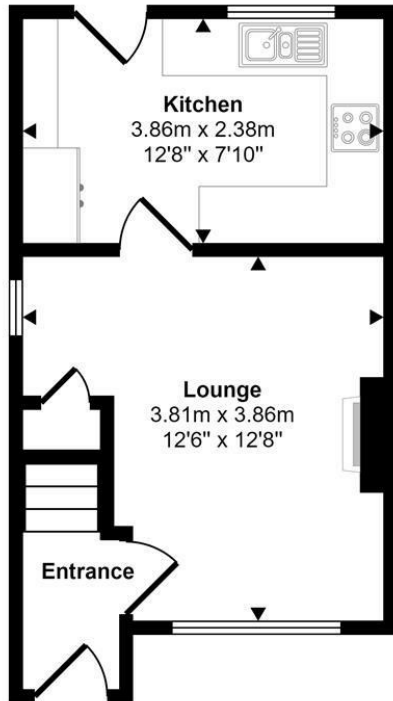

Ground Floor
Approx 25 sq m / 272 sq ft

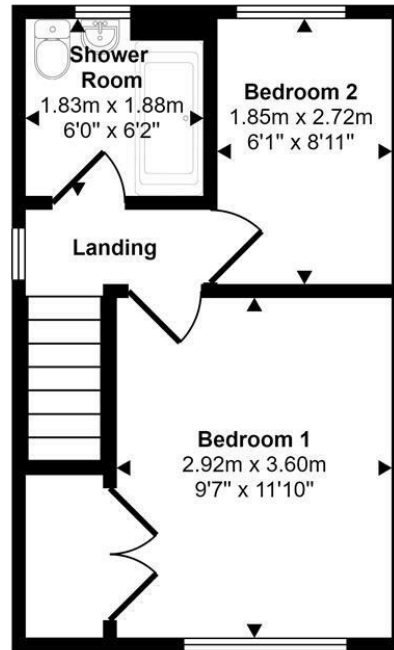

First Floor
Approx 25 sq m / 271 sq ft

This floorplan is only for illustrative purposes and is not to scale. Measurements of rooms, doors, windows, and any items are approximate and no responsibility is taken for any error, omission or mis-statement. Icons of items such as bathroom suites are representations only and may not look like the real items. Made with Made Snappy 360.

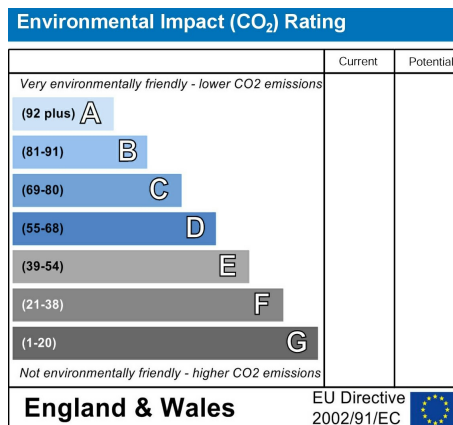
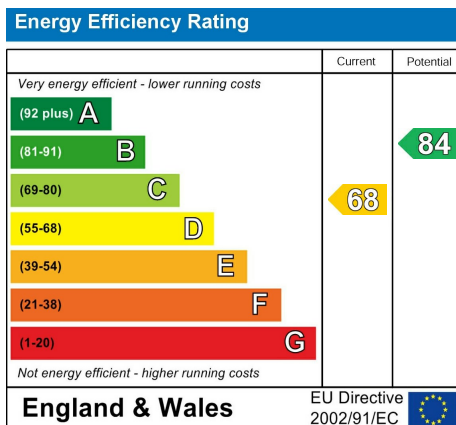

sales • letting • property management



Website: www.skestateagents.co.uk

Email: info@skestateagents.co.uk

Telephone: 0114 2749730

Address: 868 Chesterfield Road, Woodseats, Sheffield, S8 0SH

Company No: 08028567