



Taylor
Robinson



Argus Walk, Bewbush, Crawley RH11 8BQ

£264,950

www.taylor-robinson.co.uk

A spacious and well presented 3 bedroom house benefiting from a refitted kitchen and bathroom, useful downstairs cloakroom and 17'9 x 15'3 Living room. The property also offers radiator heating and replacement double glazed windows. Ideally situated on the edge of Bewbush with access to local schools and Fastway bus services. No Chain

Front door

Entrance Lobby

Entrance Hall

Downstairs Cloakroom

Living Room 17' 9" x 15' 3" (5.41m x 4.64m)

Refitted Kitchen 11' 6" x 10' 5" (3.50m x 3.17m)

First Floor Landing

Bedroom 1 11' 4" x 11' 1" (3.45m x 3.38m)

Bedroom 2 14' 9" x 8' 5" (4.49m x 2.56m)

Bedroom 3 10' 7" x 6' 6" (3.22m x 1.98m)

Family Bathroom

Outside

Rear Garden



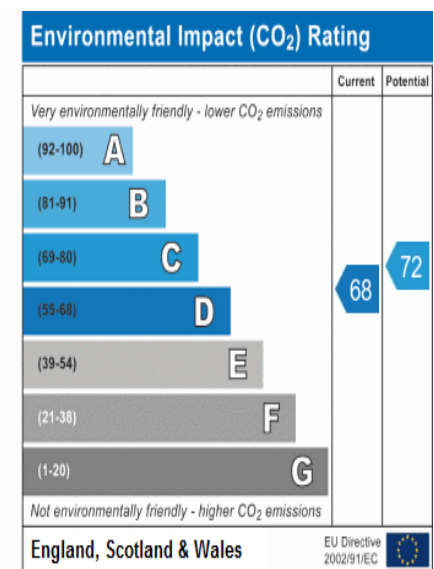
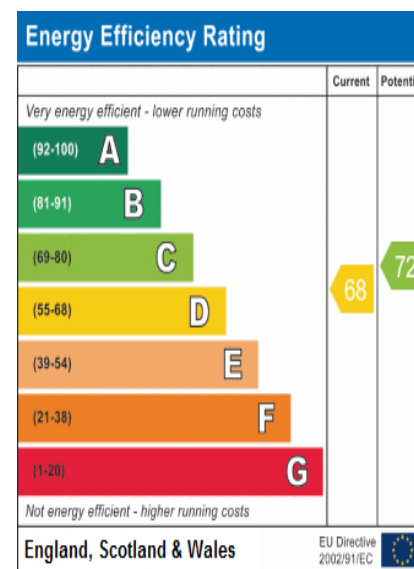

Argus Walk, Crawley, Bewbush, RH11 8BQ

Floorplan

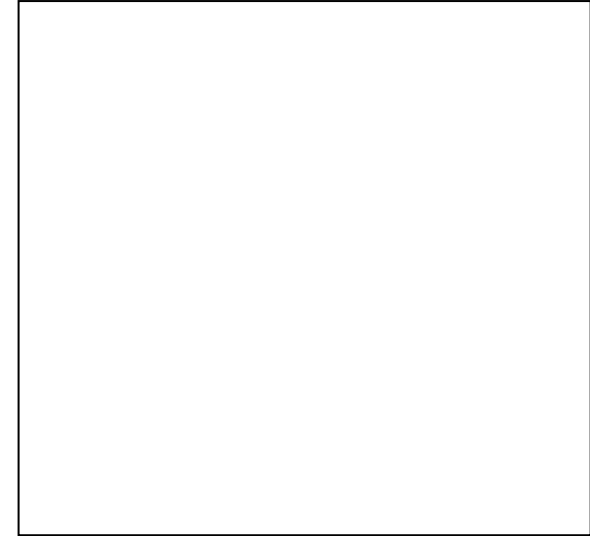
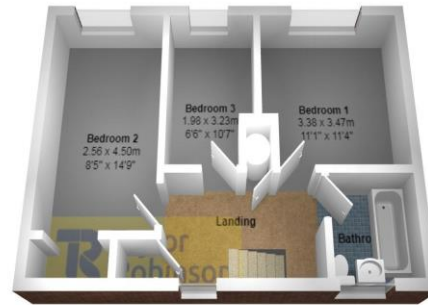
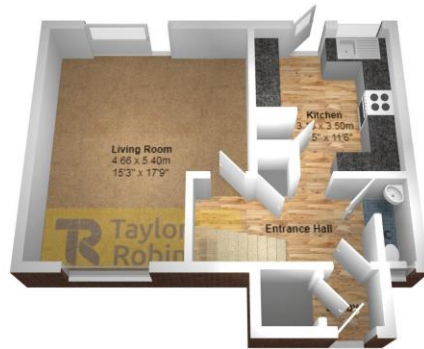

Please note that no appliances or systems have been tested. All measurements are approximate and must not be relied upon for any purpose. Any appliance listed in these details may not be included in the sale price. These particulars do not form any part of an offer or contract and their accuracy cannot be guaranteed. Lease information where applicable is provided by the vendor. Taylor Robinson cannot be held liable if the information is incorrect.



Crawley
2 Brittingham House
Orchard Street
Crawley
RH11 7AE

01293 552 388
sales@taylor-robinson.co.uk

Horsham
42 London Road
Horsham
West Sussex
RH12 1AY

01403 338 175
Horsham@taylor-robinson.co.uk