

Mount Road New Malden KT3



- **Five Bedroom Two Bathroom Period House**
- **Superb Kitchen/Dining/Family Room**
- **Pretty Garden**
- **Close to Excellent Schools**

Price £773,000

An immaculate five bedroom two bathroom semi-detached period house located on the edge of the Groves within close proximity of excellent schools and within easy access of New Malden Station and High Street. The property comprises reception room with bay window, superb kitchen/dining/family room with underfloor heating and surround sound, a downstairs cloakroom and utility room with plenty of storage. On the first floor there are two double and a single bedroom together with a family bathroom. On the second floor there are a further two bedrooms and a shower room. The property also benefits from a pretty landscaped garden with patios along with side access. EPC rating D.



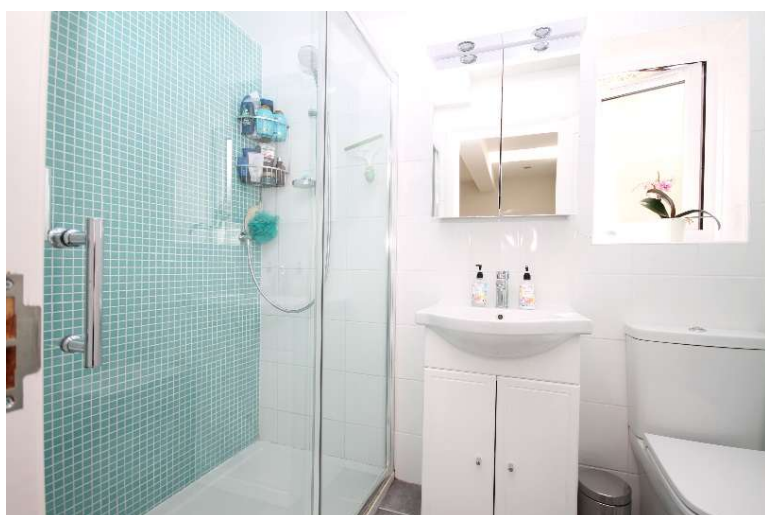



GROUND FLOOR
APPROX. FLOOR
AREA 645 SQ.FT.
(59.9 SQ.M.)

TOTAL APPROX. FLOOR AREA 1515 SQ.FT. (140.8 SQ.M.)

Whilst every attempt has been made to ensure the accuracy of the floor plan contained here, measurements of doors, windows, rooms and any other items are approximate and no responsibility is taken for any error, omission, or mis-statement. This plan is for illustrative purposes only and should be used as such by any prospective purchaser. The services, systems and appliances shown have not been tested and no guarantee as to their operability or efficiency can be given.
Made with Metropix ©2018

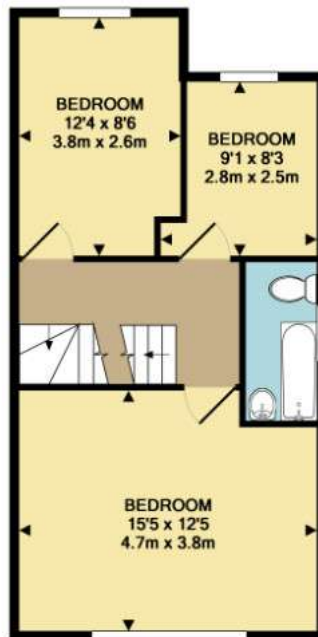

1ST FLOOR
APPROX. FLOOR
AREA 459 SQ.FT.
(42.7 SQ.M.)

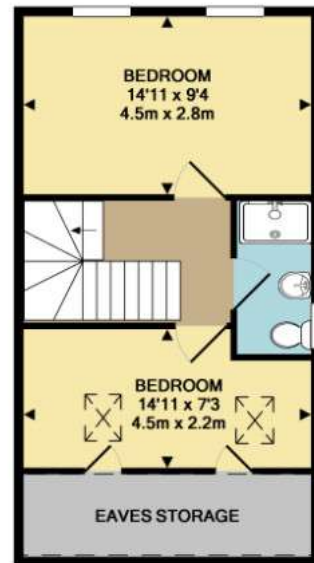

2ND FLOOR
APPROX. FLOOR
AREA 411 SQ.FT.
(38.2 SQ.M.)