



Jubilee Lane, Wrecclesham, Farnham, Surrey

Price Guide £1,200,000

Jubilee Lane, Wrecclesham, Farnham, Surrey

A substantial four/five bedroom detached contemporary style property that has been extended and remodelled over recent years to create a spacious and versatile family home with over 3500sqft of accommodation on a wonderful elevated plot of approximately half an acre in a highly requested location to the south side of Farnham.

To the ground floor there is a large split level hallway with storage and access onto the rear garden. The impressive 23' living room has a 9'10" high ceiling and a fireplace with a fitted wood-burner. The 25' family room has stairs to the first floor and leads into the kitchen. The vaulted kitchen has been fitted with a range of cream 'shaker-style' units and breakfast bar with oak-block work surfaces, oak flooring, an integrated dishwasher, two stainless steel ovens, a ceramic hob and extractor. The 20' vaulted dining room is open to the kitchen, has a range of fitted cupboards and French doors onto the rear garden. The study would also make an ideal fifth bedroom as it has fitted wardrobes and there is a modern ground floor shower room adjacent to it. The large utility room has fitted cupboards and storage with a useful cloakroom and access into the pool room. The 21' pool room has an 'endless' swimming pool with adjustable current and leads into the studio/workshop that could also be converted into a gym.

To the first floor there are four large double bedrooms. The master is served by a 13' en-suite bathroom that has a freestanding bath, WC, washbasin and a walk-in shower. The 13' family bathroom is again fitted with a modern white four piece suite.

Outside the mature and private gardens are tiered to the front with a sweeping gravel driveway providing parking for several cars leading to the detached timber double width barn-style carport and steps to the front door. The secluded rear garden has a paved patio with a lawn area beyond enclosed by fencing and hedging with a wood store and storage shed.

- Four large double bedrooms
- Two bathrooms
- Ground floor shower room
- Study/bedroom five
- 23' Living room
- 25' Family room
- Re-fitted kitchen
- 20' Vaulted dining room
- Utility room
- Cloakroom
- Double glazing
- 15' Studio/workshop
- 21' Pool room with 'endless' swimming pool
- Detached double barn style carport
- Approximately half an acre gardens
- No onward chain



Floor Plan

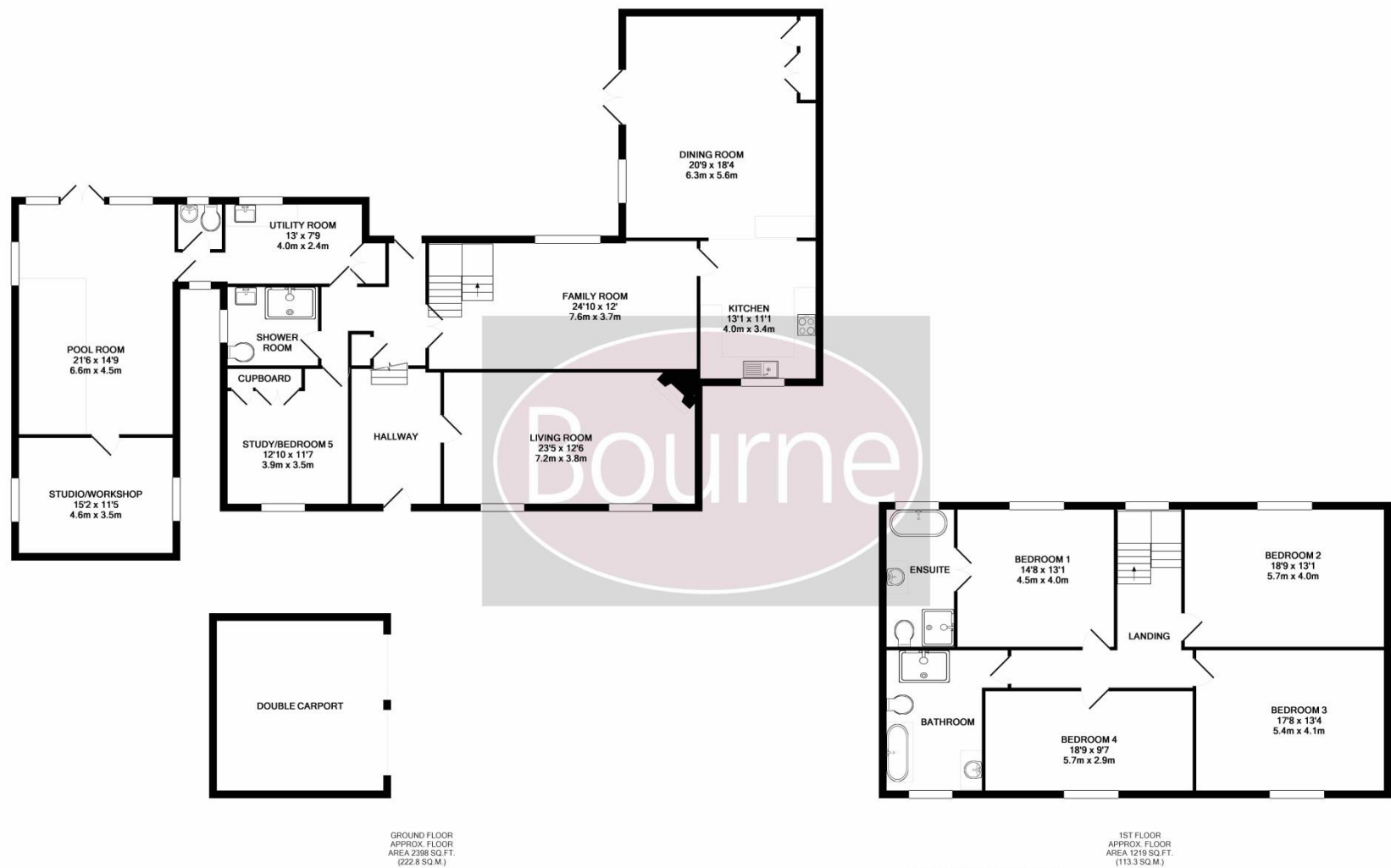

Location

Jubilee Lane is in a quiet location to the south of Farnham on the borders of Boundstone and Lower Bourne. There are local amenities and reputable schools close by and Farnham mainline station is approximately 1.7 miles

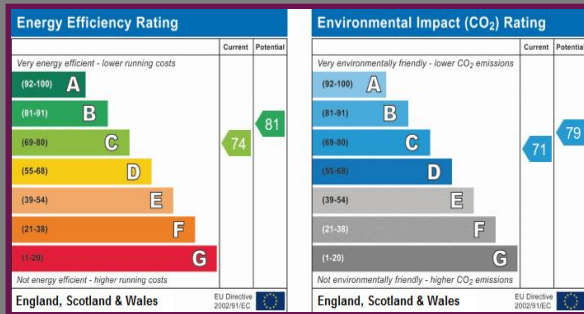
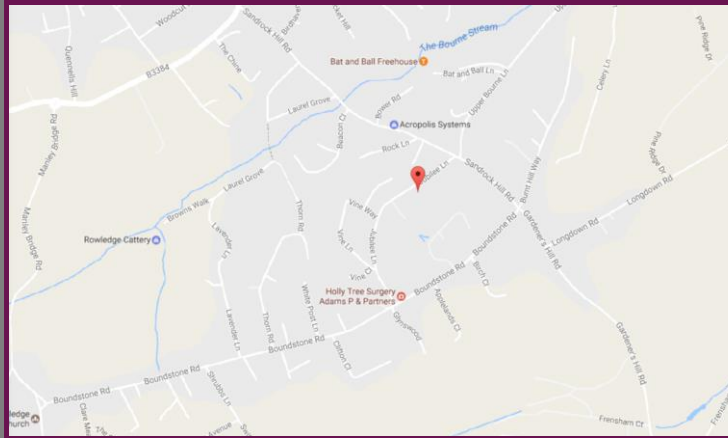

We aim to make our particulars both accurate and reliable but they are not guaranteed, nor do they form part of an offer or contract.

If you require clarification of any points then please contact us especially if you are travelling some distance to view.

Please note that appliances and heating systems have not been tested and therefore no warranties can be given as to their good working order.



A refreshing choice...

Farnham Office: 29 Downing Street, Farnham, Surrey, GU9 7PD

Sales: 01252 723 383 | **Lettings:** 01252 722 883 | **Web:** www.Bourneestateagents.com

Email: sales@bourneestateagents.com | **Lettings:** lettings@bourneestateagents.com