



Our Home Estates
Ruckholt Road, Leyton, E10 5QN
020 3815 7987
sales@ourhomeestates.co.uk
www.ourhomeestates.co.uk



Two bedroom House

Popular Walthamstow location

Modern built house

Parking on car port for one car

Sold chain free

Excellent transport links



47 Clifford Road
London, E17 4JE

Guide Price £425,000

Modern built two double bedroom terraced house with car port to the front. Fantastic location on a quieter street in a mainly residential area of Walthamstow. Open plan Lounge/Diner with separate Kitchen, two bathrooms and family garden makes this an excellent family property.

This property is in a popular residential area and is surrounded by great schools. Near the upper Walthamstow area of Walthamstow and close to Higham's park area. The property is a short stroll from the Wood street area with many local cafe's, restaurants and local trades shop. So, if you are looking for Picture framing, painting, mirrors or even some Antiques from the antique market then this is a wonderful place to visit.

Front

Modern built two-bedroom terraced house with car port at the front for one car.

Kitchen 9' 6" x 7' 3" (2.89m x 2.21m)

Spacious separate Kitchen with base and wall units along two walls, tiled floor and walls and double glazed window to the front. Modern fitted kitchen with light coloured units and marble effect worktop.

Lounge/Diner 15' 9" x 12' 5" (4.80m x 3.78m)

Open plan Lounge/Diner with laminate flooring and double glazed door leading directly to the garden.

Bedroom 1 15' 10" x 8' 9" (4.82m x 2.66m)

Double bedroom with laminate flooring and double glazed window to the rear overlooking the garden.

Bedroom 2 12' 2" x 8' 6" (3.71m x 2.59m)

Double bedroom also with laminate flooring and double glazed window.

Downstairs Toilet

Downstairs toilet situated under the stairs, includes WC and wash basin. Currently used as additional storage.

Family Bathroom 7' 2" x 6' 1" (2.18m x 1.85m)

Three-piece white suite including Bath, WC and sink, half tiled walls, radiator and lino flooring.

Garden

South East facing garden which is mainly lawn with paved area and shed to the side.

Ground Floor

Approx. 34.6 sq. metres (372.2 sq. feet)

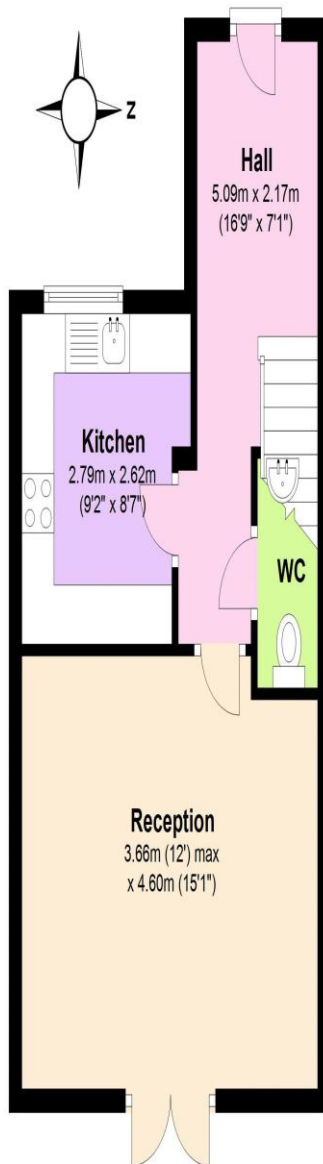

First Floor

Approx. 34.5 sq. metres (371.0 sq. feet)

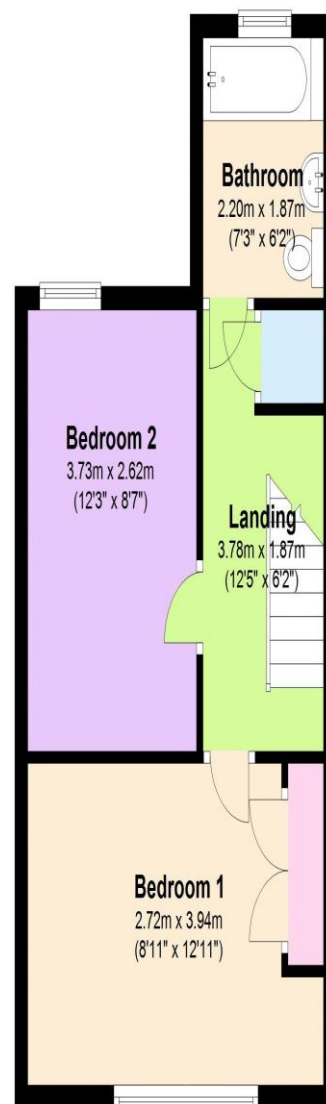

Total area: approx. 69.0 sq. metres (743.2 sq. feet)

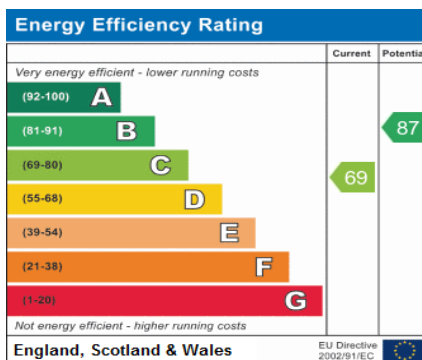

Reference:
Clifford road

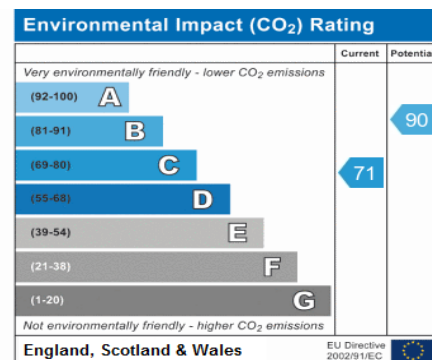

twitter.com/ourhomeestates



facebook.com/ourhomeestates



walthamforestpropertyblog.co.uk

