

# the floorplan...

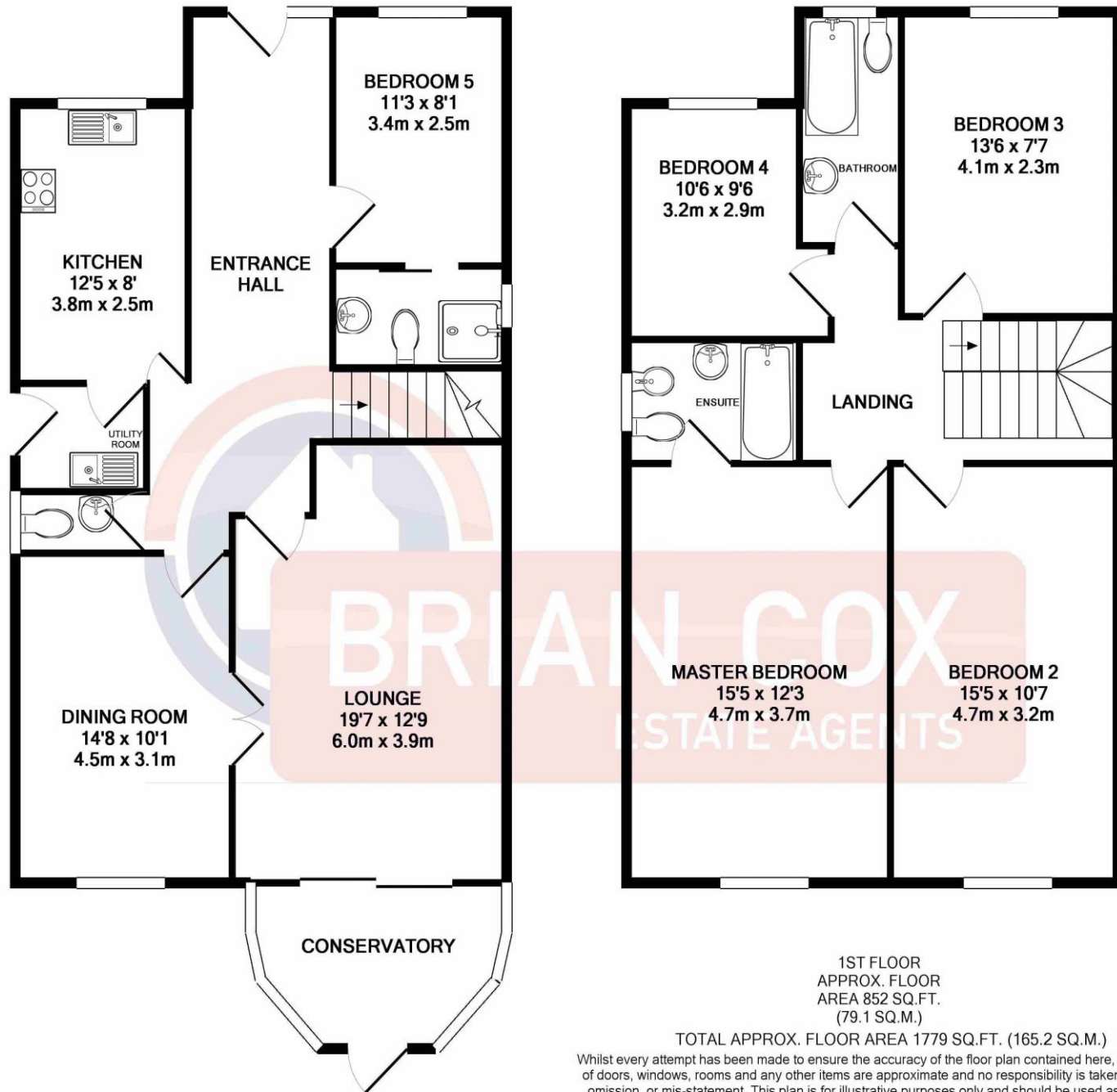

GROUND FLOOR  
APPROX. FLOOR  
AREA 927 SQ.FT.  
(86.1 SQ.M.)

1ST FLOOR  
APPROX. FLOOR  
AREA 852 SQ.FT.  
(79.1 SQ.M.)

TOTAL APPROX. FLOOR AREA 1779 SQ.FT. (165.2 SQ.M.)  
Whilst every attempt has been made to ensure the accuracy of the floor plan contained here, measurements of doors, windows, rooms and any other items are approximate and no responsibility is taken for any error, omission, or mis-statement. This plan is for illustrative purposes only and should be used as such by any prospective purchaser. The services, systems and appliances shown have not been tested and no guarantee as to their operability or efficiency can be given  
Made with Metropix ©2018

## more details from...

call: **Brian Cox Sudbury: 0208 422 1007**  
email: [steve.pusey@brian-cox.co.uk](mailto:steve.pusey@brian-cox.co.uk)  
web: [www.brian-cox.co.uk](http://www.brian-cox.co.uk)



0208 422 1007  
[brian-cox.co.uk](http://brian-cox.co.uk)



Located off the Harrow Road is this spacious Detached Five Bedroom Family home. Internally to the ground floor you will find a large lounge, dining room, Kitchen, utility room, guests WC, bedroom with en suite wet room and conservatory. To the first floor you will find a further four bedrooms with the master having the benefit of an en suite bathroom and also the family bathroom. Externally to the front you will find parking for a number of cars whilst to the rear a large family garden.



£975,000  
Freehold

Sudbury Hill Close, Wembley HA0 2QR



## in brief...

- Spacious
- Five Bedrooms
- Conservatory
- Off Street Parking
- Popular Road
- No Chain



## the location...

### nearest stations ...

- Sudbury Hill Harrow (0.4 miles)
- Sudbury Hill (0.5 miles)
- Sudbury & Harrow Road (0.7 miles)

Sudbury is a suburb in the London borough of Brent and Harrow, located in North West London, United Kingdom.

Sudbury is an historical area having once extended from the 'South Manor- Sudbury' (thought to have been on Harrow Hill) to the area that is now known as Wembley Central.

There are many local schools within walking distance from the property these include St George's Primary School, Horsenden Primary School, Wood End Academy and Wembley High Technology College.