

the floorplan...

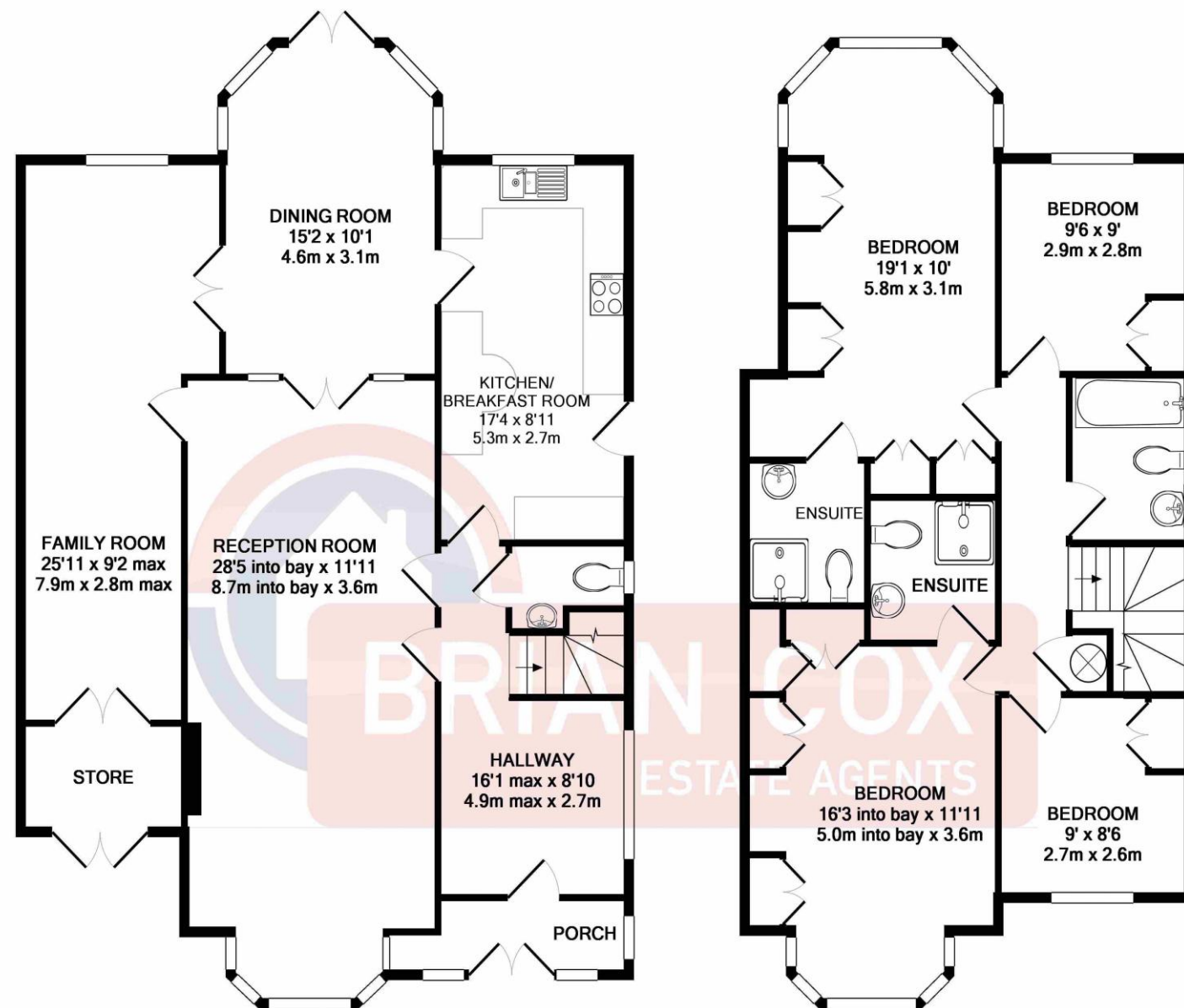

more details from...

call: Brian Cox Wembley: 0208 422 1007
email: steve.pusey@brian-cox.co.uk
web: www.brian-cox.co.uk



0208 422 1007
brian-cox.co.uk



Located on the highly popular Sudbury Court Drive is this extended four bedroom, four reception, and three bathroom family home. Internally the property offers spacious accommodation and also benefits from no further chain. Externally you will find a carriage driveway to the front and a family friendly well established garden to the rear.



£950,000

Freehold

Sudbury Court Drive, Harrow HA1 3SZ

Consumer Protection from Unfair Trading Regulations 2008 We have not tested any apparatus, equipment, fixtures, fittings or services and so cannot verify that they are in working order or fit for purpose. You are advised to obtain verification from your solicitor or surveyor. References to the tenure of a property are based on information supplied by the seller. We have not had sight of the title documents and a buyer is advised to obtain verification from their solicitor. Items shown in photographs are not included unless specifically mentioned within the sales particulars, but may be available by separate negotiation. We advise you to book an appointment to view before embarking on any journey to see a property, and check its availability.



in brief...

- Four Bedrooms
- Four Receptions
- Three Bathrooms
- Detached
- No Chain
- Ample Parking



the location...

nearest stations ...

South Kenton Underground- Bakerloo Line (0.6 miles)
 South Kenton Overground (0.6 miles)
 Northwick Park - Metropolitan Line (0.7 miles)
 Sudbury Hill - Piccadilly Line (1.0 mile)

Harrow is a large suburban town in the London Borough of Harrow, North West London, England. It is centred 10.5 miles (16.9 km) North West of Charing Cross.

Harrow has two large shopping centres which are St Anns and St Georges with its many large department stores, restaurants, cafes and cinema.

There are many local schools within close proximity of the property some of these include Byron Court Primary School, St George's Primary School, Wembley High Technology College, St Anselm's Catholic Primary School and John Lyon School.