

HOME OF DISTINCTION



Milford on Sea





Westover Road, Milford on Sea, Hampshire, SO41 0PW Address

A STUNNING GRADE II LISTED TOWN HOUSE WITHIN
GATED DEVELOPMENT OFFERING SUPERB SEA &
COASTAL VIEWS

- Lounge with Balcony • Modern Kitchen
- 2 Double Bedrooms • En-Suite & Modern Bathroom
- Balcony & 2 Terraces • Gas Central Heating
- Double Glazing • Garage • Direct Access To Beach

(ref:817508)

£699,000

Energy Efficiency Rating		Current	Potential
Very energy efficient - lower running costs			
(92-100)	A		
(81-91)	B		86
(69-80)	C		70
(55-68)	D		
(39-54)	E		
(21-38)	F		
(1-20)	G		
Not energy efficient - higher running costs			
England, Scotland & Wales		EU Directive 2002/91/EC	

Milford on Sea is a coastal village with a range of shops, restaurants and other amenities around the village green. Bournemouth & Southampton are both approximately 18 miles away whilst rail links from New Milton are within 4 miles.

The White House was designed by Romaine Walker, a renowned Victorian architect, for the Walker-Munro family, who built it as a summer home in circa 1905. The property was sympathetically converted in 1999 to a high standard and enjoys uninterrupted views of Christchurch Bay from the Isle of Wight to Swanage Bay. The property is situated on the seafront with direct access to promenade adjacent to Westover Beach.

The property is approached via double gates leading up a sweeping driveway to the property. Front door into entrance hall with a storage and airing cupboard. The two double bedrooms are both found on the ground floor with both having direct access onto a private terrace as well as built in wardrobes. Bedroom 1 also has an en-suite shower room which comprises a large shower cubicle, vanity wash hand basin, wc, heated towel rail and mirror with light. The bathroom is also found on the ground floor and again comprises a bath with tiled splashback, vanity wash hand basin with mirror over, wc and heated towel rail.

The stairs lead up to the first floor landing, the good sized bright and airy lounge which has oak flooring and room for sofas and dining furniture, two sets of doors lead onto the south westerly aspect balcony which offers unrivalled sea and coastal views. The modern kitchen has working surfaces over cupboards and drawers with matching wall mounted cupboards. There are integrated appliance including double oven and microwave, five ring gas hob with extractor hood over, dishwasher, washing machine and fridge/freezer. The rear window overlooks the communal grounds and towards Hurst Castle.

Outside, the property is situated in extensive well maintained communal grounds with brick boundaries. There are garage of which one is conveyed with the property and further parking spaces available. From the rear of the grounds, private steps and a gate lead onto the Westover Beach promenade and beach. The grounds also offer stunning sea views across the bay and towards the Isle of Wight and the Needles

Viewing of this property is strongly advised to appreciate the condition and views on offer

Lounge

6.55m (21'6) x 4.14m (13'7) narrowing to 3.50m (11'5)

Kitchen

4.46m (14'8) x 2.36m (7'9)

Bedroom 1

4.1m (13'5) x 2.98m (9'9)

En-Suite

1.99m (6'6) x 1.36m (4'6)

Bedroom 2

3.21m (10'6) x 2.82m (9'3)

Bathroom

2.03m (6'8) x 1.73m (5'8)







Brochure prepared by Neil Betts

SOUTHBOURNE

31 Southbourne Grove,
Southbourne, Dorset, BH6 3QT

t: 01202 434300

e: southbourne@goadsby.com



PLEASE NOTE Measurements quoted are approximate and for guidance only. Fixtures, fittings, services & appliances have not been tested and therefore no guarantee can be given that they are in working order. Images have been produced for information and it cannot be inferred that any item shown is included with the property. These particulars are believed to be correct but their accuracy is not guaranteed and they do not constitute an offer or form part of a contract. Solicitors are specifically requested to verify the sales particulars details in the pre-contract enquiries, in particular: price, local and other searches.

Goadsby & Harding (Residential) Ltd Registered Office: 99 Holdenhurst Road, Bournemouth, Dorset BH8 8DY Registered in England No. 1871280

G344 Printed by Ravensworth 01670 713330



GROUND FLOOR

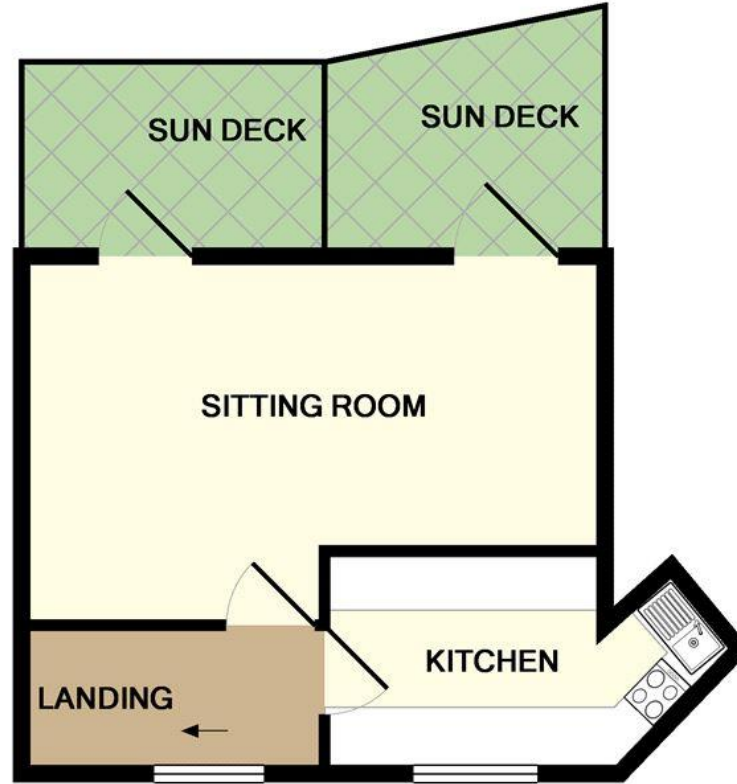

1ST FLOOR



This Floor Plan is for guidance only and is NOT to SCALE
 Made with Metropix ©2017

