

# HIGHCLIFFE ON SEA

£400,000





# HIGHCLIFFE ON SEA

A delightful detached bungalow situated in this pretty position with gorgeous gardens through which flows the ornamental stream. Situated just off the high street with accommodation totalling 900sqft and just a short stroll to the shops and beach, this thoroughly refurbished bungalow is ready to move into straight away.

THREE BEDROOMS • BATHROOM • KITCHEN/DINING ROOM • SITTING ROOM • CONSERVATORY • GARDENS • OFF-ROAD PARKING • GARAGE •



## The Property

- First class detached bungalow of approximately 900sqft
- Fabulous plot and position with colourful gardens and the ornamental stream running through it
- Three bedrooms
- Brand new refitted bathroom with attractive tiling
- Superb open plan living accommodation with kitchen/dining/living room
- Quality upvc conservatory extension
- Recently redecorated, newly fitted carpets, flat plastered ceilings
- Gas fired central heating and upvc double glazed windows
- Substantial driveway with plenty of parking
- Detached garaging
- Convenient position just a short walk to the village and the beach
- Vacant possession
- Council Tax 'D' £1787.03
- EPC 'D'





## Location

Highcliffe is a small town in the borough of Christchurch, Dorset. The town lies on a picturesque stretch of Solent coastline with views over Christchurch Bay to the Isle of Wight. Fueled by its enviable location, coastal walks, main line rail links to London (in under two hours) excellent schools and the popularity of the Chewton Glen Hotel, the Highcliffe Golf Course, and the Nature Reserve at Steamer Point, Highcliffe is becoming a popular area for those relocating to the coast.

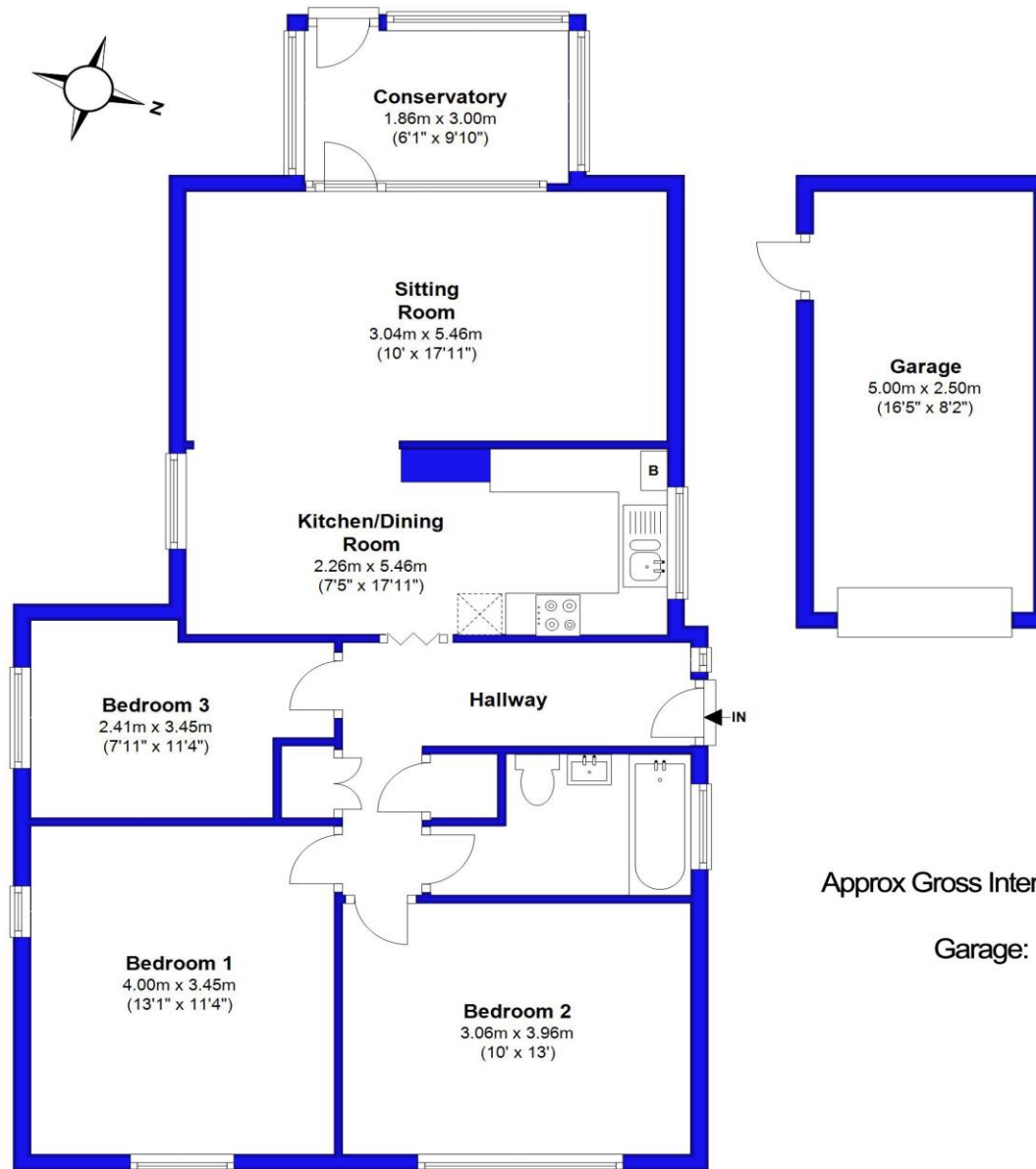

Approx Gross Internal Area: 83.1 sqm / 894.3 sqft

Garage: 12.5 sqm / 134.5 sqft

Illustration for identification purposes only; measurements are approximate, not to scale.  
Plan produced using PlanUp.





273 Lymington Road, Highcliffe, Christchurch, BH23 5EB [highcliffe@mitchells-estateagents.co.uk](mailto:highcliffe@mitchells-estateagents.co.uk)

01425 272206

[mitchells.uk.com](http://mitchells.uk.com)