



Connells

Chapel Road
Breachwood Green Hitchin



Property Description

A rare opportunity to wake up in a truly stunning surrounding. This beautifully extended 4 bedroom property, formally the Parish Manse, is the perfect family home. Located in the pretty village of Breachwood Green, it has a self-contained annexe which includes its own kitchen and shower room, and would be perfect for independent teenagers or perhaps elderly parents! This idyllic dwelling captures the most wonderful views especially from the master bedroom and main reception room.

This truly magnificent detached 1930's home has been thoughtfully extended over time, now offering over 2900 sq ft of living space all bathed in light from the attractive feature windows. This really is a house to fall in love with! As well as enjoying its rural pleasures, it is conveniently close to Harpenden and Luton giving excellent access to London and the North.



Entrance Hall

Radiator. Door to front.

Study

13' x 8' 7" (3.96m x 2.62m)
Sky light.

Lounge

18' 6" x 14' (5.64m x 4.27m)
Open fireplace. Radiator. Double glazed window to front.

Dining Room

14' x 12' (4.27m x 3.66m)
Double glazed patio doors. Radiator. Double glazed window to side.

Kitchen/ Breakfast Room

20' 3" x 9' 11" (6.17m x 3.02m)
Fitted kitchen with wall and base units. Sink and drainer. Work surfaces. Electric oven and hob. Cookerhood. Dishwasher. Double glazed windows to front and rear.

Utility Room

Wall and base units. Cupboards. Dishwasher.

First Floor

Bedroom 1

14' x 12' (4.27m x 3.66m)
Double glazed window to side and rear. Fitted wardrobes and en suite shower room with shower cubicle, wash hand basin and low level WC.

Bedroom 2

15' 1" x 14' 1" (4.60m x 4.29m)
Fitted wardrobe. Double glazed bay window to front.

Bedroom 3

10' 3" x 10' (3.12m x 3.05m)

Fitted wardrobes. Double glazed window to front.

Bathroom

Luxury, spacious bathroom with bath, shower cubicle, wash hand basin and low level WC. Windows to rear.

Second Floor

Loft Room/ Bedroom 4

13' 5" x 11' 3" (4.09m x 3.43m)

Eves storage. Skylight.

Second Loft Room

9' 11" x 7' 1" (3.02m x 2.16m)

Eves storage. Skylight.

Annexe

Self contained annexe with kitchen/diner, lounge, bedroom and shower room.

Outside

Garage

Parking

Shingle driveway with parking for numerous cars.

Rear Garden

Superb rear garden mainly laid to lawn with mature trees and stunning Countryside views over the fields.







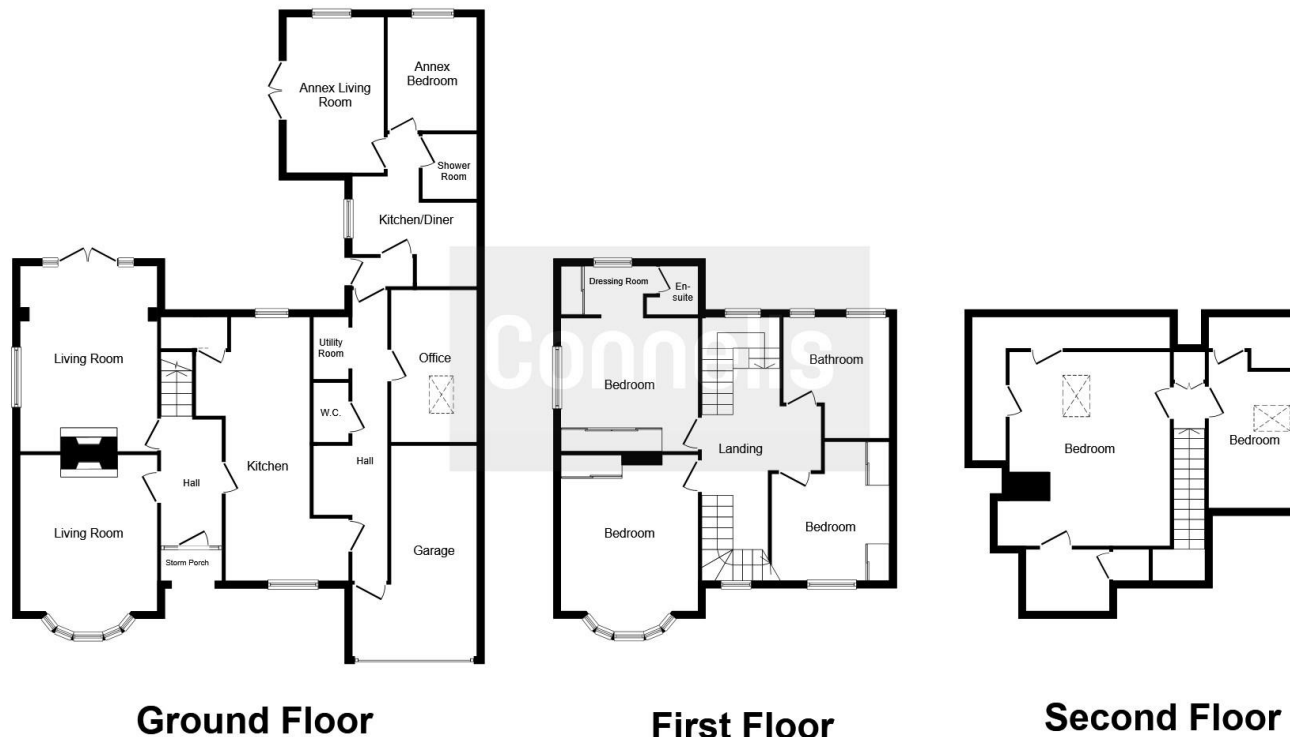

This plan is for illustration purposes only and may not be representative of the property. Plan not to scale.

Powered by audioagent.com

To view this property please contact Connells on

T 01582 760 131
E harpenden@connells.co.uk

50 High Street
 HARPENDEN AL5 2SU

EPC Rating: E

view this property online connells.co.uk/Property/ref-HPN304683

Tenure: Freehold



ON THIS PROPERTY

When you use our mortgage and conveyancing service. Subject to terms & conditions. Please ask for our leaflet



1. MONEY LAUNDERING REGULATIONS Intending purchasers will be asked to produce identification documentation at a later stage and we would ask for your co-operation in order that there will be no delay in agreeing the sale. 2. These particulars do not constitute part or all of an offer or contract. 3. The measurements indicated are supplied for guidance only and as such must be considered incorrect. Potential buyers are advised to recheck measurements before committing to any expense. 4. We have not tested any apparatus, equipment, fixtures, fittings or services and it is in the buyers interest to check the working condition of any appliances.

See all our properties at www.connells.co.uk | www.rightmove.co.uk | www.zoopla.co.uk

Property Ref: HPN304683 - 0010