



Hillview, London, SW20 0TA



£995,000

Four Bedrooms  
Two Reception Rooms  
Kitchen / Dining Room  
Over 1400 Sq Ft  
Arranged Over 3 Floors  
Stunning Bathroom  
South Facing Garden  
No Chain

This four bedroom family home is situated in a highly sought after road within walking distance of Raynes Park mainline station.

Accommodation is arranged over three floors, with a high specification, spacious kitchen / dining room on the lower ground floor with sliding doors to the garden, and two reception rooms at ground floor level, including a 19ft study and a 17ft lounge to the rear.

The top floor offers four sensibly proportioned bedrooms and a stunning shower room which has recently been refitted to the highest standards. There is a matching downstairs w/c at ground floor level.



To the front of the property is a pleasant front garden and a driveway. Gated side access leads to a 40ft, fully fence enclosed, South facing garden.

Internal inspection highly recommended. No chain, key with agent.

Hillview is a pleasant residential road convenient for Wimbledon Village, the Common and both Raynes Park mainline station with the Waitrose there and Wimbledon mainline and Tube stations, via the 200 bus along Ridgway. The A3 offers excellent access to both central London and the A3/M25 networks to both Gatwick and Heathrow Airports. There are many excellent schools locally both in the State and Private sectors and plenty of leisure facilities including sports and tennis clubs, golf courses/clubs and riding stables.







## Hillview

Approximate Gross Internal Area = 128.5 sq m / 1383 sq ft

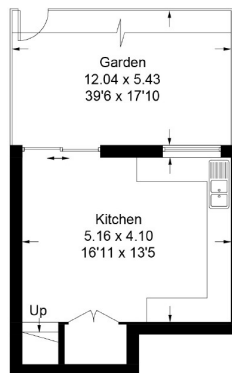

**Lower Ground Floor**

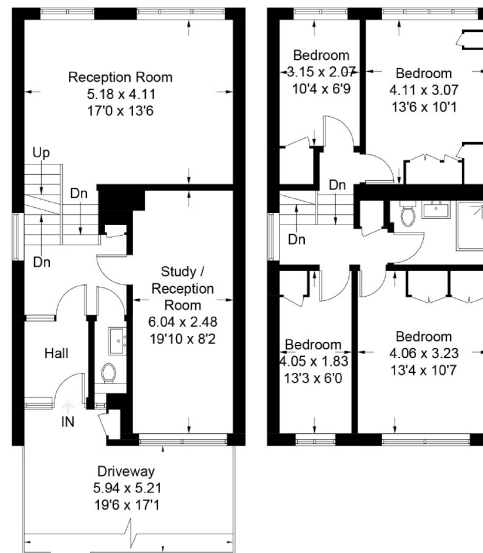

**Ground Floor**

**First Floor**

Illustration for identification purposes only, measurements are approximate, not to scale. FloorplansUsketch.com © 2017 (ID 384765)

Please Note: Whilst every attempt has been made to ensure the accuracy of the floorplans contained here, measurements of doors, windows and room areas are approximate and no responsibility is taken for any error, omission or mis-statement. These plans are for representation purposes only and should be used as such by and prospective purchaser. The services, systems and appliances listed in the specification have not been tested by The Personal Agent and no guarantee as to their operating ability or their efficiency can be given. All images and text used to advertise our properties are for the sole use of The Personal Agent Ltd.

2 West Street, Epsom, Surrey, KT18 7RG, England

Tel: 01372 745850

Email: [richard@thepersonalagent.co.uk](mailto:richard@thepersonalagent.co.uk)

[www.thepersonalagent.co.uk](http://www.thepersonalagent.co.uk)





