



Green Lane, Goodmayes, Essex **Guide £625,000**



YOUR MOVE
— Glenwood —





Green Lane, Goodmayes,
Essex

Guide £625,000

Property Description

GUIDE PRICE £625,000- £685,000. Your Move Glenwood estate agents are pleased to offer for sale this five bedroom semi-detached house in Goodmayes. The property comprises: two reception rooms, kitchen/diner, ground floor shower room/WC, three bedrooms to the first floor and two bedrooms to the second floor, a first floor bathroom/WC, and a second floor shower room/WC. The property also benefits from off street parking, approximately 50ft rear garden, and an outbuilding. EPC Rating- D.

Our View

In our opinion the property will appeal to buy-to-let investors and families.

Location

The property is located within 0.3 miles of Goodmayes Train Station (which is part of the Crossrail project) and within 0.1 miles of Goodmayes Road shopping amenities.



Semi-detached House
For full EPC please contact the branch

Approximate Gross Internal Area = 168.2 sq m / 1810 sq ft (Excluding Eaves Storage)
 Outbuilding = 38.9 sq m / 419 sq ft
 Total = 207.1 sq m / 2229 sq ft

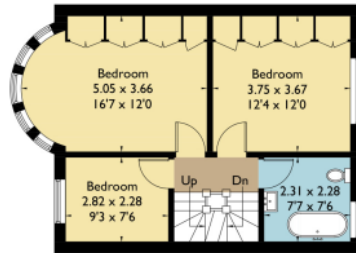

First Floor

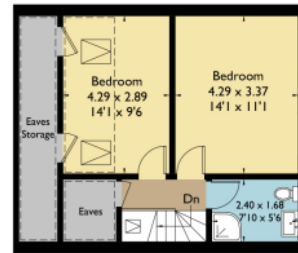

Second Floor

= Reduced headroom below 1.5m / 5'0

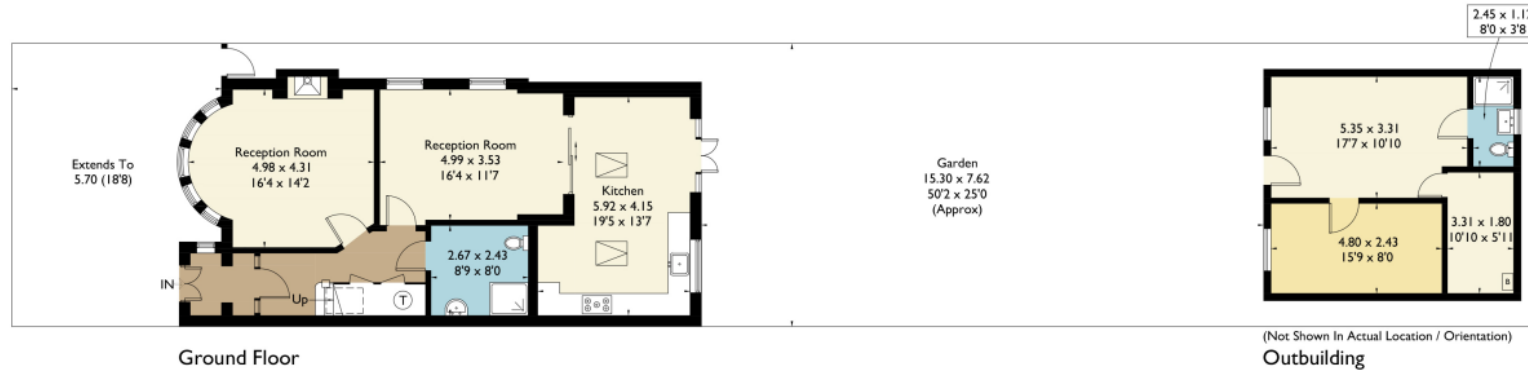

Ground Floor

(Not Shown In Actual Location / Orientation)
 Outbuilding

FLOORPLANZ © 2018 0203 9056099 Ref: 209113

This plan is for layout guidance only. Drawn in accordance with RICS guidelines. Not drawn to scale unless stated. Windows & door openings are approximate. Whilst every care is taken in the preparation of this plan, please check all dimensions, shapes & compass bearings before making any decisions reliant upon them.

IMPORTANT NOTE TO PURCHASERS: We endeavour to make our sales particulars accurate and reliable, however, they do not constitute or form part of an offer or any contract and none is to be relied upon as statements of representation or fact. The services, systems and appliances listed in this specification have not been tested by us and no guarantee as to their operating ability or efficiency is given. All measurements have been taken as guide to prospective buyers only, and are not precise. Floor plans where included are not to scale and accuracy is not guaranteed. If you require clarification or further information on any points, please contact us, especially if you are travelling some distance to view. Fixtures and fittings other than those mentioned are to be agreed with the seller.

Our team of highly qualified Mortgage & Financial Consultants can provide you with up to the minute information on many of the rates available. To arrange an appointment, telephone this office. **YOUR HOME MAY BE REPOSSESSED IF YOU DO NOT KEEP UP REPAYMENTS**

YOUR MOVE Glenwood is the trading name of Glenwood Estate Agents Limited, registered company number 5390435, registered office 35 High Road, Chadwell Heath, Essex, RM6 6QJ. YOUR MOVE Glenwood is an independently owned and operated business, operated under licence from your-move.co.uk Limited.

35 High Road, Chadwell Heath, Romford, RM6 6QJ

0208 983 8449 * chadwellheath@your-move.co.uk

*Calls may be recorded and/or monitored for training and/or security purposes.

