

Chatsworth Road, NW2

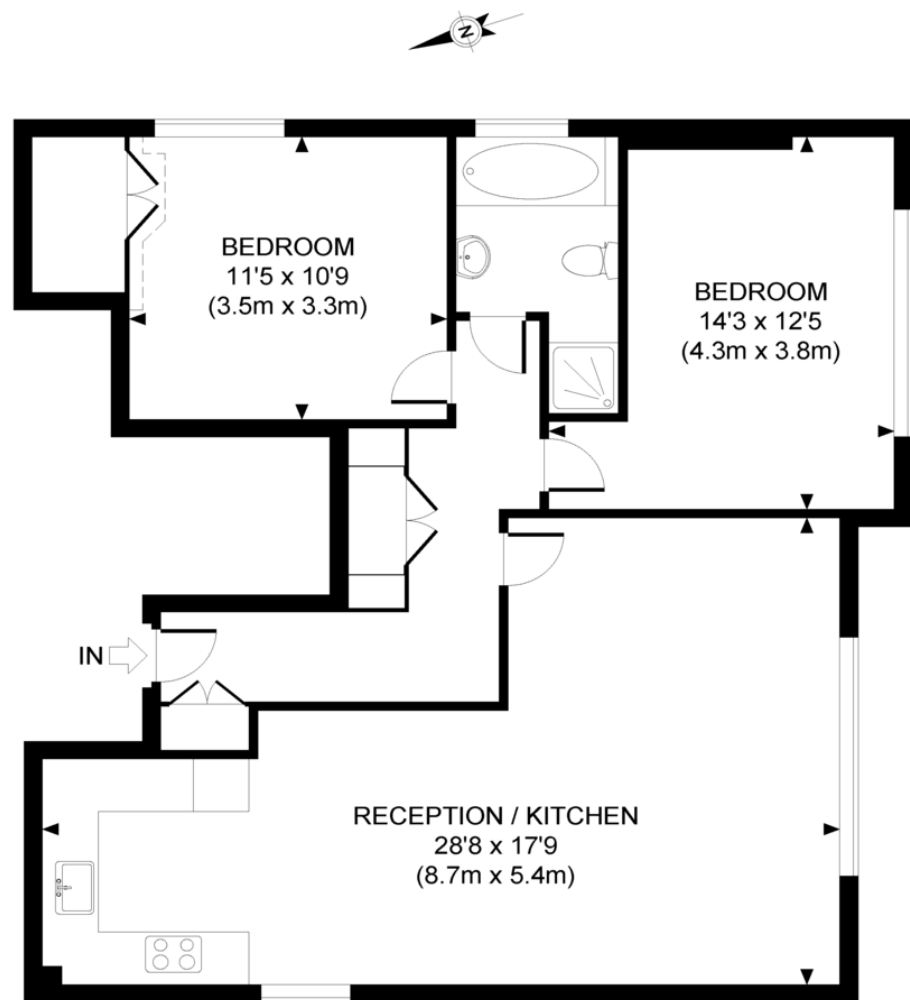

FIRST FLOOR

APPROXIMATE GROSS INTERNAL AREA 835 SQ FT / 77.6 SQ M

Whilst every attempt has been made to ensure the accuracy of this floor plan, measurements of door, windows, rooms and all other items are approximate. No responsibility is taken for any error, omission or mis-statement. This floor plan is for illustrative purposes only, and should be treated as such.



## Chatsworth Road, London, NW2 4DG

£675,000 Leasehold

### Key Features

- Lovely First Floor Flat
- Two Double Bedrooms
- Bright L Shaped Open Plan Kitchen/Reception
- Stylish Fully Tiled Bathroom
- Wooden Flooring Throughout
- Integrated Appliances
- Communal Garden
- 

### Description

Stunning two bedroom first floor apartment set within this imposing detached house. The property benefits from an bright L shaped open plan kitchen/reception with integrated appliances, two double bedrooms with the master bedroom fitted with wardrobes, stylish fully tiled bathroom, wooden flooring throughout, communal rear garden. Located in the ever so popular Mapesbury Conservation area, conveniently close to a variety of social aspects on Kilburn High Road or Walm Lane. Well connected to all public transport routes, a short walk to Kilburn or Willesden Green Station (Jubilee Line) & Brondesbury Park (London Overground).

