

## Chatsworth Road, NW2

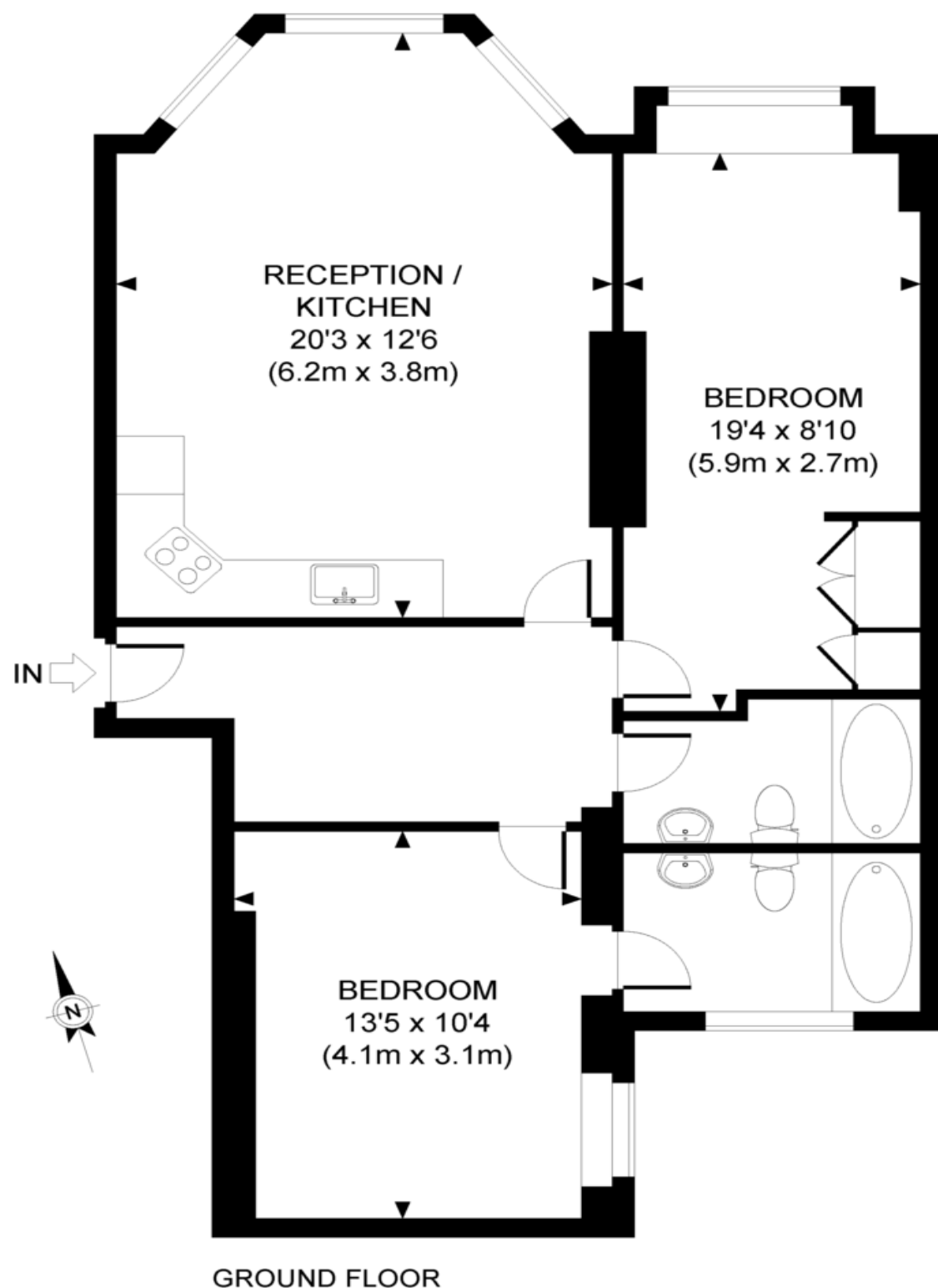

APPROXIMATE GROSS INTERNAL AREA 805 SQ FT / 74.8 SQ M

Whilst every attempt has been made to ensure the accuracy of this floor plan; measurements of door, windows, rooms and all other items are approximate. No responsibility is taken for any error, omission or mis-statement. This floor plan is for illustrative purposes only, and should be treated as such.



## Chatsworth Road, London, NW2 4DG

£675,000 Leasehold

### Key Features

- Stunning First Floor Flat
- Two Double Bedrooms
- Open Plan Kitchen/Reception Room
- Modern Fitted Kitchen With Integrated Appliances
- Modern Fully Tiled Bathrooms
- Beautiful Communal Rear Garden
- Newly Refurbished

### Description

Set within this imposing detached house is this newly refurbished first floor two bedroom apartment. The property benefits from an open plan kitchen/reception with integrated appliances, two double bedrooms one with an en-suite bathroom and the other with fitted wardrobes, modern fully tiled bathroom, beautiful communal rear garden. Situated in the Mapesbury Conservation area, conveniently close to a variety of social aspects on Kilburn High Road or Walm Lane. Well connected to all public transport routes, a short walk to Kilburn or Willesden Green Station (Jubilee Line) & Brondesbury Park (London Overground).

