

# the floorplan...

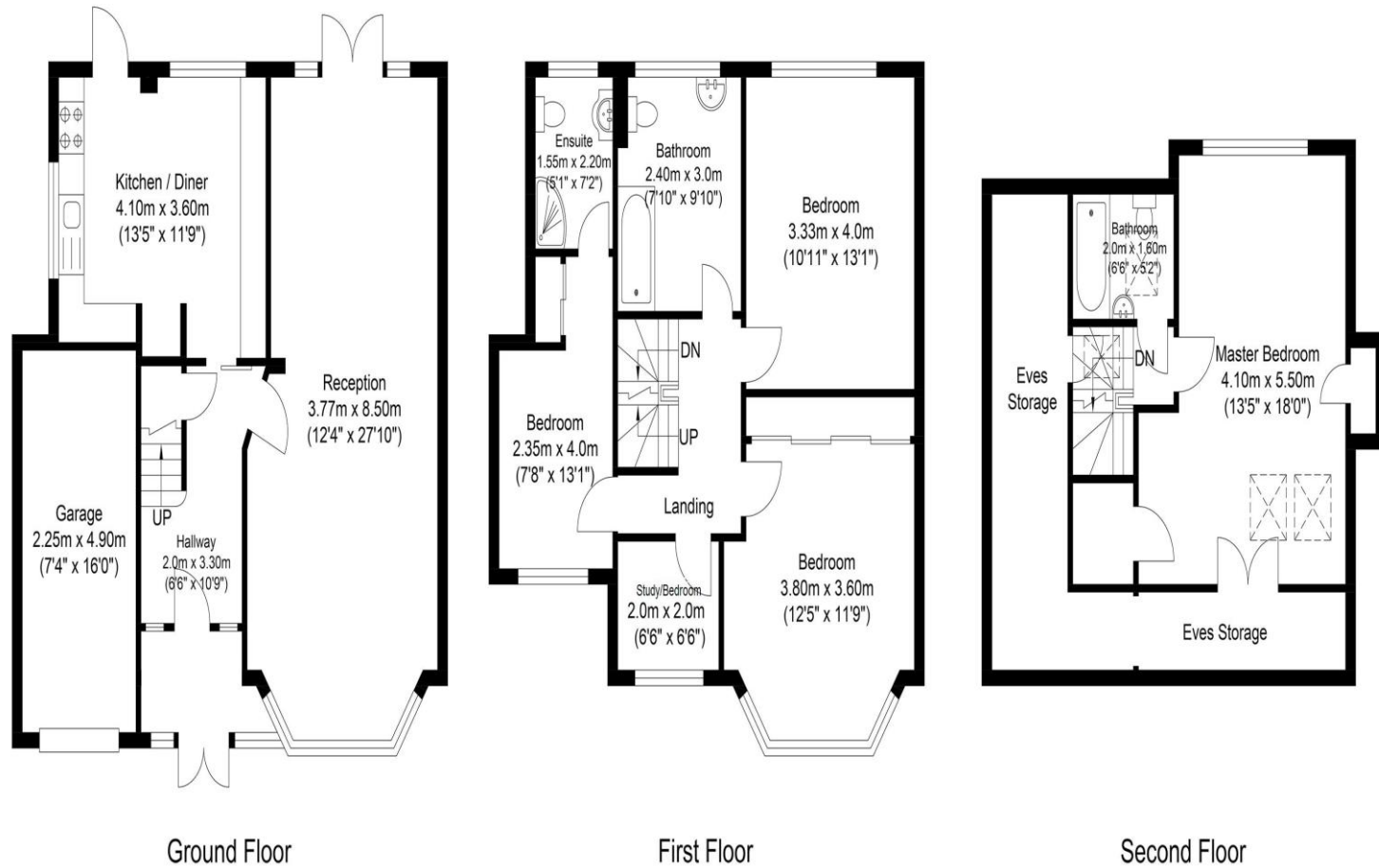

Approx Gross Internal Floor Area (Inc. Garage): 170.50 sq. m. (1835.24 sq. ft.)



## more details from...

call: **Brian Cox North Harrow: 020 3866 6640**  
email: [paul.budd@brian-cox.co.uk](mailto:paul.budd@brian-cox.co.uk)  
web: [www.brian-cox.co.uk](http://www.brian-cox.co.uk)



Consumer Protection from Unfair Trading Regulations 2008 We have not tested any apparatus, equipment, fixtures, fittings or services and so cannot verify that they are in working order or fit for purpose. You are advised to obtain verification from your solicitor or surveyor. References to the tenure of a property are based on information supplied by the seller. We have not had sight of the title documents and a buyer is advised to obtain verification from their solicitor. Items shown in photographs are not included unless specifically mentioned within the sales particulars, but may be available by separate negotiation. We advise you to book an appointment to view before embarking on any journey to see a property, and check its availability.



0203 866 6640  
[brian-cox.co.uk](http://brian-cox.co.uk)



This immaculately presented five bedroom, three bathroom semi detached property enters the market with Brian Cox Estate Agents. The property is situated close to shopping facilities, sought after schools and transportation links. Accommodation: porch, entrance hallway, lounge/dining room, fitted kitchen/breakfast, five good sized bedrooms, en suite shower room and family bathroom. Further benefits include gas central heating, double glazing, integral garage and a delightful 90ft rear garden.



£875,000  
Freehold

Anglesmede Crescent, Pinner HA5 5SP



### in brief...

- Five Bedrooms
- Three Bathrooms
- Exceptionally Well Presented
- Premier Road
- Sought After Schools
- Delightful 90ft Garden



### the location...

#### nearest stations ...

- North Harrow (0.5 miles)
- Hatch End (1 miles)
- Pinner (0.7 miles)



Anglesmead Crescent is situated in a suburban area of North West London within the London Borough of Harrow. Pinner Station runs along the Metropolitan Line and is easy to reach Baker Street and Kings Cross Stations. The area is served well by local amenities including a post office, Tesco Express, a selection of restaurants, take-aways & cafés and independent specialist shops. There are several schools in the area including the sought after Nower Hill & Pinner Park School.

