

the floorplan...

160 Headstone Lane, Harrow  
Approximate Gross Internal Area  
202 Sq M/2181 Sq Ft

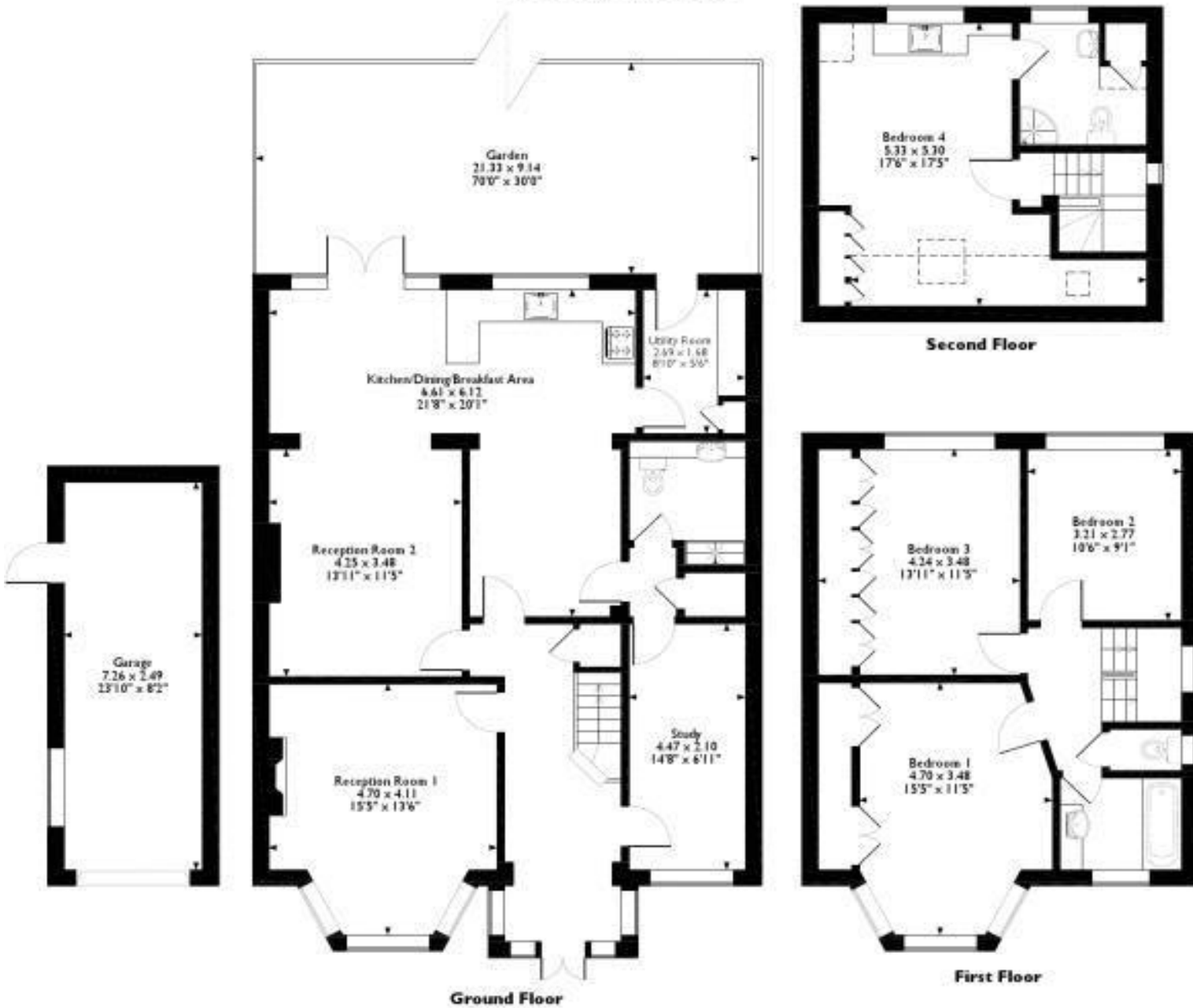

more details from...

call: **Brian Cox North Harrow: 020 3866 6640**  
email: [paul.budd@brian-cox.co.uk](mailto:paul.budd@brian-cox.co.uk)  
web: [www.brian-cox.co.uk](http://www.brian-cox.co.uk)



Consumer Protection from Unfair Trading Regulations 2008 We have not tested any apparatus, equipment, fixtures, fittings or services and so cannot verify that they are in working order or fit for purpose. You are advised to obtain verification from your solicitor or surveyor. References to the tenure of a property are based on information supplied by the seller. We have not had sight of the title documents and a buyer is advised to obtain verification from their solicitor. Items shown in photographs are not included unless specifically mentioned within the sales particulars, but may be available by separate negotiation. We advise you to book an appointment to view before embarking on any journey to see a property, and check its availability.



0203 866 6640  
[brian-cox.co.uk](http://brian-cox.co.uk)



This exceptionally spacious four bedroom, three bathroom semi detached property enters the market with Brian Cox Estate Agents. The property is situated close to shopping facilities, Headstone lane mainline train station and within walking distance to Pinner Park School. Accommodation: porch Entrance hallway, spacious lounge, fitted kitchen open plan to sitting room, utility room, downstairs bathroom and study. Further benefits include gas central heating, double glazing, detached garage, own drive, delightful 90ft rear garden and spectacular views over green fields to the rear of the property.



£725,000  
Freehold

Headstone Lane, North Harrow HA2 6JT



## in brief...

- Four Bedrooms
- Three Bathrooms
- Pinner Park Catchment
- Well Presented Accommodation
- Stunning Views to the Rear
- Delightful 90ft Garden



## the location...

### nearest stations ...

Headstone (0.3 miles) North Harrow (0.5 miles) West Harrow (0.8 miles) North Harrow is a suburban area of North West London, situated north-west of central Harrow within the London Borough of Harrow. North Harrow train station is a London Underground station situated in North Harrow in North West London. The station is on the Metropolitan line between Harrow-on-the-Hill (southbound) and Pinner (northbound). The area is served well by local amenities including a post office, Tesco Express, a selection of restaurants, take-aways & cafes and independent specialist shops. There are several schools in the area and churches.

