



 RAMPTON
BASELEY

Earlsfield Road | SW18
Freehold



Description

This fantastic five-bedroom family house offers approximately 2151 sq ft of accommodation split over three levels. The property is presented well throughout with good proportions in all the principal rooms.

A superb double reception room is positioned at the front of the property on the ground floor. The reception room boasts Brazilian hard wooden flooring, twin feature fireplaces and bay windows. The rear part of the reception room leads into a wonderful kitchen / dining room, which is a fantastic space for entertaining as well as every day family living. The kitchen itself is a Neptune design and is of exceptional quality, benefiting from wall and base units, modern integrated appliances and granite work surfaces. Double doors open out onto a pretty landscaped garden that has lighting and a watering system installed as well as a pizza oven. At the bottom of the garden there is a studio, which is currently being used as a workshop. It is an excellent additional space that could serve a multitude of purposes.

Three double bedrooms (all benefitting from Brazilian wooden flooring) and a family bathroom can be found on the first floor with a further two double bedrooms and a second family bathroom arranged over the second floor.

In addition, the property offers off-street parking and additional storage is available in the cellar.



- Five double bedrooms
- Two bathrooms
- Kitchen/ Dining room
- Double reception room
- Ground floor WC
- Garden
- Studio
- Cellar
- Off street parking
- High speed WIFI throughout

This charming house is located on Earlsfield Road, with the amenities of Northcote Road and Bellevue Road both within easy walking distance. The open spaces of Wandsworth Common are also just minutes away. There are a number of good state and private schools nearby, subject to catchment and entry each year.





30 Bellevue Road, London, SW17 7EF
 T 020 3846 0999
 E wandsworthsales@ramptonbaseley.com
 www.ramptonbaseley.com

**EARLSFIELD ROAD
 WANDSWORTH
 LONDON SW18**



APPROXIMATE INTERNAL FLOOR (LIVING) AREA
 ■■■■ = 2151 SQ.FT. / 199.8 SQ.M.

APPROXIMATE ADDITIONAL AREAS
 XXXX = 200 SQ.FT. / 18.6 SQ.M.

**TOTAL AREAS SHOWN ON PLAN
 2351 SQ.FT. / 218.4 SQ.M.**

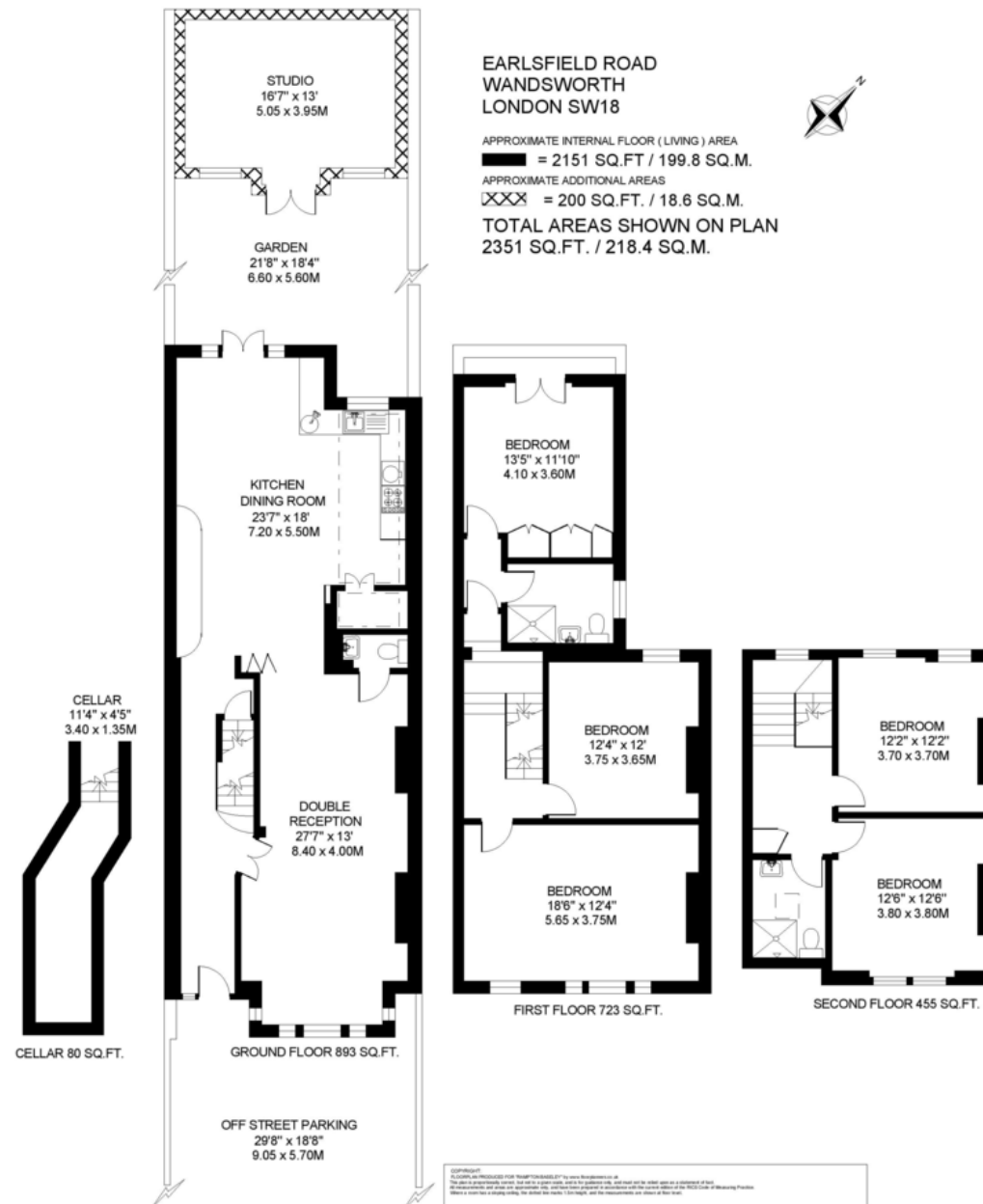

DISCLAIMER
 ALL DIMENSIONS ARE APPROXIMATE FOR INFORMATION ONLY. THE AGENT HAS NOT CONDUCTED A SURVEY OF THE PROPERTY AND DOES NOT GUARANTEE THE ACCURACY OF THE DIMENSIONS. THE AGENT HAS NOT CONDUCTED A SURVEY OF THE PROPERTY AND DOES NOT GUARANTEE THE ACCURACY OF THE DIMENSIONS. THE AGENT HAS NOT CONDUCTED A SURVEY OF THE PROPERTY AND DOES NOT GUARANTEE THE ACCURACY OF THE DIMENSIONS.

