

FREDERICK STREET

KING'S CROSS • WC1X





FREDERICK STREET

KING'S CROSS • WC1X

A stunning Grade II listed house settled over five floors in the heart of King's Cross

Set over five levels the house has been re-furbished with beautiful contemporary finishes. There is a wonderful kitchen and dining area on the lower ground floor that opens onto a conservatory extension and garden.

There is a stunning master bedroom suite on the first floor with an additional suite on the top floor. The house is ready for immediate occupation in the very heart of this exciting developing district of London.

Location

Set in the heart of King's Cross, this magnificent house is moments from all of the facilities on King's Cross.

Nearby transport links include King's Cross St. Pancras Station (Metropolitan, Piccadilly, Victoria, Northern, Hammersmith and City and Circle lines and British Rail) which offers local, national and international transport links via the Eurostar at St. Pancras is approximately 0.5 miles from the property. All distances are approximate.

These particulars are intended only as a guide and must not be relied upon as statements of fact. Your attention is drawn to the Important Notice on the last page of the text.



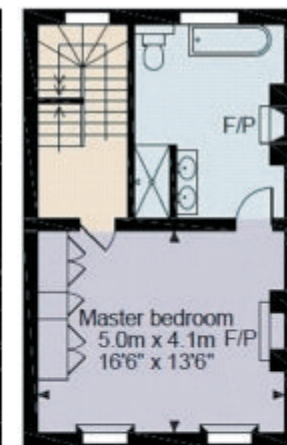
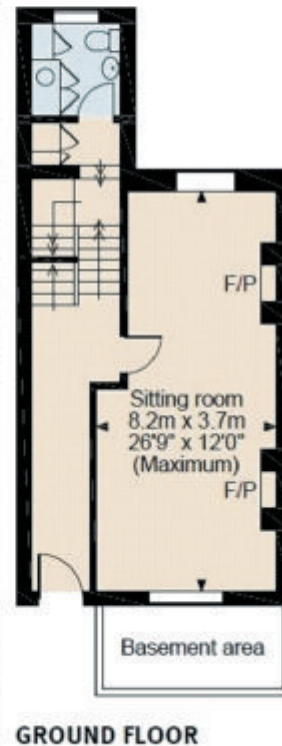
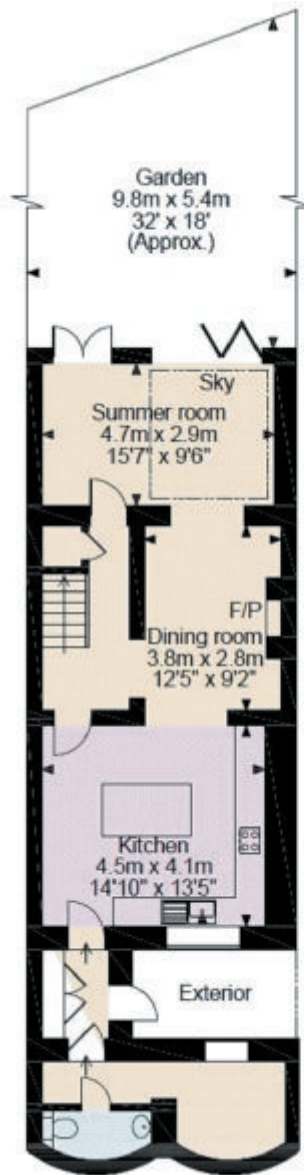

FIRST FLOOR

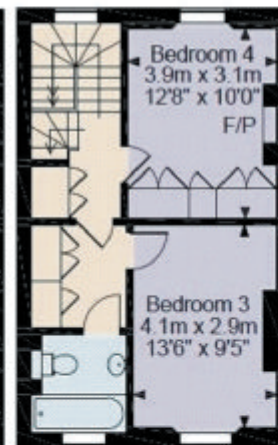

SECOND FLOOR



THIRD FLOOR



Approximate Gross Internal Floor Area 225 sq.m./2,423 sq.ft.

This plan is for guidance only and must not be relied upon as a statement of fact. Attention is drawn to the Important Notice on the last page of the text of the Particulars