

CAMERONS STIFF & Co.

Inc. QUEENS PARK PARTNERSHIP



Brondesbury Park, NW6

For Sale a SUBSTANTIAL detached property set over three floors and providing over 4200 sq ft of spacious accommodation.

The Ground Floor comprises a large entrance hallway, three good size reception rooms, a modern fitted kitchen/diner and plenty of storage room. The First Floor boasts six bedrooms and five bathrooms (all en-suite). The Second Floor has been extended to create a separate annex flat with its own reception room, double bedroom, a bathroom and kitchen area.

Brondesbury Park is ideally located within walking distance of the bars, restaurants and amenities of Salusbury Road and Willesden High Road. Local transport links includes Brondesbury Park (London Overground) and Willesden Green (Jubilee Line).

- Spacious detached property
- Spanning 4217 sq ft
- 8 bedrooms, 6 bathrooms
- Off street parking
- Garage with additional WC
- Spacious rooms throughout
- 74 ft garden
- Good location
- Close to local amenities and transport links
- Viewing is highly recommended

£3,600,000 Freehold

www.cameronsstiff.co.uk

CAMERONS STIFF & Co.

Inc. QUEENS PARK PARTNERSHIP



www.cameronsstiff.co.uk

You may download, store and use the material for your own personal use and research. You may not republish, retransmit, redistribute or otherwise make the material available to any party or make the same available on any website, online service or bulletin board of your own or of any other party or make the same available in hard copy or in any other media without the website owner's express prior written consent. The website owner's copyright must remain on all reproductions of material taken from this website.

Energy Efficiency Rating		Current	Potential
102-100	A		
91-101	B		
81-90	C		78
71-80	D	66	
61-70	E		
51-60	F		
41-50	G		
Not energy efficient - higher running costs			
England & Wales		EU Directive 2002/91/EC	

Brondesbury Park, London, NW6

APPROX. GROSS INTERNAL FLOOR AREA 4217 SQ FT 391.7 SQ METRES
(EXCLUDES RESTRICTED HEAD HEIGHT, STORES & INCLUDES GARAGE)

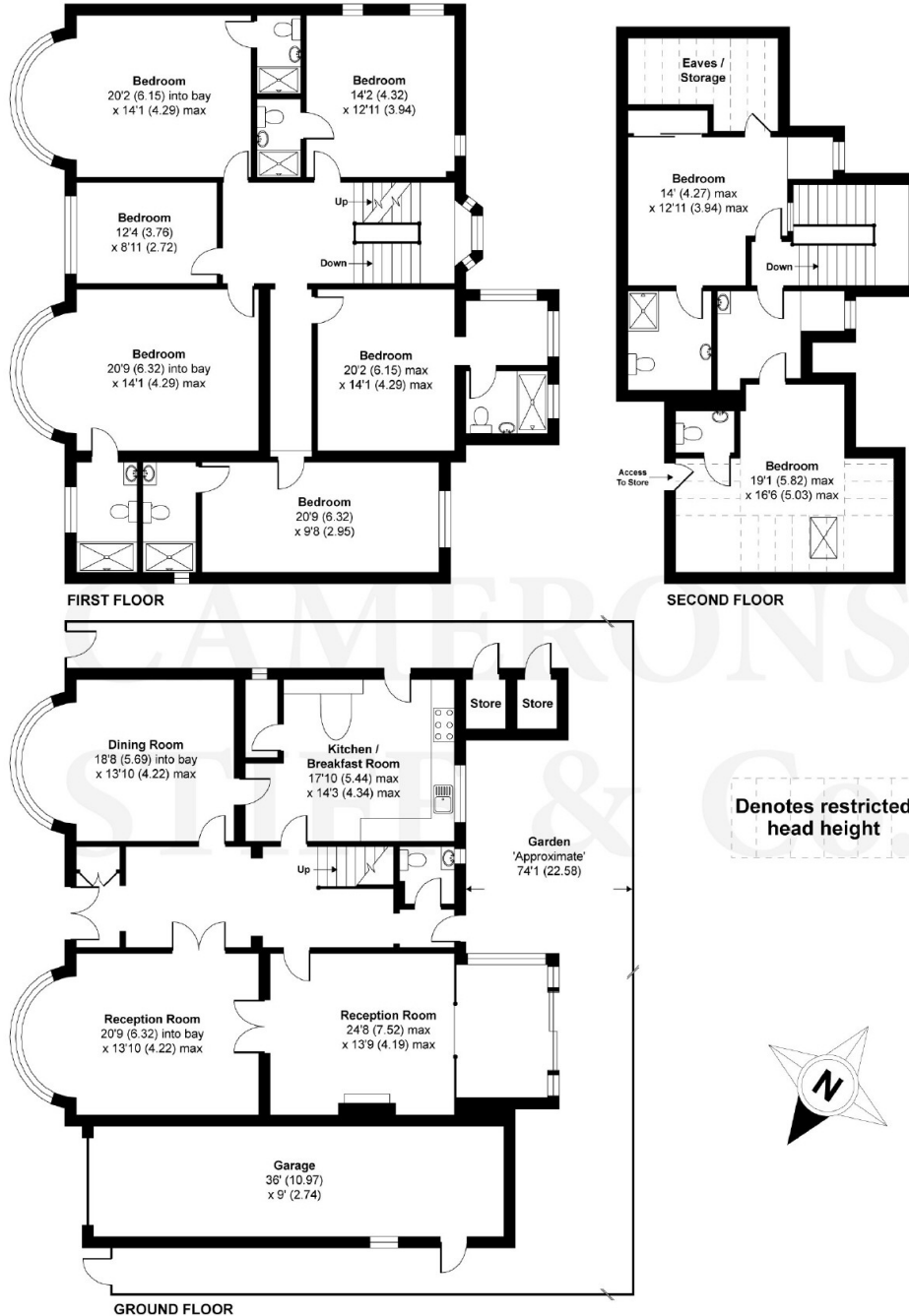

Whilst every attempt has been made to ensure the accuracy of the floor plan contained here, measurements of doors, windows and rooms are approximate and no responsibility is taken for any error, omission or misstatement. These plans are for representation purposes only as defined by RICS Code of Measuring Practice and should be used as such by any prospective purchaser. Specifically no guarantee is given on the total square footage of the property if quoted on this plan. Any figure given is for initial guidance only and should not be relied on as a basis of valuation.

Copyright nichecom.co.uk 2017 Produced for Camerons Stiff & Co REF : 201637

www.cameronsstiff.co.uk

275 Willesden Lane, London NW2 5JA T: 020 8459 1133 E: enquiries@cameronsstiff.co.uk

62 Salusbury Road, London, NW6 6NS T: 020 7328 2828