



**Montpelier - £750,000**

5 bed townhouse

83 Richmond Road, BS6 5EP



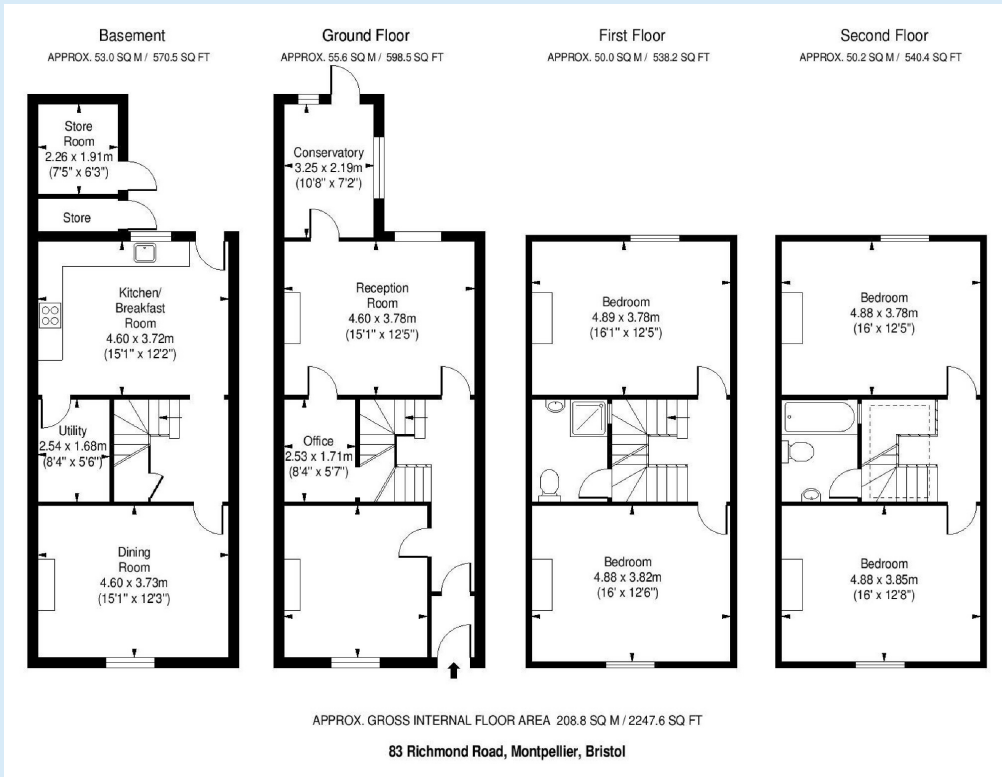

A beautifully presented Georgian town house found in an elevated position in the sought after Montpellier area. This position provides easy access to many local amenities, these include St Andrews Park, Gloucester Road, the city centre, major transport links and some very popular schools to name a few. Period houses of this type are rarely available. This property has so much to offer - of particular note is the generous rear garden that leads onto St Andrews Road. This area is currently a hard standing measuring 16ft in width and gives potential to develop this area into a garage/home office (subject to necessary consents being obtained). The interior has a wonderful feel with many retained period features, these include a stunning staircase that creates a beautiful centre piece of the home topped with a glass lantern providing light back down through the property. Other features include original sash windows, ceiling cornice, panelled wooden doors and period fireplaces.

Being arranged over four spacious levels, plus mezzanine levels, gives a flexible layout and from three levels are some fantastic views. In brief the top two floors contain four double bedrooms, a shower room and family bathroom. The hall floor has a former butler's pantry at mezzanine level used as a study area, two reception rooms, the second of which is the full width of the property and leads to a small conservatory and on through into the rear garden. The lower ground floor has a reception room to the front which is currently used as a dining room, a utility room and a family kitchen breakfast room to the rear that leads out to a lower patio area of the garden and provides access to two storage spaces which could provide opportunities to extend the kitchen, (subject to planning consents being obtained).



### Bishopston Branch

201 Gloucester Road, Bishopston, Bristol,  
BS7 8BG

Call: 0117 9425855

Mail: [bishopstonsales@oceanhome.co.uk](mailto:bishopstonsales@oceanhome.co.uk)

Search: [oceanhome.co.uk](http://oceanhome.co.uk)

References to the Tenure of a Property are based on information supplied by the Seller. The Agent has not had sight of the title documents. Lease details, service ground rent (where applicable) are given as a guide only and should be checked and confirmed by your solicitor prior to exchange of contracts.