



Manor Crescent, Epsom, KT19 7EF



£1,100,000

Freehold

Detached Family Home
Charles Church
Private Road
Five Bedrooms
Four Reception Rooms
Study
Kitchen/Breakfast Room
Utility Room
Two Ensuited and a Family Bathroom
Downstairs WC

A superb opportunity to acquire this beautiful Charles Church five bedroom detached family house having undergone several improvements by the current owner and positioned on one, if not the largest plot, in a private road on Manor Park.

Tucked away and accessed by a gravel driveway, the property is nicely secluded with views over the Green to the front.

Located on the periphery of Epsom Common and Horton Country Park the property is surrounded by pleasant walks on the many bridle paths and has easy access to David Lloyd leisure centre, as well as being a short distance from the town centre, railway station and Stamford Green primary school, making this home ideal for a large or growing family.



Having undergone several improvements by the current owners, this property really needs to be viewed internally to be fully appreciated. Downstairs the property offers four reception rooms, study, conservatory, refitted kitchen/breakfast room, utility room and a downstairs cloakroom. Upstairs there are five bedrooms, two ensuite shower rooms and a family bathroom.

Outside the property is surrounded by mature gardens fronting onto the green, with a double garage accessed by a gravel driveway.

With no ongoing chain we highly recommend early viewing. Sole agents.

Manor Park is a great location and highly regarded part of Epsom, ideal for commuters and safe for young families, surrounded by open space, cycle paths and lovely walks. Only a few minutes drive or walk into the town centre and the mainline rail station with frequent direct trains to Waterloo, Victoria and London Bridge. The M25 and A3 are within easy reach. Epsom offers good shops, amenities and restaurants including a Waitrose, Marks and Spencer and a large Sainsbury's superstore. The David Lloyd gym with outdoor pool and racket courts is a few minutes walk away. The famous Epsom Downs Racecourse with its sprawling countryside and surrounding pubs/restaurants are also close by.





Manor Cres

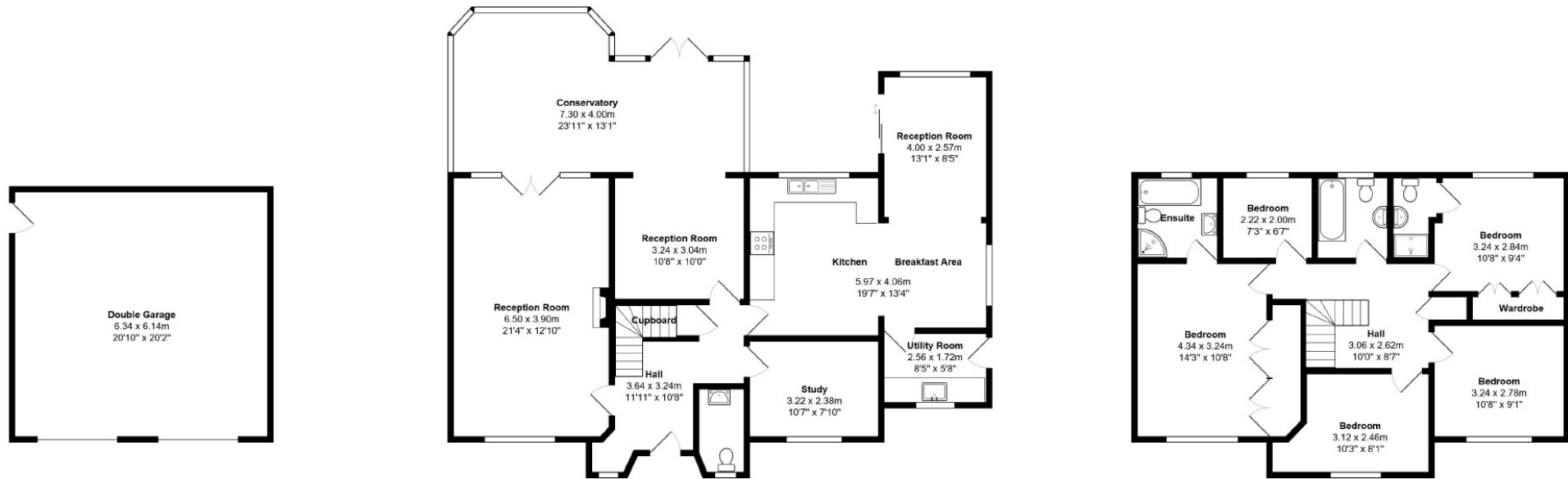

Total Area: 231.7 m² ... 2494 ft²
All measurements are approximate and for display purposes only

Please Note: Whilst every attempt has been made to ensure the accuracy of the floorplans contained here, measurements of doors, windows and room areas are approximate and no responsibility is taken for any error, omission or mis-statement. These plans are for representation purposes only and should be used as such by and prospective purchaser. The services, systems and appliances listed in the specification have not been tested by The Personal Agent and no guarantee as to their operating ability or their efficiency can be given. All images and text used to advertise our properties are for the sole use of The Personal Agent Ltd.

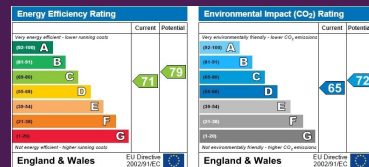

2 West Street, Epsom, Surrey, KT18 7RG, England
Tel: 01372 745850
Email: richard@thepersonalagent.co.uk
www.thepersonalagent.co.uk



