

In accordance with the Property Misdescriptions Act (1991) we have prepared these sales particulars as a general guide to give a broad description of the property. They are not intended to constitute part of an offer or contract. We have not carried out a structural survey and the services, appliances and specific fittings have not been tested. All photographs, measurements, floorplans and distances referred to are given as a guide and should not be relied upon for the purchase of carpets or any other fixtures or fittings. Lease details, service charges and ground rent (where applicable) are given as a guide only and should be checked and confirmed by your solicitor prior to exchange of contracts.

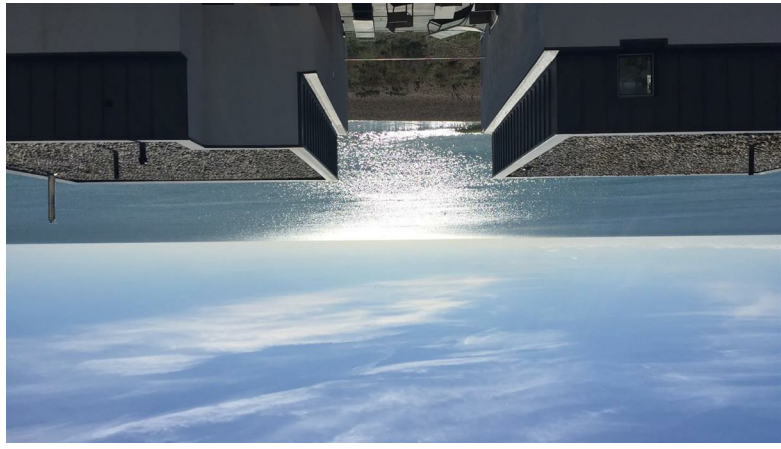

01303 238 927 m. 07702 892 465
 e. Martakierman@fishermansbeach.co.uk

EST. 1929
C.R. CHILD
 & PARTNERS
 Land and New Homes

miles & barr
 YOUR PROPERTY AGENT

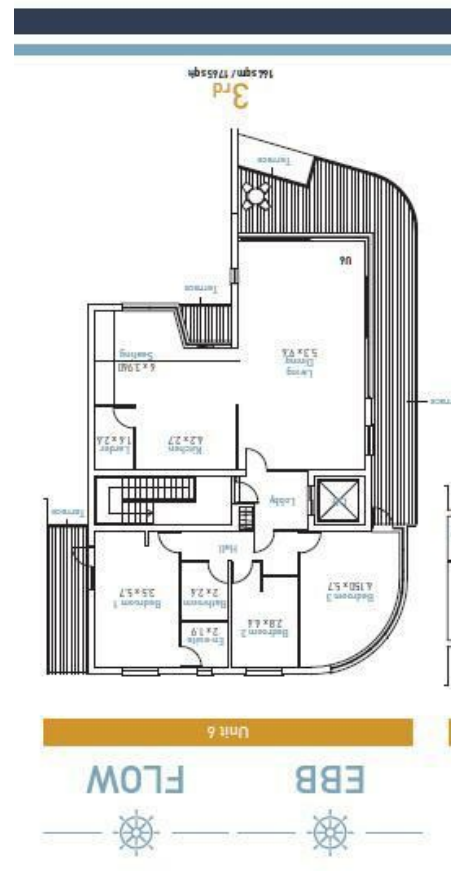

6 FLOW FISHERMANS BEACH
HYTHE



6 FLOW FISHERMANS BEACH
HYTHE

PRICE ON APPLICATION

- Penthouse with sea views
- New Build
- 10 year warranty
- Close to beach
- Terrace & balcony
- Off street parking
- Chain free
- High quality finish
- Built in appliances
- Close to town centre

ABOUT

Ebb & Flow are two individual apartment blocks, consisting of six spacious apartments in each with a variation of two and three bedrooms, the sea facing apartments have the bonus of a balcony too, however this beautiful penthouse has a terrace and a balcony.

Fisherman's Beach in Hythe is a major new development of luxury high specification homes located on the beach, many enjoying direct sea views. The development offers detached seafront villas, semi detached homes, townhouses and apartments. Built by a reputable developer all the properties provide modern contemporary living.

For more information, please call 01303 238 927.

LOCATION

Situated on a broad bay overlooking the English Channel with views to France, it is four miles from Channel Tunnel, four miles west of the Ferry and Cruise Port of Folkestone and approximately 10 miles south-west of Dover and in close proximity of Folkestone West and Ashford International Rail. Romney Marsh lies immediately west of the town, and can be explored either by car, bicycle, or using The World's Smallest Public Railway which runs parallel to the coastline through Dymchurch and new Romney to Dungeness.

The Sea-Front town is on level ground and a five-minute stroll along Stade Street brings you to the Royal Military Canal. This was dug during the Napoleonic era (1804-15) as a defensive measure against possibly French invasion. The Royal Military Canal's banks provide many delightful walks, as does the varied local countryside.

Hythe the town spreads up the hillside in a pleasing jumble of little streets containing many interesting historic buildings. At the foot of the hill is the old and narrow High Street with a variety of architectural styles, here is the main shopping area and its history dates back many centuries. Half way up the hill stands the dominating figure of the 11th Century parish Church with its famous Crypt and Ossuary, the vaults contain the bones of early settlers.

Hythe and the immediate neighbourhood contain many first-class facilities for recreation and leisure such as golf, tennis, riding, bowls, squash, boating, wind-surfing, bathing in the local pools or the sea and fresh-water and sea angling. Renowned Griggs of Hythe are purveyors of fine fish and game, they supply chefs with a great variety of freshly caught fish and are situated on Fisherman's Beach where the fishing boats arrive; their hand smoked salmon and haddock are legendary! Artistic enclaves, stunning shores, unique histories and expansive, wilderness escapes make Hythe an attractive place to live life on the water's edge.

DESCRIPTION

Lounge/Diner 17'4" x 31'5" (5.3 x 9.6)

Kitchen 13'9" x 8'10" (4.2 x 2.7)

Larder 5'2" x 8'6" (1.6 x 2.6)

Seating Area 19'8" x 12'11" (6 x 3.940)

Bedroom 1 11'5" x 18'8" (3.5 x 5.7)

En Suite 6'6" x 6'2" (2 x 1.9)

Bedroom 2 9'2" x 14'5" (2.8 x 4.4)

Bedroom 3 13'7" x 18'8" (4.150 x 5.7)

Bathroom 6'6" x 7'10" (2 x 2.4)

