



Hambalt Road, SW4

£1,685,000

An exquisitely presented Victorian terraced family house with a glorious South West facing rear garden, which has been expertly extended to create one of the finest homes in the area.

- Five Double Bedrooms
- Three Bath/Shower Rooms
- Double Reception Room
- Fully Extended Kitchen
- Underfloor Heating
- Premium Appliances
- South West Facing Garden
- Cellar



With premium appliances such as 'Wolf' and 'Meile', the fully fitted kitchen has extensive storage, under floor heating and bi-folding doors to the rear garden. There are five double bedrooms served by three luxury bath/shower rooms making this well balanced home appeal to the most discerning of buyers.

Situated in a sought after residential road in the heart of Abbeville Village and therefore adjacent to excellent local shops, restaurants and bars, plus Clapham Common and choice of underground stations at Clapham South and Clapham Common are also circa 0.5 of a mile away.







Denotes restricted head height

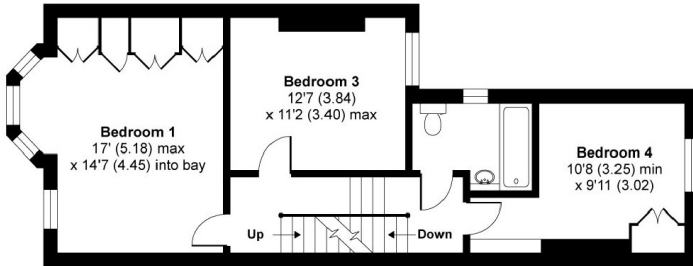

FIRST FLOOR

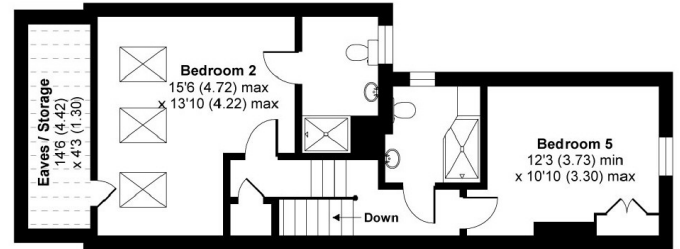

SECOND FLOOR

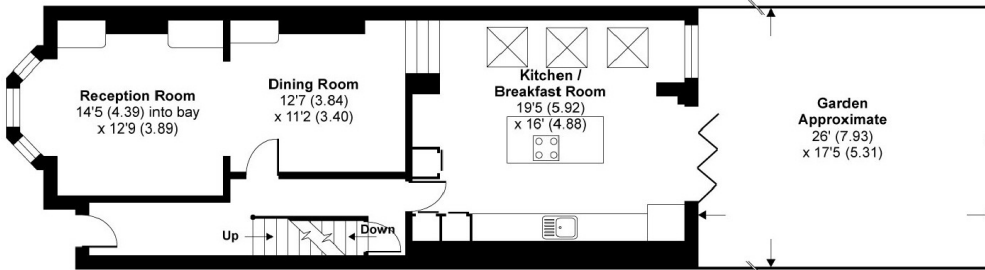

GROUND FLOOR

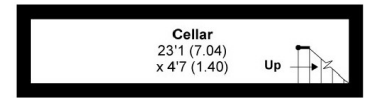

LOWER GROUND FLOOR

APPROX. GROSS INTERNAL FLOOR AREA 2063 SQ FT 191.7 SQ METRES (EXCLUDES RESTRICTED HEAD HEIGHT)

Hambalt Road, London, SW4

Copyright nichecom.co.uk 2018 Produced for Jacksons the Independent Estate Agents REF : 241103

Jacksons Clapham
73 Abbeville Road
London
SW4 9JN
020 8875 7995
clapham.sales@jacksonsestateagents.com

Energy Rating: E We aim to make our particulars both accurate and reliable. However they are not guaranteed; nor do they form part of an offer or contract. If you require clarification on any points then please contact us, especially if you're traveling some distance to view. Please note that appliances and heating systems have not been tested and therefore no warranties can be given as to their good working order.